

FIELD EVALUATION SHEET

PRELIMINARY EVALUATION DATE 4/30/16, FIELD EVALUATION DATE 4/30/16

PROPERTY OWNER: David Remer PHONE _____

ADDRESS: 69405 350th pl CITY, STATE, ZIP: Hill City, Minn 55748

LEGAL DESCRIPTION: _____

PIN# _____ SEC 2 T 52 R 26 TWP NAME _____

FIRE# 69405 LAKE/RIVER Hill LAKE LAKE CLASS _____ OHWL _____ FT.

DESCRIPTION OF SOIL TREATMENT AREAS

	AREA #1	AREA #2	REFERENCE BM ELEV. _____ FT.
DISTURBED AREAS	YES <u>X</u> NO _____	YES _____ NO _____	REFERENCE BM DESCRIPTION _____
COMPACTED AREAS	YES _____ NO _____	YES _____ NO _____	_____
FLOODING	YES <u>X</u> NO _____	YES _____ NO _____	_____
RUN ON POTENTIAL	YES <u>X</u> NO _____	YES _____ NO _____	_____
SLOPE %	<u>25+</u>	_____	_____
DIRECTION OF SLOPE	<u>E To W</u>	_____	_____
LANDSCAPE POSITION	<u>Hill side To Swamp</u>		
VEGETATION TYPES	_____		

DEPTH TO STANDING WATER OR MOTTLED SOIL: BORING# 1 _____, 1A _____, 2 _____, 2A _____

BOTTOM ELEVATION--FIRST TRENCH OR BOTTOM OF ROCK BED: #1 _____ FT., #2 _____ FT.

SOIL SIZING FACTOR: SITE # 1 _____, SITE #2 _____

CONSTRUCTION RELATED ISSUES: No useable site/holding Tank

LIC# 1174 SITE EVALUATOR SIGNATURE: _____

SITE EVALUATOR NAME: DAVID LANGE TELEPHONE# 218-697-2446

LUG REVIEW PA 5/9/16 DATE Dave 218-380-6939

Comments: HT due to bur tops and low soils

SOIL BORING LOGS ON REVERSE SIDE

Driller
Woods

350th place

Dave Renner

69405

350th place

Hill City, Minn

557748

slope
↓
25%+

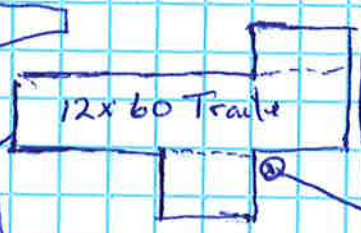

12x60 Tank

well/shallow

← 60' ft
from well

Wet
↓
+ lands
300
To Hill Lake

remove + install
new Tank
1820 gal

40' To inch

← North

Hill Lake