

University of Minnesota Site Evaluation Form 5/16/2005



Property Owner(s) Bret & Toni Anderson

Phone Number 763-742-7195

Address 19356 486th. St., McGregor, Mn. 55760

Two 1300 Gallon Holding tank design.

P.I.D. 29-1-159500

Section _____

Township _____

49 N

Range _____

23

Date 4/13/2016

Time 11:00 AM

Weather conditions sunny and clear

Location Information

(check all that apply)

shoreland

dwelling

replacement system

protection area

other establishment

new home construction

Homeowner Information

No. of bedrooms (if applicable) 3 bedrooms (includes possible additions)

No. of residents in home 2 adults children

Estimated flow 450 gpd

Well casing depth to be drilled deep feet

Discharge location if checked

Water using devices (check)

Garbage disposal

Water softener

Dishwasher

Sump pump

Large bathtub

High eff. furnace

Laundry/large tub on 2nd floor

Jucuzzi/hottub

Water use concerns (check)

Toilet/faucet leaks Max load laundry/day

Long term prescription medications

Home business Lint screen Antibact. soap

Frequent parties or out of town guests

Soil Data

Soil texture classification: sandy clay loam

Unnatural soil (check) Yes No

Type of observation (check) Probe Pit Boring

Parent material (check) Till Outwash Loess Bedrock Alluvium

Vegetation type (check) Wet Dry Unknown

Slope form (check) Summit Shoulder Back Foot Toe

Drainage (check) Good Fair Poor Ponding Flooding

Located in floodplain (check) Yes No

Soil Survey Data	Soil #1	Soil #2
Map unit sym & name		
Landscape position		
Flooding		
Slope		
Watertable depth		
Bedrock depth		
Possible system depth		
Texture at depth		
Permeability (P)		
Perc(MPI) = 60 / P		
NRCS onsite suitability		

Site Summary Data

Standing water: n/a inches

Bedrock: n/a inches

Saturated soil: 18" inches

Maximum depth of system: hold tnk. inches

Max elevation at system bottom: _____ feet

Soil sizing factor (SSF): _____ gpd/ft²

Linear loading rate (LLR): _____ gpd/ft

Was a perc test done? Yes _____ mpi

No

Soil Boring Data

Boring 1		Elevation:	Location:		
Soil Horizons Depth (inches)	Texture	Color	Structure	Consistence	
0-4"	top soil	10 yr 3/3			
4-18"	sandy loam	10 yr 4/6			
	mottles @ 18"				
Boring 2		Elevation:	Location:		
Soil Horizons Depth (inches)	Texture	Color	Structure	Consistence	

HOLDING TANK PUMPING SERVICE AGREEMENT

Permit # _____

THIS AGREEMENT, entered into by and between Aitkin County Registered Septic Tank Pumper, Kangas Enterprise, Inc./Kangas Sewer Service, hereinafter referred to as "Contractor", and Bret & Toni Anderson, hereinafter referred to as "Homeowner".

WHEREAS, the Homeowner desires and is required to retain individual sewage treatment system holding tank services to protect the environment and to obtain a certificate from the Aitkin County; and

WHEREAS, the Contractor desires to provide sewage treatment system pumping services to Homeowner as necessary and in accordance with the terms and conditions outlined herein.

NOW THEREFORE, in consideration of the mutual promises contained herein, Parties do hereby agree as follows:

1. **TERM.** The term of this Agreement shall be from 04/16/2016 to final installation of an Aitkin County approved sewage treatment system or connection to a Municipal Sewage Treatment System, unless earlier terminated as provided herein. The parties understand and agree that this Agreement is intended to arrange for the provision of pumping services so that Homeowner may occupy the home pursuant to a certificate of compliance to be issued by the Aitkin County Environmental Services Department upon execution of this Agreement. Homeowner further agrees that at the earliest possible date, Homeowner shall have a permanent sewage treatment system installed in accordance with the Aitkin County Individual Sewage Treatment System and Wastewater Ordinance No.1 and as approved by the Aitkin County Environmental Services Department or connect to a Municipal Sewage Treatment System. Upon approval by the County of Aitkin of the individual sewage treatment system to a municipal sewer, or approval by Aitkin County Environmental Services of an amended or different contract, this Agreement shall terminate.

2. **FREQUENCY OF PUMPING.** Homeowner agrees that he/she shall not allow the holding tank to overflow or discharge in any manner. Contractor and Homeowner agree that the holding tank shall be pumped in accordance with the following:

Tank size 3,000 (gal.) 1 holding tank(s) = total 75 gals, 1 / (number of household occupants multiplied by 75 gallons per day) = frequency of pumping; or

Within 24 hours of indication by tank alarm of lack of capacity (applicable only if system has a functional alarm): Whichever is greater.

Contractor agrees to provide pumping services according to the regular pumping schedule or as needed to prevent discharge. Homeowner shall compensate Contractor as agreed by the parties for pumping services rendered.

3. **REPORTING.** Grievances of Homeowner or Contractor shall be reported to the Aitkin County Environmental Services Department by Homeowner or Contractor. Homeowner and Contractor understand that failure to have holding tank pumped as herein specified or the discharge of any contents from the holding tank, regardless of fault, may result in the suspension, cancellation or revocation of the certificate of compliance, and the homeowner may be required to vacate the premises.

[Signature]
Contractor

[Signature]
Homeowner

Date 4-15-16

Date 4-15-16

Kangas Sewer Service
Septic Pumping
(218) 768-2575

Site Evaluation Map

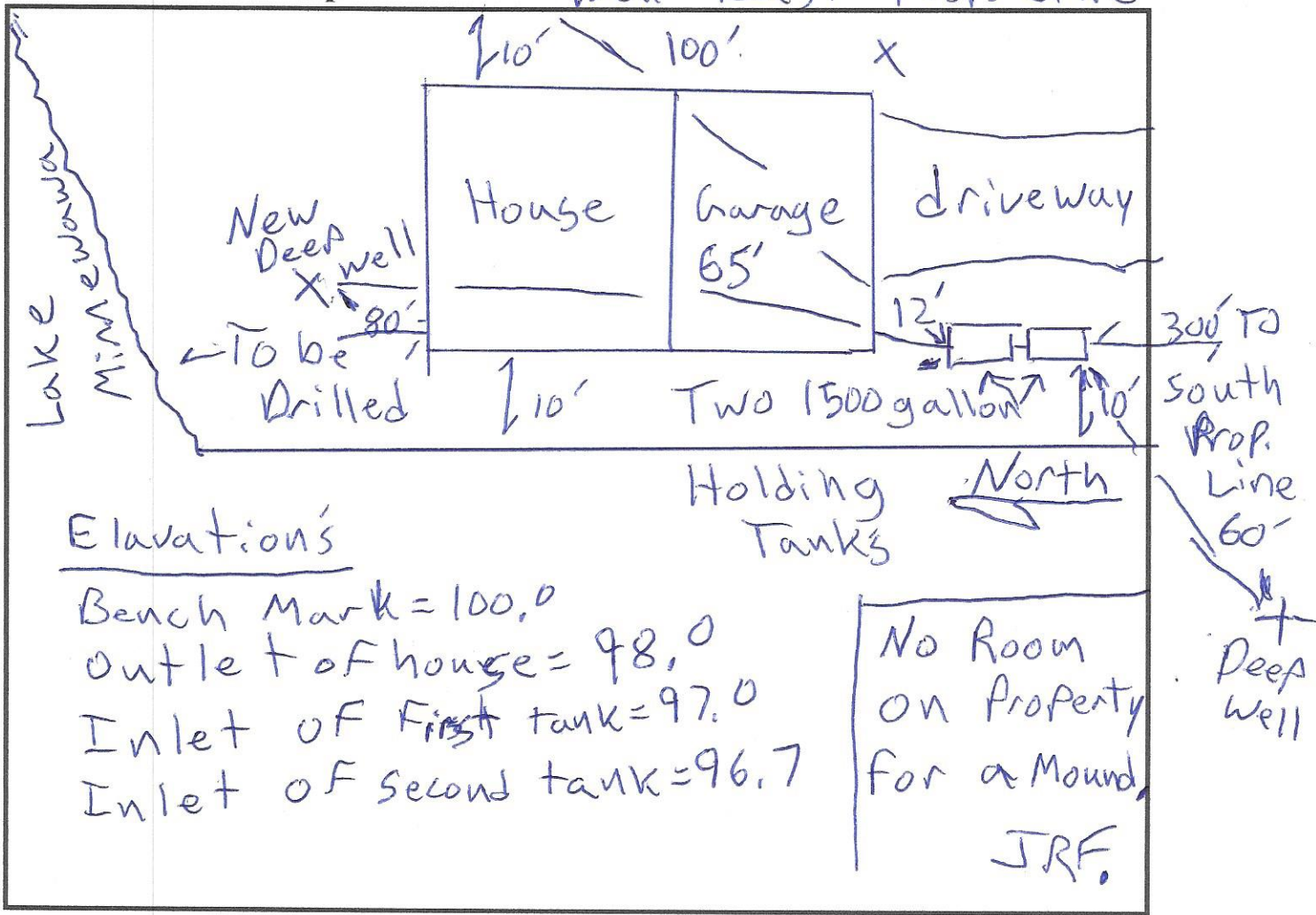

Elevations

Bench Mark = 100.0
 Outlet of house = 98.0
 Inlet of first tank = 97.0
 Inlet of second tank = 96.7

No Room ON Property for a Mound
 JRF.

List any construction issues: _____

Mapping Checklist

Map scale: _____ indicate north _____ show slope _____ % direction _____

Locate

- | | | |
|---|---|---|
| <input type="checkbox"/> lot dimensions/property lines | Easements | Setbacks |
| <input type="checkbox"/> dwellings and other improvements | <input type="checkbox"/> phone | <input type="checkbox"/> building |
| <input type="checkbox"/> existing and/or proposed system(s) | <input type="checkbox"/> electric | <input type="checkbox"/> all water wells within 100ft |
| <input type="checkbox"/> replacement area | <input type="checkbox"/> gas | <input type="checkbox"/> pressure pipe |
| <input type="checkbox"/> unsuitable area(s) | | <input type="checkbox"/> water suction pipe |
| <input type="checkbox"/> public water supply wells | Elevations | <input type="checkbox"/> streams, lakes, rivers |
| <input type="checkbox"/> pumping access | <input type="checkbox"/> borings | <input type="checkbox"/> floodway and fringe |
| <input type="checkbox"/> inner wellhead zone | <input type="checkbox"/> benchmark | |
| | <input type="checkbox"/> perc tests | |
| | <input type="checkbox"/> horiz&vert reference pts | |

I hereby certify this work has been completed in accordance with all applicable ordinances, rules and laws.

[Signature] (signature)

4/13/2016 (date)

L-1919 (license #) 218-839-4737 (phone number)