

# CERTIFICATE OF SURVEY

PART OF THE SOUTHWEST QUARTER,  
SECTION 1, TOWNSHIP 46, RANGE 26,  
AITKIN COUNTY, MINNESOTA

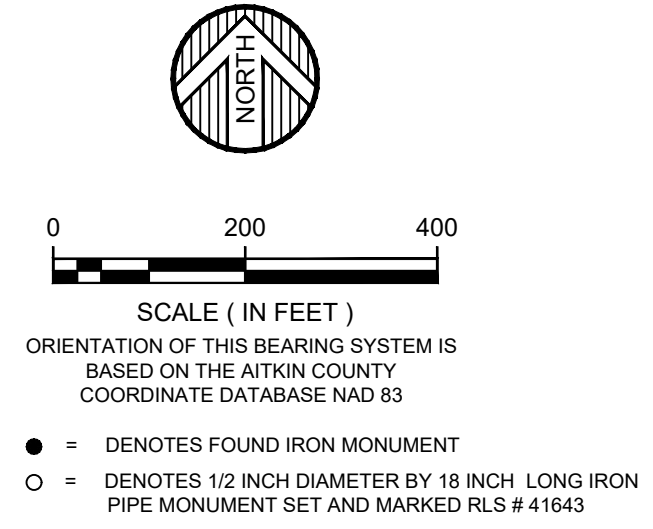

**EXISTING LEGAL DESCRIPTION ACCORDING TO DOC. NO. 397244:**

The SE1/4 SW1/4 and the W1/2 SW1/4 of Section 1, Township 46, Range 26, Aitkin County, Minnesota, EXCEPT THE FOLLOWING DESCRIBED PARCELS:

EXCEPT that part of the S1/2 SW1/4 of Section 1, Township 46, Range 26, Aitkin County, Minnesota, described as follows: Commencing at the Southwest corner of said Section 1; thence on an assumed bearing of North 84° 58' 09" East, along the south line of said Section 1, a distance of 791.81 feet to the point of beginning of the parcel herein described; thence continuing on a bearing of North 84° 58' 09" East along last said line 409.09 feet; thence North 03° 55' 08" East, 1131.51 feet; thence North 89° 54' 14" West, 324.47 feet; thence South 12° 50' 47" West, 517.80 feet; thence South 03° 55' 08" West, 661.99 feet to the point of beginning.

EXCEPT that part of the NW1/4 SW1/4 of Section 1, Township 46, Range 26, Aitkin County, Minnesota, described as follows: Commencing at the West Quarter corner of said Section 1 thence South, assumed bearing, 635.00 feet along the west line of said Section 1 to the point of beginning, thence continuing South 370.00 feet along West line of said Section 1, thence North 90° 00' East 328.00 feet thence North 370.00 feet, thence South 90° 00' West 328.00 feet to the point of beginning.

EXCEPT that part of the NW 1/4 SW1/4 of Section 1, Township 46, Range 26, described as follows: Beginning at the West Quarter corner of said Section 1; thence South, assumed bearing, 450.00 feet along the West line of said Section 1; thence North 90° 00' East 172.40 feet, thence North 60° 17' East, 610.87 feet; thence North 41° 32' East 93 feet, more or less, to the shore of Haveri Lake; thence Northerly along said shore to the North line of said NW1/4 of SW1/4; thence Westerly along the North line of said NW1/4 of SW1/4 to the point of beginning.

EXCEPT That part of the SE1/4 SW1/4 of Section 1, Township 46, Range 26, described as follows: Beginning at the northeast corner of said SE1/4 SW1/4; Thence South 85° 50' 42" West, on an assigned bearing, along the northerly line of said SE1/4 of SW1/4 a distance of 330.87 feet; thence South, parallel with the East line of said SE1/4 of SW1/4, a distance of 330.87 feet; thence North 85° 50' 42" East, parallel with the North line of said SE1/4 of SW1/4, a distance of 330.87 feet; thence North along said east line of the SE1/4 of SW1/4, a distance of 330.87 feet to the point of beginning, its being the intent of this description to describe the North 330 feet of the East 330 feet of said SE1/4 of the SW1/4 thereof.

EXCEPT the West 330.00 feet of the East 700.00 feet of the South 330.00 feet of the SE1/4 of the SW1/4 of Section 1, Township 46, Range 26, Aitkin County, Minnesota.

**PROPOSED LEGAL DESCRIPTION FOR TRACT A:**

That part of the Southwest Quarter of the Southwest Quarter (SW1/4-SW1/4) of Section 1, Township 46, Range 26, Aitkin County, Minnesota, described as follows: Commencing at the Southwest corner of said Section 1; thence North 84 degrees 41 minutes 16 seconds East, bearing based on the Aitkin County Coordinate Database NAD 83, 1200.90 feet along the south line of said Section 1; thence North 03 degrees 38 minutes 15 seconds East 1131.51 feet; thence South 89 degrees 48 minutes 53 seconds West 324.47 feet to the point of beginning of the tract to be described; thence South 12 degrees 33 minutes 54 seconds West 517.80 feet; thence South 03 degrees 36 minutes 15 seconds West 661.99 feet to said south line of Section 1; thence South 84 degrees 41 minutes 16 seconds West 791.81 feet along said south line of Section 1, to said Southwest corner of Section 1; thence North 00 degrees 04 minutes 32 seconds West 1236.31 feet along the west line of said Section 1 to its intersection with the line that bears South 89 degrees 48 minutes 53 seconds West from the point of beginning; thence North 89 degrees 48 minutes 53 seconds East 944.69 feet to the point of beginning.

Subject Easements, Reservations or Restrictions of record, if any.

Subject to the right of way of 330<sup>th</sup> lane.

Subject to the right of way of 350<sup>th</sup> ave.

**SURVEYORS NOTES:**

THE PID FOR THE SUBJECT PROPERTY IS 24-0-001109.

A WETLAND DELINEATION WAS NEITHER REQUESTED OR PROVIDED FOR THIS SURVEY.

TRACT A IS NOT INTENDED TO BE A STAND ALONE TRACT IT IS INTENDED TO BE COMBINED WITH THE BARKER EXCEPTION, PID 24-0-00110.

THIS SURVEY WAS COMPLETED WITHOUT THE BENEFIT OF A TITLE COMMITMENT OR OPINION. THERE MAY BE EASEMENTS OR OTHER LIMITING FACTORS NOT SHOWN ON THIS SURVEY WHICH AFFECT THE SUBJECT PROPERTY.

DATE:	10-23-2024	DATE:	10-23-24	AMENDMENTS:	AMENDED ACCORDING TO AITKIN COUNTY COMMENTS	BY:	CMC	PREPARED FOR:	CHAD ETZLER
SCALE:	AS SHOWN							I HEREBY CERTIFY THAT THIS SURVEY, PLAN, OR REPORT WAS PREPARED BY ME OR UNDER MY DIRECT SUPERVISION AND THAT I AM A DULY LICENSED LAND SURVEYOR UNDER THE LAWS OF THE STATE OF MINNESOTA.	
DRAWN BY:	ABS								
CHECKED BY:	CMC							CHAD M. CONNER DATE: 10-14-2024 LIC. NO. 41643	
FILE NUMBER:	2024-11610								

