

Wills 9/17/227
application
for

the ridge
removal

AITKIN COUNTY BUILDING PERMIT SITE PLAN

Please indicate the location of: Wells, well setback to system components, buildings, septic system components, reserved septic system area, property lines, waterways, and buried lines. Include size, length, and appropriate distances from fixed reference points. Provide a North directional arrow!

24th Street

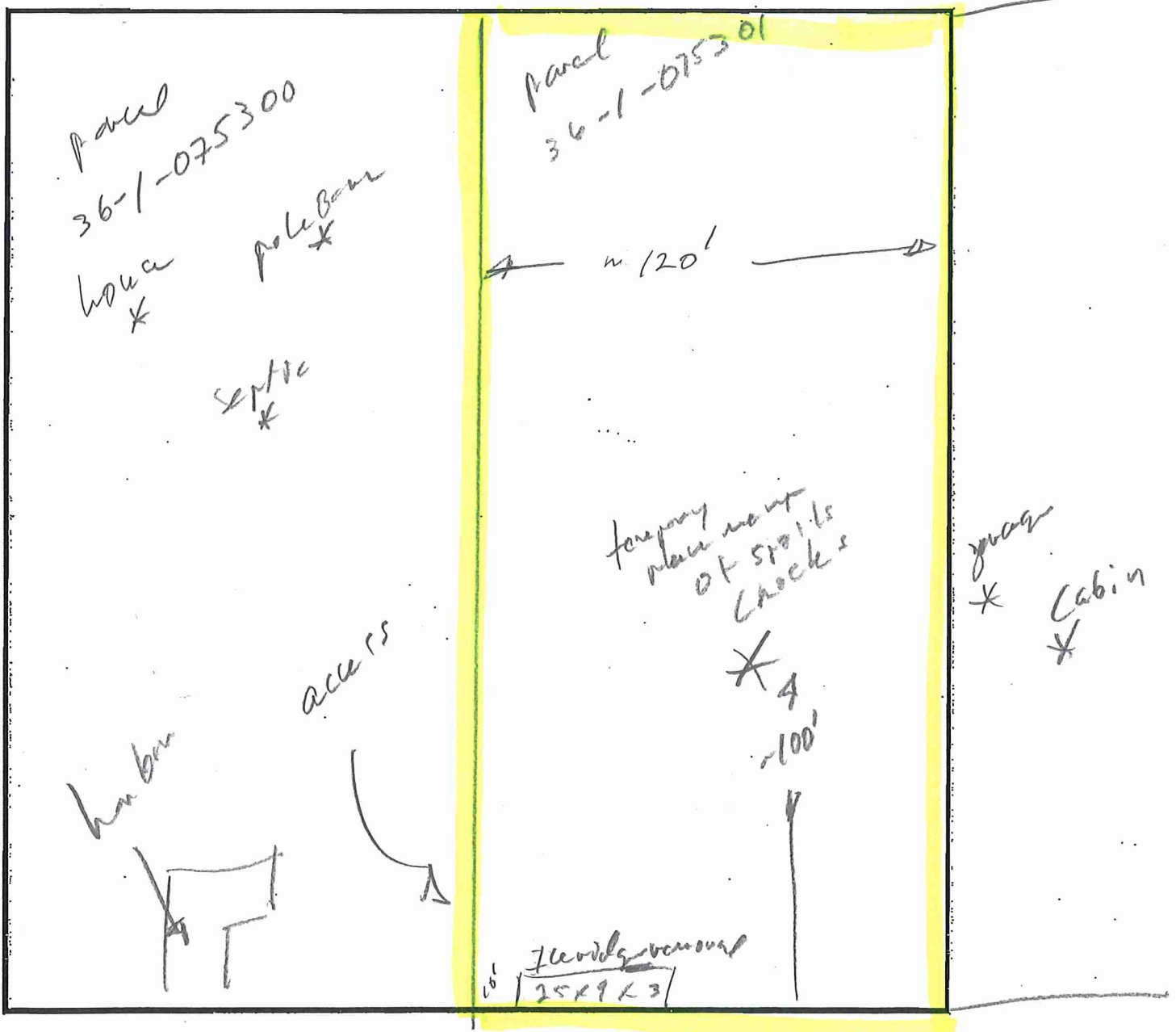

mike laas