

**NOTES:**

1. BASE PLAN USED IS A SURVEY PREPARED BY ARRO LAND SURVEYING OF BRAINERD.
2. ALL EXISTING UTILITY LOCATIONS AND ELEVATIONS SHOWN ARE APPROXIMATE ONLY. CONTRACTOR SHALL CONFIRM ALL LOCATIONS AND ELEVATIONS PRIOR TO CONSTRUCTION. CONTRACTOR SHALL CONTACT UTILITY COMPANIES VIA GOPHER STATE ONE-CALL.
3. ALL CONSTRUCTION SHALL CONFORM TO THE MOST RESTRICTIVE OF THE PROJECT SPECIFICATIONS, THE STANDARD SPECIFICATIONS OF AITKIN COUNTY AND THE LATEST EDITION OF MNDOT STANDARD SPECIFICATIONS FOR CONSTRUCTION.
4. TOTAL PROJECT AREA = 426,117 SF (9.78 AC)  
 EXISTING IMPERVIOUS SURFACE AREA = 23,950 SF (5.6%)  
 PROPOSED IMPERVIOUS SURFACE AREA = 96,018 SF (22.5%)
5. GRAVEL SECTION SHALL BE 8" CLASS 5 OVER COMPACTED SUBGRADE.

**PRELIMINARY  
NOT FOR CONSTRUCTION**

**STARK ENGINEERING**

www.starkengineer.com  
320-249-2611  
Sauk Rapids, Minnesota

I hereby certify that this plan, specification or report was prepared by me or under my direct supervision and that I am a duly Licensed Professional Engineer under the laws of the State of Minnesota.

REVISIONS	PER REVIEW	COUNTY SUB.
8/23/24		
8/30/24		

Wayne C.B. Stark      8/30/24      26093      Date      Registration No.

**SITE PLAN**

STORAGE FACILITY  
HAZELTON TOWNSHIP, MINNESOTA  
for:  
PATTEN MILLE LACS, LLC

SHEET  
**C-1**  
OF 2 SHEETS

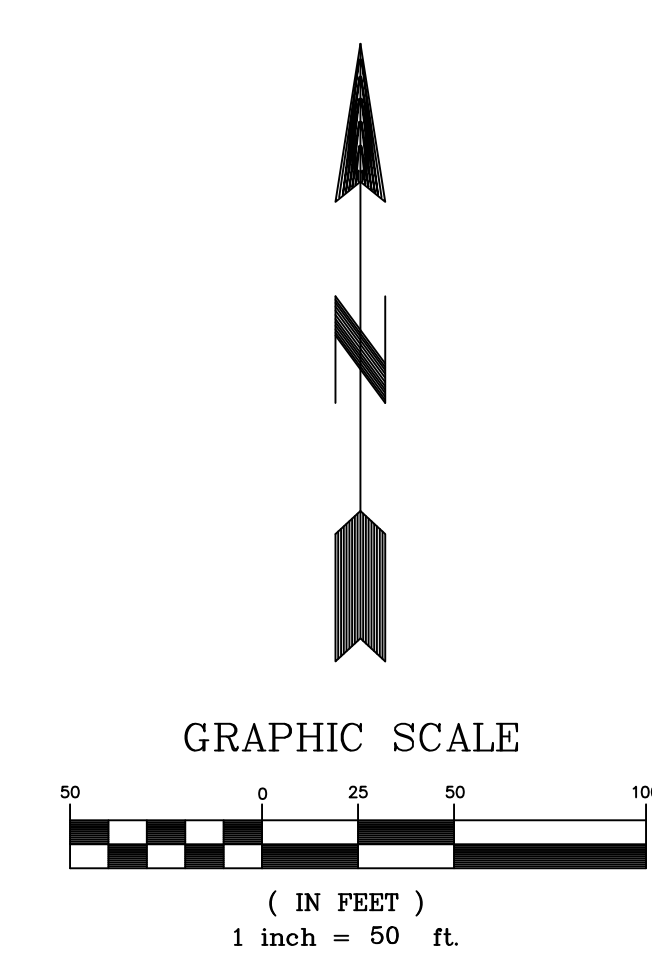
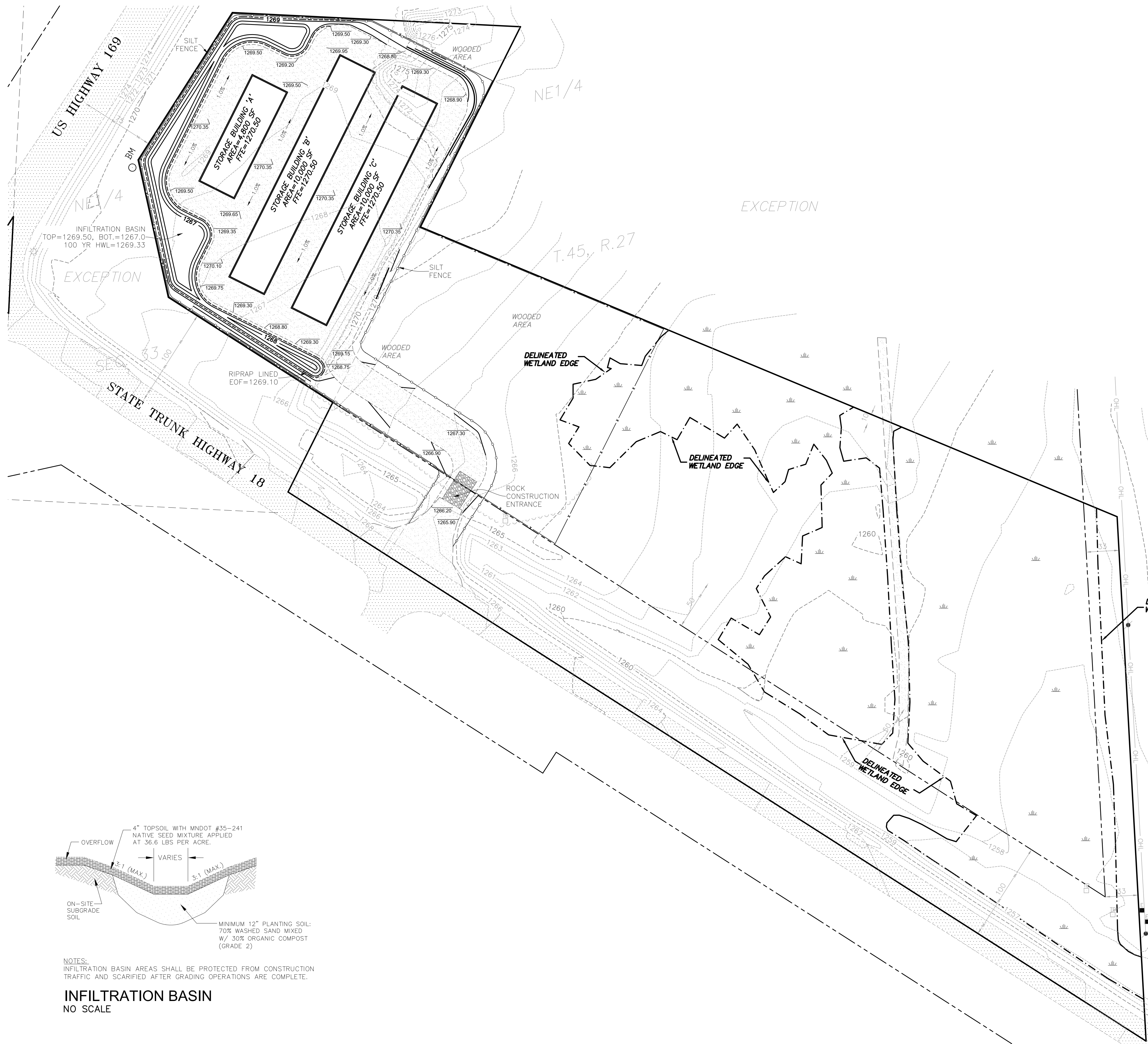

**NOTES:**

1. BASE PLAN USED IS A SURVEY PREPARED BY ARRO LAND SURVEYING OF BRAINERD.
2. ALL EXISTING UTILITY LOCATIONS AND ELEVATIONS SHOWN ARE APPROXIMATE ONLY. CONTRACTOR SHALL CONFIRM ALL LOCATIONS AND ELEVATIONS PRIOR TO CONSTRUCTION. CONTRACTOR SHALL CONTACT UTILITY COMPANIES VIA GOPHER STATE ONE-CALL.
3. ALL CONSTRUCTION SHALL CONFORM TO THE MOST RESTRICTIVE OF THE PROJECT SPECIFICATIONS, THE STANDARD SPECIFICATIONS OF AITKIN COUNTY AND THE LATEST EDITION OF MNDOT STANDARD SPECIFICATIONS FOR CONSTRUCTION.
4. THE FOLLOWING SEQUENCE AND PROTOCOLS SHALL BE FOLLOWED FOR EROSION AND SEDIMENT CONTROL DURING THE SITE DEVELOPMENT PROCESS:
  - A. INSTALL PERIMETER CONTROLS (SILT FENCE & ROCK ENTRANCE) AS SHOWN ON THE PLANS PRIOR TO START OF WORK.
  - B. NO CONCRETE WASHOUTS ARE ALLOWED ON THE PROJECT SITE. SOIL STOCKPILES SHALL HAVE PERIMETER CONTROL AND HAVE TEMPORARY SEED AND MULCH.
  - C. MAINTAIN ALL TEMPORARY EROSION CONTROL DEVICES IN PLACE UNTIL THE CONTRIBUTING DRAINAGE AREA HAS BEEN STABILIZED. INSPECT TEMPORARY EROSION CONTROL DEVICES ON A WEEKLY BASIS AND AFTER EACH 1/2" OR MORE RAIN EVENT. CLEAN OR MAINTAIN THESE DEVICES AS NEEDED TO BE EFFECTIVE. REPLACE DETERIORATED, DAMAGED OR ROTTED EROSION CONTROL DEVICES IMMEDIATELY.
  - D. REMOVE ALL SOILS AND SEDIMENTS DEPOSITED ONTO PUBLIC AND/OR PRIVATE PAVEMENT AREAS WITHIN 24 HOURS OF DEPOSITION. REMOVAL OF TRACKING MATERIALS SHALL BE COMPLETED AT THE END OF EACH WORK DAY WHEN IT OCCURS. SWEEPING MAY BE ORDERED AT ANY TIME IF CONDITIONS WARRANT.
  - E. PERFORM SITE REMOVALS, GRADING, EXCAVATION AND EMBANKMENT. SEED AND MULCH ALL DISTURBED AREAS OUTSIDE OF PROPOSED BUILDING AND PAVEMENT AREAS WITHIN 72 HOURS OF THIS WORK.
  - F. CONSTRUCT BUILDINGS AND INSTALL GRAVEL SECTION. FINE GRADE SITE AND RESTORE GREEN AREAS WITH PERMANENT VEGETATION OF SOD/SEED PER PLANS.
  - G. REMOVE ALL TEMPORARY EROSION AND SEDIMENT CONTROL DEVICES AFTER SITE HAS UNDERGONE FINAL STABILIZATION AND PERMANENT VEGETATION HAS BEEN ESTABLISHED WITH AT LEAST 70% COVERAGE.

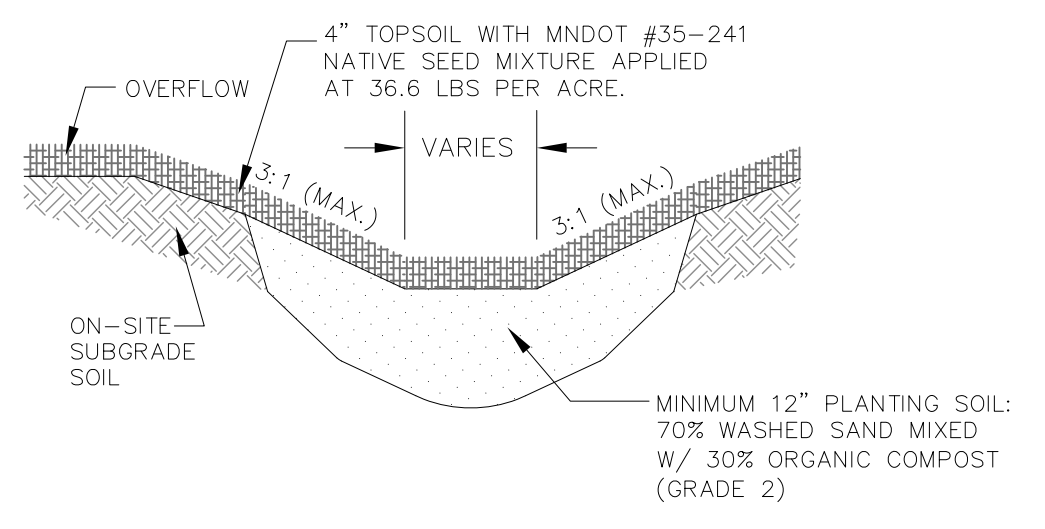

NOTES:  
INFILTRATION BASIN AREAS SHALL BE PROTECTED FROM CONSTRUCTION TRAFFIC AND SCARIFIED AFTER GRADING OPERATIONS ARE COMPLETE.

**INFILTRATION BASIN**  
NO SCALE

**STARK ENGINEERING**

www.starkengineer.com  
320-249-2611  
Sauk Rapids, Minnesota

---

I hereby certify that this plan, specification or report was prepared by me or under my supervision and that I am a duly Licensed Professional Engineer under the laws of the State of Minnesota

Wayne C.B. Stark      8/30/24    26093      Date    Registration No.

---

REVISIONS	COUNTY SUB.
8/30/24	

---

**GRADING & EROSION CONTROL PLAN**

---

STORAGE FACILITY  
HAZELTON TOWNSHIP, MINNESOTA  
for: PATTEN MILLE LACS, LLC

---

SHEET  
**C-2**  
OF 2 SHEETS

**PRELIMINARY**  
**NOT FOR CONSTRUCTION**