

31-0-066600 2023 Press Submit/Enter to continue or enter new parcel/tax year.

Parcel	Account	Asmt year	Tax year	Type
31-0-066600	31597	2022	2023	RE

Primary owner	Hold tax statement	Escrow	Notes
17862 PEYSAR, CLARK M & LOIS K			
Taxpayer	FALCO	Address	Lease typ
17862 PEYSAR, CLARK M & LOIS K	1 F.O.		
Ref. parcel	Commissi		Surveyed
00231000066600	3		
Lake #/Name	TIF distric		UDI
			100.00%
Physical address	TIF knock		Billing
34165 370th Ave AITKIN 56431			P

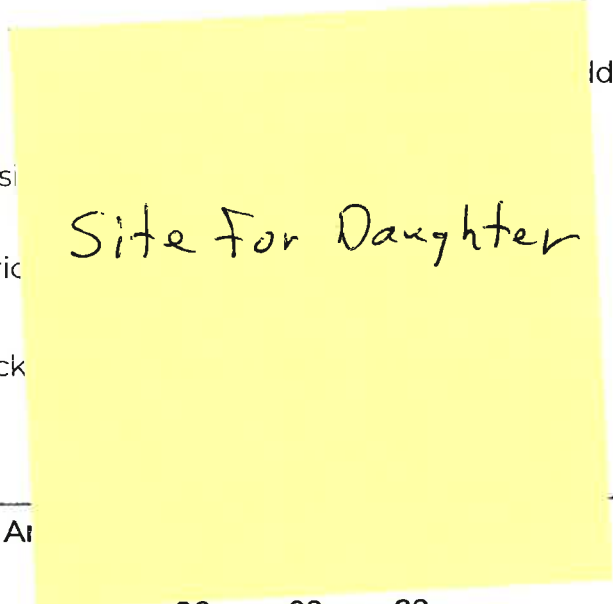

Unique Taxing A	Unit
00 00 00 00	
State UTA code	
32 1 00	

Description	Property Description	Acres	Lot	Block	Plat - Description
SE-SE	version 1	40.00			
					Sect/Twp/Range
					33 47.0 26

FIELD EVALUATION SHEET Tank Replacement

PRELIMINARY EVALUATION DATE Sept 5, 2023, FIELD EVALUATION DATE Sept 5, 2023
 PROPERTY OWNER: Clark Mat Lais K. Peysar PHONE 218-820-8680
 ADDRESS: 34165-370th Ave CITY, STATE, ZIP: Aitkin, Mn, 56431
 LEGAL DESCRIPTION: _____
 PIN# 31-0-066600 SEC. 33 T 47 R 26 TWP NAME Spencer
 FIRE# _____ LAKE/RIVER _____ LAKE CLASS _____ OHWL _____ FT.

DESCRIPTION OF SOIL TREATMENT AREAS

	AREA #1	AREA #2	REFERENCE BM ELEV. _____ FT.
DISTURBED AREAS	YES ___ NO ___	YES ___ NO <u>X</u>	REFERENCE BM DESCRIPTION _____
COMPACTED AREAS	YES ___ NO ___	YES ___ NO <u>X</u>	<u>Tank inlet will be</u>
FLOODING	YES ___ NO ___	YES ___ NO <u>X</u>	<u>the same</u>
RUN ON POTENTIAL	YES ___ NO ___	YES ___ NO <u>X</u>	_____
SLOPE %	<u>Existing</u>	<u>9</u>	_____
DIRECTION OF SLOPE	<u>Mound</u>	<u>E-W</u>	_____
LANDSCAPE POSITION	<u>EW</u>	<u>N-S</u>	_____
VEGETATION TYPES	<u>Grass</u>	<u>Wooded</u>	_____

DEPTH TO STANDING WATER OR MOTTLED SOIL: BORING# 1 28, 1A 25, 2 14, 2A 13

BOTTOM ELEVATION—FIRST TRENCH OR BOTTOM OF ROCK BED: #1 _____ FT., #2 _____ FT.

SOIL SIZING FACTOR: SITE #1 existing, SITE #2 2.67

CONSTRUCTION RELATED ISSUES: Mound is existing and has enough separation
Borings were done close to the end of the rock bed. Everything
mound related is good

LIC# 2132 SITE EVALUATOR SIGNATURE: Tom O'Neil

SITE EVALUATOR NAME: Tom O'Neil TELEPHONE# 218-927-6070

LUG REVIEW _____ DATE _____

Comments: _____

SOIL BORING LOGS ON REVERSE SIDE

3 bedroom mound was put in by Ritter for Gerald Becker before
Peysars owned the property in 1994, or whenever bought.
Everything is good in mound, but tank is cracked.
Tank will be replaced with a new 1800 gallon, two
compartment tank and will have a filter

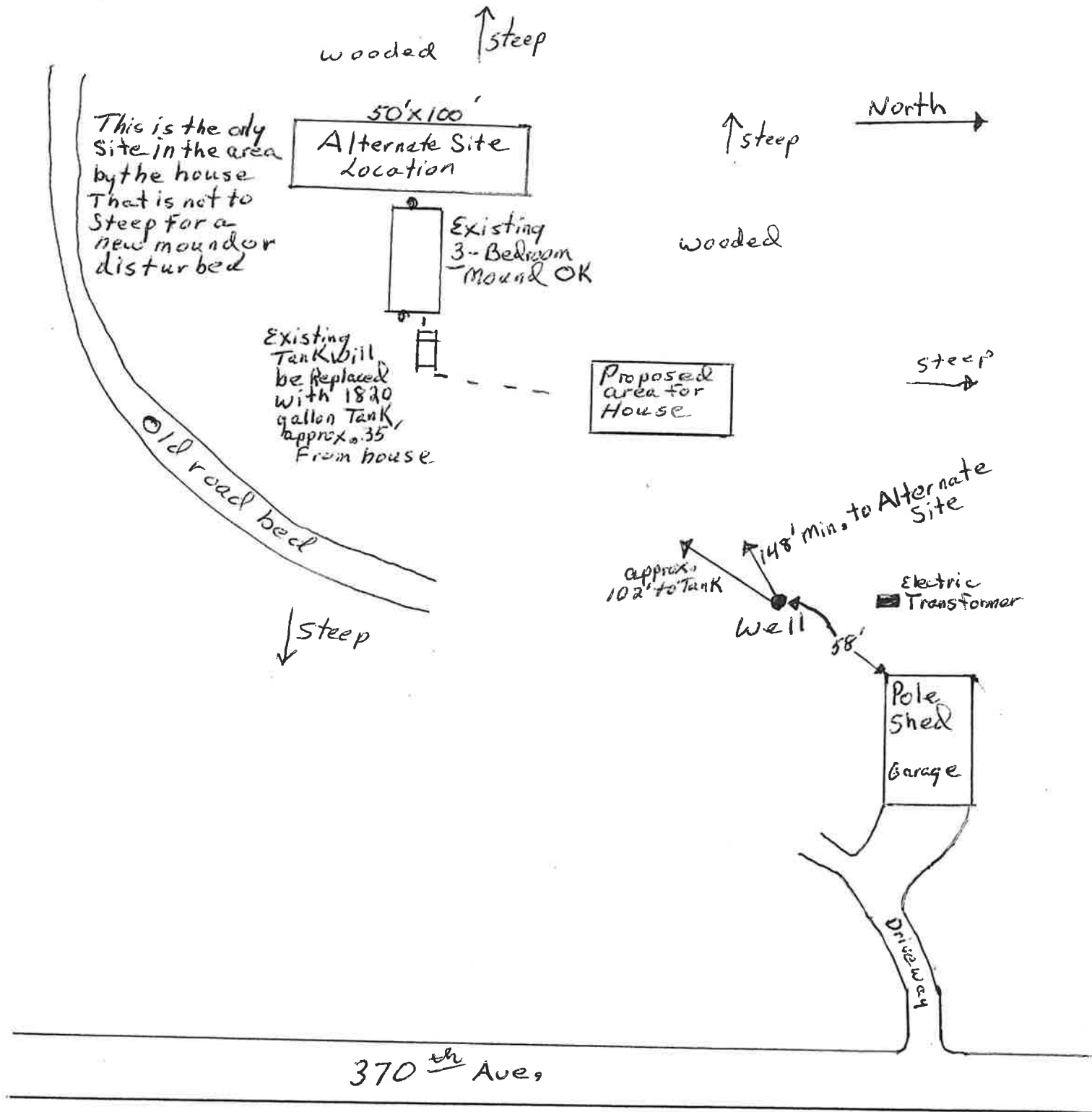

Existing Mound Soils

SOILS DATA

SOILS DATA

DEPTH (INCHES)	TEXTURE	MUNSELL COLOR
0-4	Loam	10Yr 3/2
4-10	Sandy clay loam	10Yr 4/3
10-28	Med Sand	10Yr 4/4
mottles at 28"		

DEPTH (INCHES)	TEXTURE	MUNSELL COLOR
0-5	Loam	10Yr 3/2
5-10	Loam	10Yr 4/4
10-30	Med Sand	10Yr 4/4
Mottling after 25"		

SOILS DATA

Alternate

SOILS DATA

DEPTH (INCHES)	TEXTURE	MUNSELL COLOR
0-6	loam	10Yr 3/2
6-14	loam	10Yr 4/3
14-18	Clay loam	7.5Yr 5/4
Mottles at 14"		

DEPTH (INCHES)	TEXTURE	MUNSELL COLOR
0-5	loam	10Yr 3/2
5-12	loam	10Yr 4/3
12-17	Clay loam	7.5Yr 5/3
Mottles at 13"		

Property Address: 34165-370th Ave. Aitkin, Mn. 56431
Business Name: Tom O'Neil Date: Sept 5, 2023

5. Soil separation – Compliance component #5 of 5

Date of installation 1994 Unknown
(mm/dd/yyyy)

Shoreland/Wellhead protection/Food beverage lodging? Yes No

Compliance criteria (select one):

5a. For systems built prior to April 1, 1996, and Yes No*
not located in Shoreland or Wellhead Protection Area or not serving a food, beverage or lodging establishment:

Drainfield has at least a two-foot vertical separation distance from periodically saturated soil or bedrock.

5b. Non-performance systems built April 1, 1996, or later or for non-performance systems located in Shoreland or Wellhead Protection Areas or serving a food, beverage, or lodging establishment: Yes No*

Drainfield has a three-foot vertical separation distance from periodically saturated soil or bedrock.*

5c. "Experimental", "Other", or "Performance" systems built under pre-2008 Rules; Type IV or V systems built under 2008 Rules 7080.2350 or 7080.2400 (Intermediate Inspector License required ≤ 2,500 gallons per day; Advanced Inspector License required > 2,500 gallons per day) Yes No*

Drainfield meets the designed vertical separation distance from periodically saturated soil or bedrock.

*Any "no" answer above indicates the system is failing to protect groundwater.

Describe verification methods and results: Borings were done at the end of the rock bed and soils were good

Attached supporting documentation:

- Soil observation logs completed for the report
- Two previous verifications of required vertical separation
- Not applicable (No soil treatment area)
-

Existing Mound

Indicate depths or elevations

- A. Bottom of distribution media 12
- B. Periodically saturated soil/bedrock 25
- C. System separation 37" min
- D. Required compliance separation*

*May be reduced up to 15 percent if allowed by Local Ordinance.

Upgrade requirements: (Minn. Stat. § 115.55) An imminent threat to public health and safety (ITPHS) must be upgraded, replaced, or its use discontinued within ten months of receipt of this notice or within a shorter period if required by local ordinance. If the system is failing to protect ground water, the system must be upgraded, replaced, or its use discontinued within the time required by local ordinance. If an existing system is not failing as defined in law, and has at least two feet of design soil separation, then the system need not be upgraded, repaired, replaced, or its use discontinued, notwithstanding any local ordinance that is more strict. This provision does not apply to systems in shoreland areas, Wellhead Protection Areas, or those used in connection with food, beverage, and lodging establishments as defined in law.