

329th Place
Isle, MN 56342

10-25-23

JACOBSON PRECAST CONCRETE

TANK INSTALLATION INSTRUCTIONS

Model # 1650 Date Built: 10/20/22 Gallons: 1650 Bury Depth 2

Model # 1000S Date Built: 4/22/23 Gallons: 1000 Bury Depth 2 1/2

SITE CONDITION:

The site must be accessible to large, heavy trucks. Free of items like trees, stumps, overhead wires, etc. That could interfere with delivery or installation and allows trucks to within 3 to 5 ft of placement excavation.

EXCAVATION:

Excavation should be approximately 12" minimum larger than tank size to allow for adequate back fill. This may vary with soil conditions. Excavation shall have a level bottom so the weight bears on the outside walls of the tank.

BEDDING:

Each tank should be placed on about 6" of proper bedding material leveled, and should be compacted to minimum 95% compaction if tested, to ensure the life of the tank structure. Bedding must be capable of bearing the weight of the tank. Bedding material shall have the ability of 100% to pass through a 3/8" screen.

WATER TABLE:

When tanks are being placed where water levels can potentially be higher than the elevation of the tank cover, an alternate location should be considered. If water table is high installer must also consider the tank may float. If this is a possibility tank must be tied down before backfilling.

BACKFILL MATERIAL:

Sidewall of tanks require dry backfill materials that have the ability of 100% to be able to pass through a 2" screen and a minimum of 12" on all sides from the bottom to top of tank. Backfill material shall be placed to avoid impact loads on sidewall of the tank.

COVER MATERIAL:

Cover material shall be dry soil, material that has the ability of 100% to be able to pass through a 2" screen. Cover material shall be mounded over tank and around risers to direct run-off away from both.

INLET & OUTLET:

Pipe not to exceed 1" past the interior wall of tank where a baffle is used.

BURIAL DEPTH: Tanks to be installed according to model's maximum bury recommendations:

AITKIN COUNTY
CERTIFICATE OF INSTALLATION/~~NOTICE OF NONCOMPLIANCE~~

This certificate of installation/~~notice of noncompliance~~ has been issued this 26th day of October, 2023 to certify compliance/~~noncompliance~~ with Aitkin County's Subsurface Sewage Treatment System Ordinance.

The premises covered by this certificate are legally described as: _____
Lot 9 Block 1

Section 20 Township 44 Range 25 Lake Mille Lacs
PERMIT NO. 48131 Owner Name Monte Kuefler
Address 18xxx 329th Pl
Installer Name Liljequist Excavating
Type of System Inspected Type 3 3BR Mound
Parcel Number 16-1-09010

The certificate of installation/~~notice of noncompliance~~ was based on No 1 of the following:

- 1) Inspection of the installation or construction as in accordance with the above referenced permit and application design.

- 2) Review of as-built plans submitted in accordance with Subdivision 9.2 D of Aitkin County's Subsurface Sewage Treatment System Ordinance.

If the above permitted subsurface sewage treatment system is in noncompliance with Aitkin County's Subsurface Sewage Treatment System Ordinance, then the following shall serve as a Notice of Violation:

- 1) Statement of the findings of fact through inspections or investigations:

- 2) List of specific violations of Ordinance: _____

- 3) Requirements for correction or removal of violations: _____

- 4) Time schedule for compliance: _____

Failure to correct or remove the above violation(s) will result in this matter being turned over to the Aitkin County Attorney's Office for further legal action, which may result in revocation of licenses or registrations, fines and/or imprisonment.

INSPECTOR SIGNATURE Jody Grund

**SUBSURFACE SEWAGE TREATMENT SYSTEM INSPECTION FORM
AITKIN COUNTY, MINNESOTA**

Township Lakeside Date of Inspection 10/26/2023 App. Number 48131

Owner Monte Kuefler Parcel Number 16-1-090100

Project Address 18XXX 329th Pl Installer Liljequist Exc.

City Isle Zip Code 56342 Type 3 SBR mound

New Repair

SETBACKS:
Buildings to tank(s) 48'
Buildings to drainfield > 100'
Well(s) 50' or 100' > 50'
Lake/Creek/Wetland > 125'

SEPTIC TANKS: New Existing
Number of tanks installed 2
Liquid capacity and type 1650 gal Combo
Type of baffle Plastic
Inspection pipes Plastic
Manholes size 2x24" x 20"
Manhole to grade Yes No

PUMPS: New Existing
Tank capacity and type 1000 Jacobson
Pump manufacturer & model # Liberty 293
Horsepower & GPM 1/2 27gpm
Feet of head 26'
Gallons per cycle 144 gallons
Size of discharge line 2"
Type & location of alarm Electric Tank
Water meter _____

DIST. or DROP BOX & TYPE _____

TRENCHES, BEDS, OR GRAVELLESS LEACHFIELD:
Trench/Bed depth _____
Trench/Bed length _____
Trench/Bed bottom width _____
Trench spacing _____
Drainfield rock below pipe _____
Size of gravelless pipe _____
Depth of backfill _____
Absorption area: square feet _____
lineal feet _____

MOUNDS:
Percent slope 7%
Upslope sand width 12'
Downslope sand width 22'
Sideslope sand width 8'
Drainfield rock below pipe 6"
Depth of sand below rock 3"
Perforation size & spacing 1/4" x 3"
Pipe size & spacing 2"-3"
Dimensions of rock bed 10 x 38'
Dimensions of sand base 43' x 72'
Final cover 18"

DRAWING OF SYSTEM: (include soils)

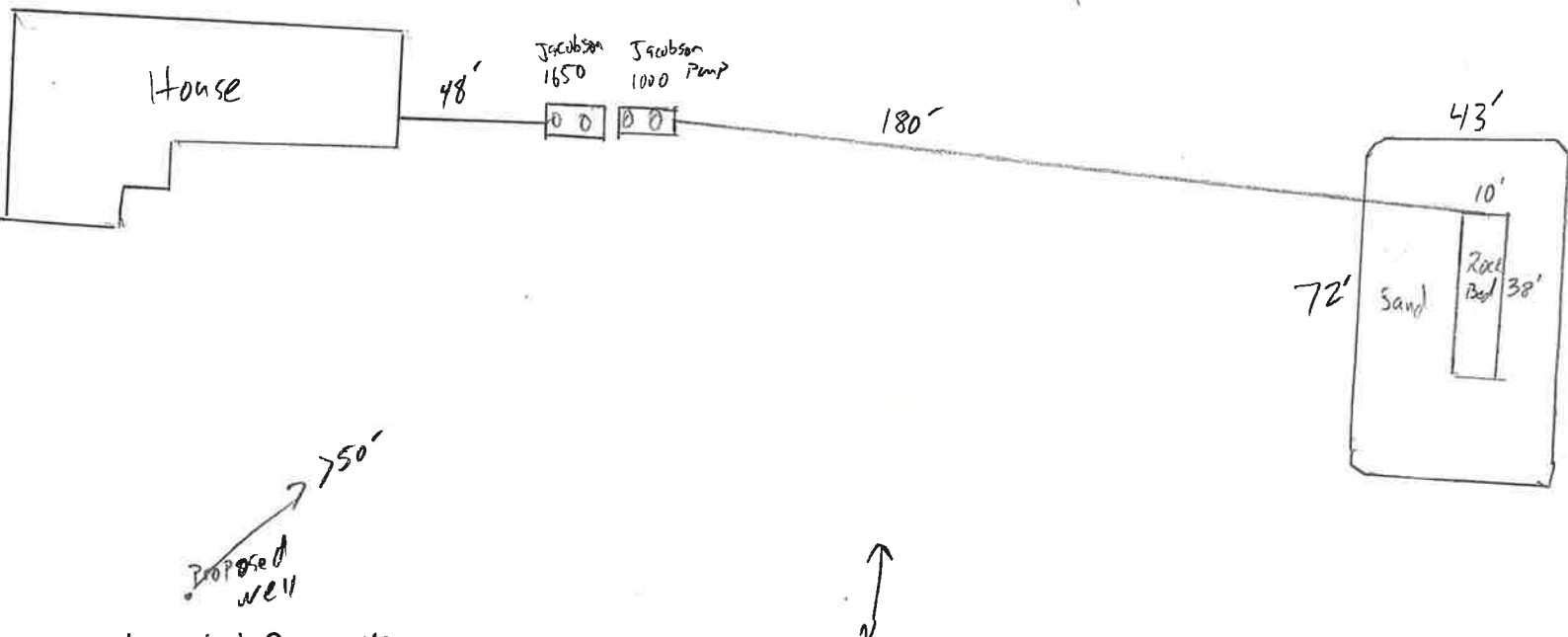

Inspector's Comments: _____

Inspector's Signature [Signature] Installer's Signature [Signature]
Rev. 1/13 White - County Yellow - Applicant Pink - Installer