

**SUBSURFACE SEWAGE TREATMENT SYSTEM INSPECTION FORM
AITKIN COUNTY, MINNESOTA**

2023-000277

Township Waukenaabo Date of Inspection 8/17/2023 I App. Number 47712

Owner Joel Robinson Parcel Number 35-0-059401

Project Address 46223 US Hwy 169 Installer Rod Kern

City Palisade Zip Code 56469 T1 3BR Mound

New Repair

DIST. or DROP BOX & TYPE _____

SETBACKS:

Buildings to tank(s) 25'
Buildings to drainfield 50'+
Well(s) 50' or 100' DW: 60'+
Lake/Creek/Wetland _____

TRENCHES, BEDS, OR GRAVELLESS LEACHFIELD:

Trench/Bed depth _____
Trench/Bed length _____
Trench/Bed bottom width _____
Trench spacing _____
Drainfield rock below pipe _____
Size of gravelless pipe _____
Depth of backfill _____
Absorption area: square feet _____
lineal feet _____

SEPTIC TANKS: New Existing

Number of tanks installed (1) 1650 Tac. Combo
Liquid capacity and type 1120 part Combo
Type of baffle Plastic

MOUNDS:

Percent slope 5%
Upslope sand width 10'
Downslope sand width 17.5'
Sideslope sand width 10'
Drainfield rock below pipe 9"
Depth of sand below rock 24"
Perforation size & spacing 0.25"/36" sp.
Pipe size & spacing 1.5"/36" sp.
Dimensions of rock bed 10' X 38'
Dimensions of sand base 37.5' X 58'
Final cover 51 X 81

Inspection pipes _____

Manholes size 24"

Manhole to grade Yes No

PUMPS: New Existing

Tank capacity and type 533 part Combo
Pump manufacturer & model # Gould PES1^{FE4}
Horsepower & GPM 1/2 HP 27 GPM
Feet of head 22'
Gallons per cycle 72 GPC
Size of discharge line 2"
Type & location of alarm Elec. on tank
Water meter _____

DRAWING OF SYSTEM: (include soils)

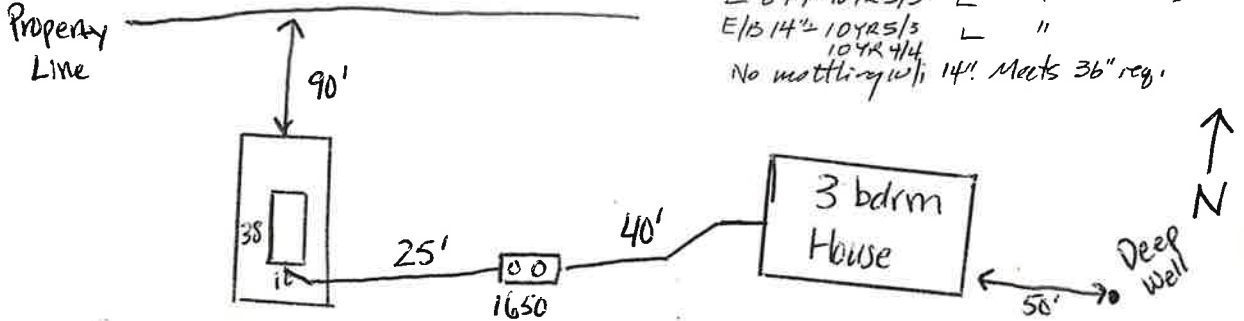

Inspector's Comments: 27' 2" pipe 25' 4"

Inspector's Signature Bryan Hargrave Installer's Signature Rod Kern

AITKIN COUNTY
CERTIFICATE OF INSTALLATION/~~NOTICE OF NONCOMPLIANCE~~

This certificate of installation/~~notice of noncompliance~~ has been issued this 24th day of October, 2023 to certify compliance/~~noncompliance~~ with Aitkin County's Subsurface Sewage Treatment System Ordinance.

The premises covered by this certificate are legally described as: _____
S1/2 OF S1/2 OF NE OF SW

Section 35 Township 49 Range 26 Lake N/A
PERMIT NO. 47712 Owner Name Joel & Kalla Robinson
Address 46223 US HWY 169
Installer Name _____ Rod Kern
Type of System Inspected _____ Type I 3 Bedroom Mound
Parcel Number 35-0-059401

The certificate of installation/~~notice of noncompliance~~ was based on No 1 of the following:

- 1) Inspection of the installation or construction as in accordance with the above referenced permit and application design.

- 2) Review of as-built plans submitted in accordance with Subdivision 9.2 D of Aitkin County's Subsurface Sewage Treatment System Ordinance.

If the above permitted subsurface sewage treatment system is in noncompliance with Aitkin County's Subsurface Sewage Treatment System Ordinance, then the following shall serve as a Notice of Violation:

- 1) Statement of the findings of fact through inspections or investigations:

2) List of specific violations of Ordinance: _____

3) Requirements for correction or removal of violations: _____

4) Time schedule for compliance: _____

Failure to correct or remove the above violation(s) will result in this matter being turned over to the Aitkin County Attorney's Office for further legal action, which may result in revocation of licenses or registrations, fines and/or imprisonment.

INSPECTOR SIGNATURE _____

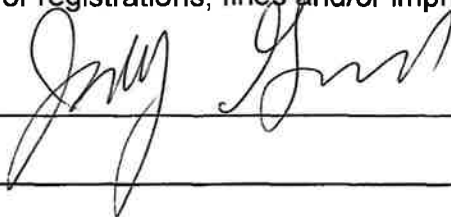

JACOBSON PRECAST CONCRETE

TANK INSTALLATION INSTRUCTIONS

Model # 1650 Date Built: 10-31-22 Gallons: 1650 Bury Depth _____

Model # _____ Date Built: _____ Gallons: _____ Bury Depth _____

SITE CONDITION:

The site must be accessible to large, heavy trucks. Free of items like trees, stumps, overhead wires, etc. That could interfere with delivery or installation and allows trucks to within 3 to 5 ft of placement excavation.

EXCAVATION:

Excavation should be approximately 12" minimum larger than tank size to allow for adequate back fill. This may vary with soil conditions. Excavation shall have a level bottom so the weight bears on the outside walls of the tank.

BEDDING:

Each tank should be placed on about 6" of proper bedding material leveled, and should be compacted to minimum 95% compaction if tested, to ensure the life of the tank structure. Bedding must be capable of bearing the weight of the tank. Bedding material shall have the ability of 100% to pass through a 1/2" screen.

WATER TABLE:

When tanks are being placed where water levels can potentially be higher than the elevation of the tank cover, an alternate location should be considered. If water table is high installer must also consider the tank may float, if this is a possibility tank must be tied down before backfilling.

BACKFILL MATERIAL:

Sidewall of tanks require dry backfill materials that have the ability of 100% to be able to pass through a 2" screen and a minimum of 12" on all sides from the bottom to top of tank. Backfill material shall be placed to avoid impact loads on sidewall of the tank.

COVER MATERIAL:

Cover material shall be dry soil, material that has the ability of 100% to be able to pass through a 2" screen. Cover material shall be mounded over tank and around risers to direct run-off away from both.

INLET & OUTLET:

Pipe not to exceed 1" past the interior wall of tank where a baffle is used.

BURIAL DEPTH: Tanks to be installed according to model's maximum bury recommendations: