

AITKIN COUNTY
CERTIFICATE OF INSTALLATION/~~NOTICE OF NONCOMPLIANCE~~

This certificate of installation/~~notice of noncompliance~~ has been issued this 23rd day of November, 2022 to certify compliance/~~noncompliance~~ with Aitkin County's Subsurface Sewage Treatment System Ordinance.

The premises covered by this certificate are legally described as: _____
Lot 16 Echo Hill Townsite

Section 26 Township 43 Range 22 Lake Pine
PERMIT NO. 47477 Owner Name Andrew & Sarah Pung
Address 11581 117th St Finlayson, Mn 55735
Installer Name Jensen Backhoe Service
Type of System Inspected Type II Holding Tank
Parcel Number 34-1-072200

The certificate of installation/~~notice of noncompliance~~ was based on No 1 of the following:

- 1) Inspection of the installation or construction as in accordance with the above referenced permit and application design.

- 2) Review of as-built plans submitted in accordance with Subdivision 9.2 D of Aitkin County's Subsurface Sewage Treatment System Ordinance.

If the above permitted subsurface sewage treatment system is in noncompliance with Aitkin County's Subsurface Sewage Treatment System Ordinance, then the following shall serve as a Notice of Violation:

- 1) Statement of the findings of fact through inspections or investigations:

- 2) List of specific violations of Ordinance: _____

- 3) Requirements for correction or removal of violations: _____

- 4) Time schedule for compliance: _____

Failure to correct or remove the above violation(s) will result in this matter being turned over to the Aitkin County Attorney's Office for further legal action, which may result in revocation of licenses, fines and/or imprisonment.

INSPECTOR SIGNATURE _____



**SUBSURFACE SEWAGE TREATMENT SYSTEM INSPECTION FORM
AITKIN COUNTY, MINNESOTA**

Township Wagner Date of Inspection 11-23-22 App. Number 2022-009285
 Owner Andrew & Sarah Pung Parcel Number 34-1-072200
 Project Address 11581 117th St Installer Jensen backhoe
 City Finlayson Zip Code 55735

New Repair

DIST. or DROP BOX & TYPE _____

SETBACKS:

Buildings to tank(s) >50' - new tank
 Buildings to drainfield _____
 Well(s) 50' or 100' 50' - East neighbor
 Lake/Creek/Wetland >100'

TRENCHES, BEDS, OR GRAVELLESS LEACHFIELD:

Trench/Bed depth _____
 Trench/Bed length _____
 Trench/Bed bottom width _____
 Trench spacing _____
 Drainfield rock below pipe _____
 Size of gravelless pipe _____
 Depth of backfill _____
 Absorption area: square feet _____
 lineal feet _____

SEPTIC TANKS: New Existing _____

Number of tanks installed 1 Knife River
 Liquid capacity and type 2000 precast
 Type of baffle Plastic
 Inspection pipes _____

MOUNDS:

Percent slope _____
 Upslope sand width _____
 Downslope sand width _____
 Sideslope sand width _____
 Drainfield rock below pipe _____
 Depth of sand below rock _____
 Perforation size & spacing _____
 Pipe size & spacing _____
 Dimensions of rock bed _____
 Dimensions of sand base _____
 Final cover _____

Manholes size 3 @ 24"
 Manhole to grade Yes No _____

PUMPS: New _____ Existing

Tank capacity and type 2 - 800 gallon plastic
 Pump manufacturer & model # Liberty L162
 Horsepower & GPM 1 hp 40 gpm
 Feet of head 28
 Gallons per cycle _____
 Size of discharge line 2"
 Type & location of alarm Elec in house
 Water meter _____

DRAWING OF SYSTEM: (include soils)

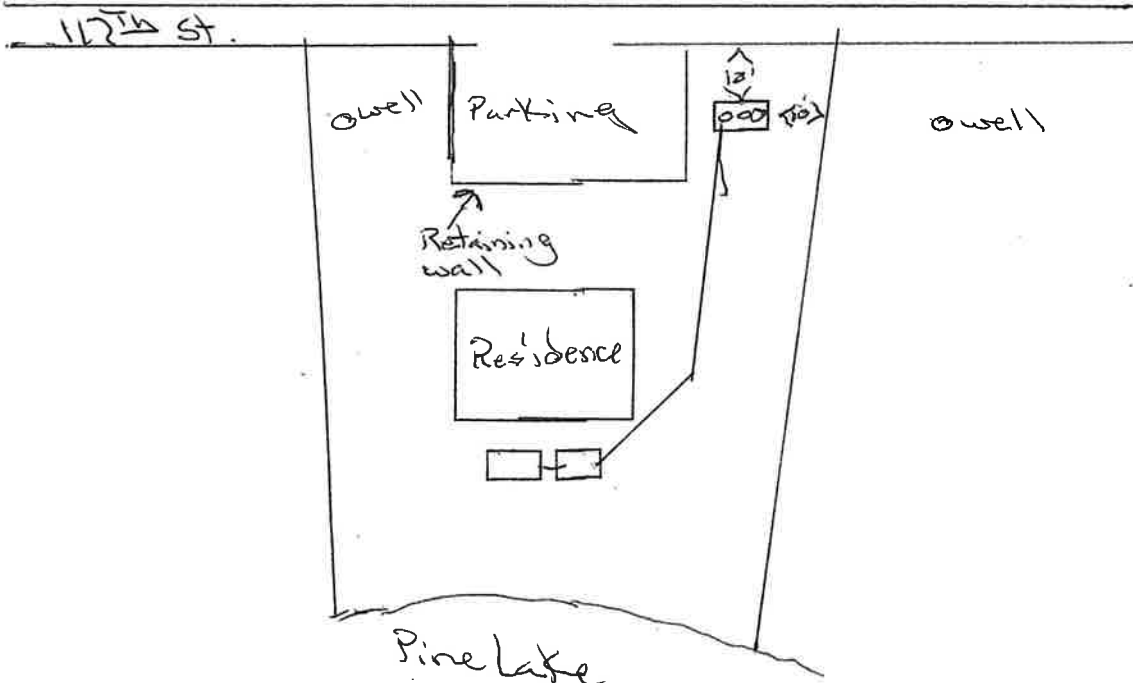

Inspector's Comments: _____

Inspector's Signature H. Pung Installer's Signature _____