

AITKIN COUNTY
CERTIFICATE OF INSTALLATION/~~NOTICE OF NONCOMPLIANCE~~

This certificate of installation/~~notice of noncompliance~~ has been issued this 28th day of November, 2022 to certify compliance/~~noncompliance~~ with Aitkin County's Subsurface Sewage Treatment System Ordinance.

The premises covered by this certificate are legally described as: _____
Lot 1 Blk 3 Wealthwood Golf Estates

Section 21 Township 45 Range 26 Lake _____
PERMIT NO. 47466 Owner Name James Dougherty
Address 37789 Clover St Aitkin, Mn 56431
Installer Name Westerlund Construction
Type of System Inspected 4 Bdrm Type I At Grade
Parcel Number 36-1-083000

The certificate of installation/~~notice of noncompliance~~ was based on No 1 of the following:

- 1) Inspection of the installation or construction as in accordance with the above referenced permit and application design.

- 2) Review of as-built plans submitted in accordance with Subdivision 9.2 D of Aitkin County's Subsurface Sewage Treatment System Ordinance.

If the above permitted subsurface sewage treatment system is in noncompliance with Aitkin County's Subsurface Sewage Treatment System Ordinance, then the following shall serve as a Notice of Violation:

- 1) Statement of the findings of fact through inspections or investigations:

2) List of specific violations of Ordinance: _____

3) Requirements for correction or removal of violations: _____

4) Time schedule for compliance: _____

Failure to correct or remove the above violation(s) will result in this matter being turned over to the Aitkin County Attorney's Office for further legal action, which may result in revocation of licenses, fines and/or imprisonment.

INSPECTOR SIGNATURE _____



**SUBSURFACE SEWAGE TREATMENT SYSTEM INSPECTION FORM
AITKIN COUNTY, MINNESOTA**

Township Waltham Date of Inspection 11-28-22 App. Number 2022-009755

Owner James Dougherty Parcel Number 36-1-083000

Project Address 37789 Clover St. Installer Westerlund

City Aitkin Zip Code 56431

New Repair

SETBACKS:

Buildings to tank(s) 17'
Buildings to drainfield >50'
Well(s) 50' or 100' >100'
Lake/Creek/Wetland —

SEPTIC TANKS:

New Existing Cemstone
Number of tanks installed 2-1 septic pumps
Liquid capacity and type 1500 precast
Type of baffle Plastic
Inspection pipes —
Manholes size 3 @ 24"
Manhole to grade Yes No

PUMPS:

New Existing
Tank capacity and type 1000 precast-cemstone
Pump manufacturer & model # Zeller BN152
Horsepower & GPM .4 hp 21 gpm
Feet of head 12'
Gallons per cycle 150'
Size of discharge line 2"
Type & location of alarm elec @ Tank
Water meter —

DIST. or DROP BOX & TYPE

TRENCHES, BEDS, OR GRAVELLESS LEACHFIELD:

Trench/Bed depth —
Trench/Bed length —
Trench/Bed bottom width —
Trench spacing —
Drainfield rock below pipe —
Size of gravelless pipe —
Depth of backfill —
Absorption area: square feet —
lineal feet —

MOUNDS:

Percent slope 1
Upslope sand width 7.5'
Downslope sand width 14'
Sideslope sand width 7.5
Drainfield rock below pipe 10"
Depth of sand below rock At grade
Perforation size & spacing 1/4" x 3
Pipe size & spacing 1-2"
Dimensions of rock bed 9 x 88
Dimensions of sand base 22 x 101
Final cover 12" Top 6" Sides

DRAWING OF SYSTEM: (include soils)

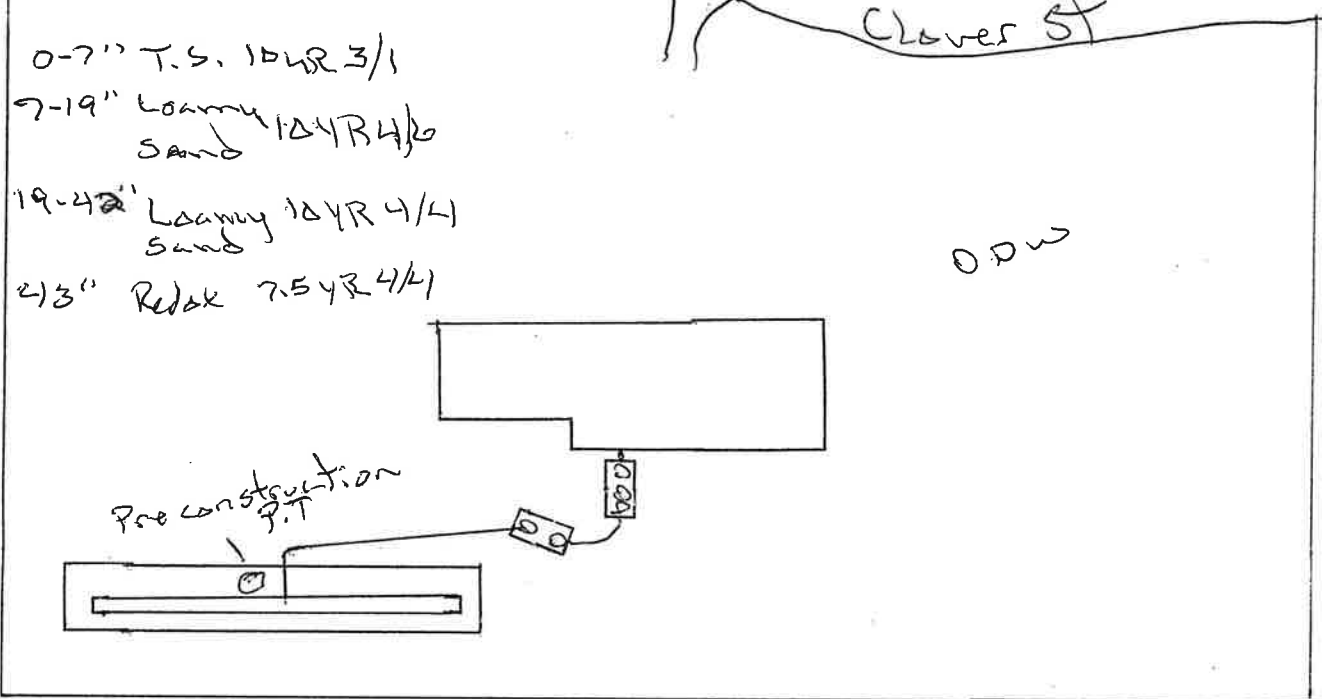

Inspector's Comments: _____

Inspector's Signature _____ Installer's Signature _____