

Compliance inspection report form

Existing Subsurface Sewage Treatment System (SSTS)

Doc Type: Compliance and Enforcement

Instructions: Inspector must submit completed form to Local Governmental Unit (LGU) and system owner within 15 days of final determination of compliance or noncompliance. Instructions for filling out this form are located on the Minnesota Pollution Control Agency (MPCA) website at <https://www.pca.state.mn.us/sites/default/files/wq-wwists4-31a.pdf>.

Property information

Local tracking number: _____
 Parcel ID# or Sec/Twp/Range: 29-1-427600 Reason for Inspection Permit
 Local regulatory authority info: Aitkin Co
 Property address: 50508 202nd PL. McGregor MN 55760
 Owner/representative: Robert Lester Owner's phone: 218-357-2264
 Brief system description: Gravity Flow from trailer house to 1000 gal. septic tank, gravity flow to 2 trenches, 42' ft long, 3 ft wide with 18" rock under pipe Installed as 450 GPD at .83 soil sizing (3 bedroom)

System status

System status on date (mm/dd/yyyy): 9/30/2022

- Compliant – Certificate of compliance*** **Noncompliant – Notice of noncompliance**
- (Valid for 3 years from report date unless evidence of an imminent threat to public health or safety requiring removal and abatement under section 145A.04, subdivision 8 is discovered or a shorter time frame exists in Local Ordinance.)*
- Systems failing to protect ground water must be upgraded, replaced, or use discontinued within the time required by local ordinance.*
- An imminent threat to public health and safety (ITPHS) must be upgraded, replaced, or its use discontinued within ten months of receipt of this notice or within a shorter period if required by local ordinance or under section 145A.04 subdivision 8.*

***Note: Compliance indicates conformance with Minn. R. 7080.1500 as of system status date above and does not guarantee future performance.**

Reason(s) for noncompliance (check all applicable)

- Impact on public health (Compliance component #1) – *Imminent threat to public health and safety*
- Tank integrity (Compliance component #2) – *Failing to protect groundwater*
- Other Compliance Conditions (Compliance component #3) – *Imminent threat to public health and safety*
- Other Compliance Conditions (Compliance component #3) – *Failing to protect groundwater*
- System not abandoned according to Minn. R. 7080.2500 (Compliance component #3) – *Failing to protect groundwater*
- Soil separation (Compliance component #5) – *Failing to protect groundwater*
- Operating permit/monitoring plan requirements (Compliance component #4) – *Noncompliant - local ordinance applies*

Comments or recommendations

450 GPD x .83= 374 sq ft. 374 x .66 (18" rock) =246 sq ft 246 / 3 ft wide trench = 82 lin ft required (84 ft installed.)

Certification

I hereby certify that all the necessary information has been gathered to determine the compliance status of this system. No determination of future system performance has been nor can be made due to unknown conditions during system construction, possible abuse of the system, inadequate maintenance, or future water usage.

By typing my name below, I certify the above statements to be true and correct, to the best of my knowledge, and that this information can be used for the purpose of processing this form.

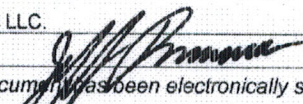
Business name: Brummer Septic LLC Certification number: C-3589
 Inspector signature:  License number: L-1347
 (This document has been electronically signed) Phone: 218-821-0704

Necessary or locally required supporting documentation (must be attached)

- Soil observation logs
- System/As-Built
- Locally required forms
- Tank Integrity Assessment
- Operating Permit
- Other information (list): Included prior soil verification

Property Address: 50508 202nd PL. McGregor MN 55760

Business Name: Brummer Septic LLC.

Date: 9/30/2022

1. Impact on public health – Compliance component #1 of 5

Compliance criteria:

System discharges sewage to the ground surface Yes* No

System discharges sewage to drain tile or surface waters. Yes* No

System causes sewage backup into dwelling or establishment. Yes* No

Any "yes" answer above indicates the system is an imminent threat to public health and safety.

Describe verification methods and results:

Checked Drainfield / Mound Area For surfacing

Checked Drainfield / Mound Area for Seepage

Checked For Ponding in Existing Inspection Pipes

Attached supporting documentation:

Other: _____

Not applicable

2. Tank integrity – Compliance component #2 of 5

Compliance criteria:

System consists of a seepage pit, cesspool, drywell, leaching pit, or other pit? Yes* No

Sewage tank(s) leak below their designed operating depth? Yes* No

If yes, which sewage tank(s) leaks: _____

Any "yes" answer above indicates the system is failing to protect groundwater.

Describe verification methods and results:

Tank was inspected through manhole

Attached supporting documentation:

Empty tank(s) viewed by inspector

Name of maintenance business: _____

License number of maintenance business: _____

Date of maintenance: _____

Existing tank integrity assessment (Attach)

Date of maintenance 9/30/2022
(mm/dd/yyyy): (must be within three years)

(See form instructions to ensure assessment complies with Minn. R. 7082.0700 subp. 4 B (1))

Tank is Noncompliant (pumping not necessary – explain below)

Other: _____

Property Address: 50508 202nd PL. McGregor MN 55760

Business Name: Brummer Septic LLC.

Date: 9/30/2022

3. Other compliance conditions – Compliance component #3 of 5

3a. Maintenance hole covers appear to be structurally unsound (damaged, cracked, etc.), or unsecured?

Yes* No Unknown

3b. Other issues (electrical hazards, etc.) to immediately and adversely impact public health or safety? Yes* No Unknown

**Yes to 3a or 3b - System is an imminent threat to public health and safety.*

3c. System is non-protective of ground water for other conditions as determined by inspector?

Yes* No

3d. System not abandoned in accordance with Minn. R. 7080.2500?

Yes* No

**Yes to 3c or 3d - System is failing to protect groundwater.*

Describe verification methods and results:

Attached supporting documentation: Not applicable

4. Operating permit and nitrogen BMP* – Compliance component #4 of 5 Not applicable

Is the system operated under an Operating Permit? Yes No If "yes", A below is required

Is the system required to employ a Nitrogen BMP specified in the system design? Yes No If "yes", B below is required

BMP = Best Management Practice(s) specified in the system design

If the answer to both questions is "no", this section does not need to be completed.

Compliance criteria:

a. Have the operating permit requirements been met? Yes No

b. Is the required nitrogen BMP in place and properly functioning? Yes No

Any "no" answer indicates noncompliance.

Describe verification methods and results:

Attached supporting documentation: Operating permit (Attach)

Property Address: 50508 202nd PL. McGregor MN 55760

Business Name: Brummer Septic LLC.

Date: 9/30/2022

5. Soil separation – Compliance component #5 of 5

Date of installation 1996 Unknown
(mm/dd/yyyy)

Shoreland/Wellhead protection/Food beverage lodging? Yes No

Compliance criteria (select one):

5a. For systems built prior to April 1, 1996, and not located in Shoreland or Wellhead Protection Area or not serving a food, beverage or lodging establishment: Yes No*

Drainfield has at least a two-foot vertical separation distance from periodically saturated soil or bedrock.

5b. Non-performance systems built April 1, 1996, or later or for non-performance systems located in Shoreland or Wellhead Protection Areas or serving a food, beverage, or lodging establishment: Yes No*

Drainfield has a three-foot vertical separation distance from periodically saturated soil or bedrock.*

5c. "Experimental", "Other", or "Performance" systems built under pre-2008 Rules; Type IV or V systems built under 2008 Rules 7080.2350 or 7080.2400 Yes No*

(Intermediate Inspector License required ≤ 2,500 gallons per day; Advanced Inspector License required > 2,500 gallons per day)

Drainfield meets the designed vertical separation distance from periodically saturated soil or bedrock.

***Any "no" answer above indicates the system is failing to protect groundwater.**

Describe verification methods and results:

Conducted soil boring #1 near lowest trench in original soils.

Attached supporting documentation:

- Soil observation logs completed for the report
- Two previous verifications of required vertical separation
- Not applicable (No soil treatment area)
- Included soils verification 2013

This is the 2nd soils verification on this system.

Indicate depths or elevations

A. Bottom of distribution media	Elev.= 92.2'
B. Periodically saturated soil/bedrock	Elev.= 88.6'
C. System separation	36"
D. Required compliance separation*	36"

*May be reduced up to 15 percent if allowed by Local Ordinance.

Upgrade requirements: (Minn. Stat. § 115.55) An imminent threat to public health and safety (ITPHS) must be upgraded, replaced, or its use discontinued within ten months of receipt of this notice or within a shorter period if required by local ordinance. If the system is failing to protect ground water, the system must be upgraded, replaced, or its use discontinued within the time required by local ordinance. If an existing system is not failing as defined in law, and has at least two feet of design soil separation, then the system need not be upgraded, repaired, replaced, or its use discontinued, notwithstanding any local ordinance that is more strict. This provision does not apply to systems in shoreland areas, Wellhead Protection Areas, or those used in connection with food, beverage, and lodging establishments as defined in law.

Purpose: This form *may* be used to certify the compliance status of the sewage tank components of the SSTS. **This form is not a complete SSTS inspection report, only a tank integrity assessment, and may only certify sewage tank compliance status when entirely completed and signed by a qualified professional.** SSTS compliance inspection report forms can be found at: <https://www.pca.state.mn.us/water/inspections>.

Instructions: This form may be completed, and signed, by a Designated Certified Individual (DCI) of a licensed SSTS inspection, maintenance, installation, or service provider business who personally conducts the necessary procedures to assess the compliance status of each sewage tank in the system. Only a licensed maintenance business is authorized to pump the tank for assessment. A copy of this information should be submitted to the system owner and be maintained by the licensed SSTS business for a period of five (5) years from the assessment date.

When this form is signed by a qualified certified professional, it becomes *necessary supporting documentation* to an Existing System Compliance Inspection Report: Compliance inspection form - Existing system (wq-wwists4-31b). This form can be found on the MPCA website at <https://www.pca.state.mn.us/water/inspections>.

The information and certified statement on this form is **required** when existing septic tank compliance status is determined by an individual other than the SSTS Inspector that submits an inspection report. This form represents a third party assessment of SSTS component compliance and is allowable under Minn. R. 7082.0700, subp. 4(B)(1). This form is valid for a period of three years beyond the signature date on this form unless a new evaluation is requested by the owner or owner's agent or is required according to local regulations. Additional Administrative Rule references for this activity can be found at Minn. R. 7082.0700, subp. 4(B),(C), and (D) and Minn. R. 7083.0730(C).

Owner information

Owner/Representative Robert Lester

Property address: 50508 202nd Place McGregor MN 55760

Local Regulatory Authority: Aitkin County

Parcel ID: 29-1-427600

System status

System status on date (mm/dd/yyyy): 9/30/2022

Certificate of sewage tank compliance

Notice of sewage tank non-compliance

Compliance criteria:

The SSTS has a seepage pit, cesspool, drywell, leaching pit, or other pit - "Failure to Protect Groundwater."

Yes* No

The SSTS has a sewage tank that leaks below the designed operating depth - "Failure to Protect Groundwater."

Yes* No

The SSTS presents a threat to public safety by reason of structurally unsound (damaged, cracked, or weak) maintenance hole cover(s) or lids or any other unsafe condition - "Imminent Threat to Public Health or Safety."

Yes* No

Any "yes" answer above indicates sewage tank non-compliance.

Company information

Company name: Timber Lakes Septic Service Inc

Business license number: L455

Designated Certified Individual (DCI) information

Print name: Dan Swanson

Certification number: C6023

I personally conducted the work described above as a Designated Certified Individual of a Minnesota-licensed SSTS inspection, maintenance, installation, or service provider Business. I personally conducted the necessary procedures to assess the compliance status of each sewage tank in this SSTS.

By typing/signing my name below, I certify the above statements to be true and correct, to the best of my knowledge, and that this information can be used for the purpose of processing this form.

Designated Certified Individual's signature: Dan Swanson

Date (mm/dd/yyyy): 9/30/2022

(This document has been electronically signed.)

{ Inspection Drawing }

Property Owner: Robert Lester Date: 9/30/2022 Designer's Initials: JB
 Parcel ID. Number: 29-1-427600 Address: 50508 202nd Pl. McGregor MN 55760
 Aitkin Co. One Inch = 40ft.'

Drainfield As/built was confirmed and used for parts of this inspection

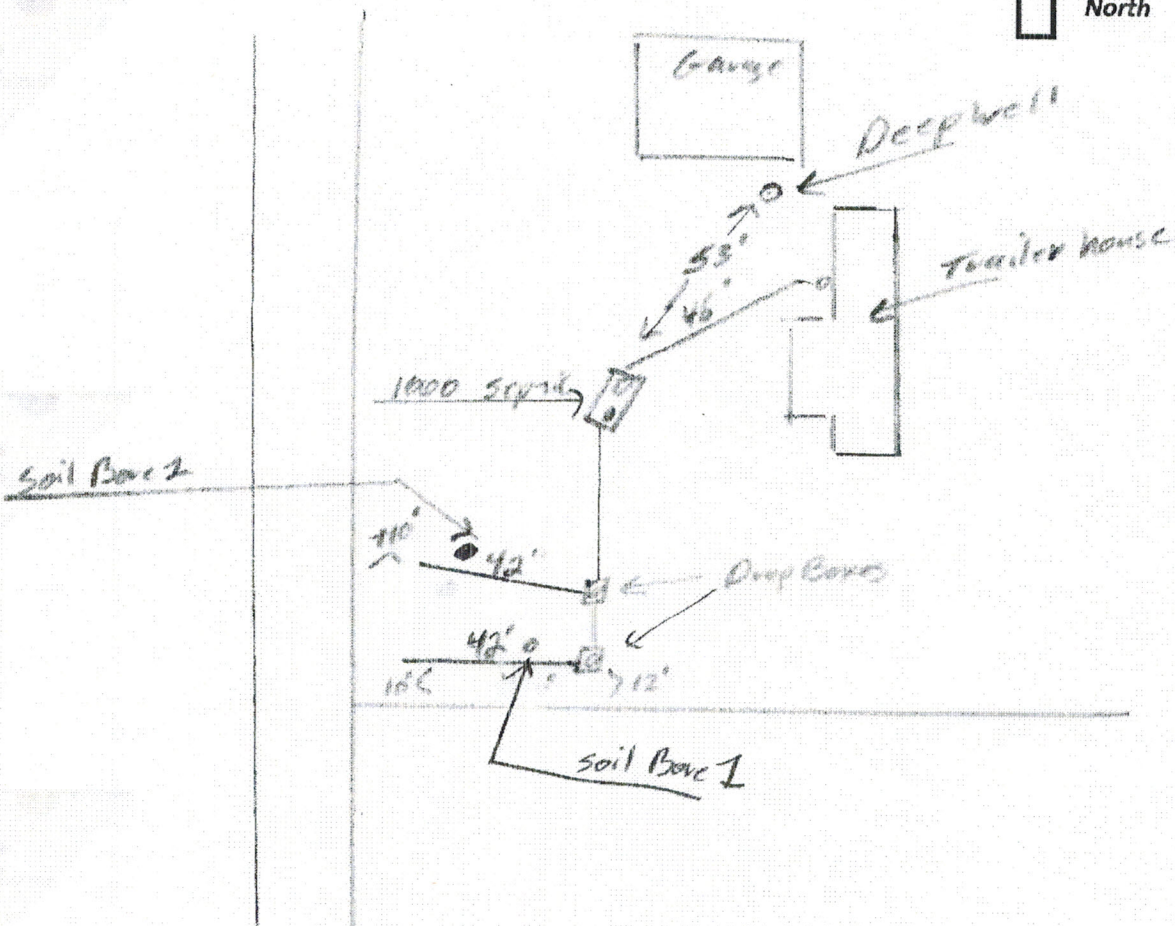

Elev. Of ground at Septic Tank = 99.8'
 Inlet Septic Tank Elev. = 97.8'
 Outlet Septic Tank Elev. = 97.5'

Estimated Lake Elev.= 56'
 Grade at Clean-out near Trailer house Elev.= 97.3'
 Lowest Trench Center of Treck Grade Elev.= 94.5'
 Elev. Of bottom of rock bed Lowest Trench Elev. = 92.2'

Bench Mark Elev. =100' Top of Deep Well Cap
 Ground at well Elev. = 98.6'

4" of Cover + 24" rock = 2.3 ft.

SB-1 Lowest Trench
 SB-2 Highest trench

SB - 1 Top of Ground Soil Boring Elev. = 94.8'

SB - 2 Top of Ground Elev.= 96.7'

Depth (in.)	Texture	Color
0 - 5	Top Soil	10YR3/2
5 - 19	Med Sand	10YR4/4
19 - 28	Med Sand	10YR5/4
28 - 43	Med Sand	7.5YR4/4
43 - 74	Med Sand	10YR5/4
74 - 80	Med Sand	10YR6/4
74 - 80	Mottles	7.5YR5/6

Elev. = 88.6

Depth (in.)	Texture	Color
0 - 9	Top Soil	10YR3/2
9 - 17	Med Sand	10YR4/3
17 - 36	Med Sand	10YR5/4
36 - 40	Med Sand	7.5YR4/4
40 - 76	Med Sand	10YR5/4
76	Mottles	7.5YR5/6

Elev.= 90.4'

Big Sandy Lake

Bernadette Lester
29-1-427660
50508 202nd Place

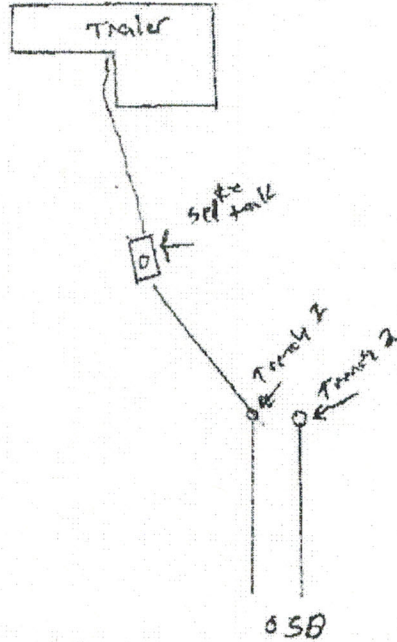

SSB

Soil boring

0 to 4" Topsoil
 4" to 60" Sand 7.5% R 1/4
 60 to 64" Sand 7.5% K 5/4
 padded boring

Elevation 5

Bottom rock Trinch 1 = 89"
 Bottom rock Trinch 2 = 98"
 Ground soil boring = 90"
 padded boring = 134"
 Meets 36" separation

Mole & Ritter
#1672

Page 4 of 5

**INDIVIDUAL SEWAGE TREATMENT SYSTEM INSPECTION FORM
AITKIN COUNTY, MINNESOTA**

Township Shannon Date of Inspection 9-5-96 Permit Number 2240
 Owner Bernadette Lester Parcel Number 29-1-427600
 Project Address Lot 48 LaBrew & Reuter Installer Eddy
Section 8-49-23
 City _____ Zip Code _____ New Repair _____

SETBACKS:

Buildings to tank(s) 30'
 Buildings to drainfield 70'
 Well(s) 50' or (100') (100')
 Lake/Creek/Wetland Big Sandy

SEPTIC TANKS:

Liquid capacity 1000
 Manufacturer & type Jac
 Type of baffle Plastic
 Inspection pipes 2
 Manholes access 24"
 No. & height of risers None

MOUNDS:

Percent slope _____
 Upslope dike width _____
 Downslope dike width _____
 Sideslope dike width _____
 Drainfield rock below pipe _____
 Depth of sand below rock _____
 Perforation size & spacing _____
 Pipe size & spacing _____
 Dimensions of rock bed _____
 Dimensions of sand base _____
 Final cover _____

DIST. or DROP BOX & TYPE

TRENCHES, BEDS, OR GRAVELLESS LEACHFIELD:

Trench depth 30"
 Trench length 84'
 Trench bottom width 3'
 Trench bottom level yes
 Trench spacing 8'
 Drainfield rock below pipe 18"
 Size of gravelless pipe _____
 Depth of backfill 12"
 Absorption area: square feet 381
 lineal feet 84

PUMPS:

Tank capacity _____
 Tank manufacturer & type _____
 No. & height of risers _____
 Pump manufacturer & model# _____
 Horsepower & GPM _____
 Feet of head _____
 Cycles per day _____
 Gallons per cycle _____
 Size of discharge line _____
 Type of electrical hookup _____
 Type & location of alarm _____
 Cycle counter (commercial) _____

DRAWING OF SYSTEM

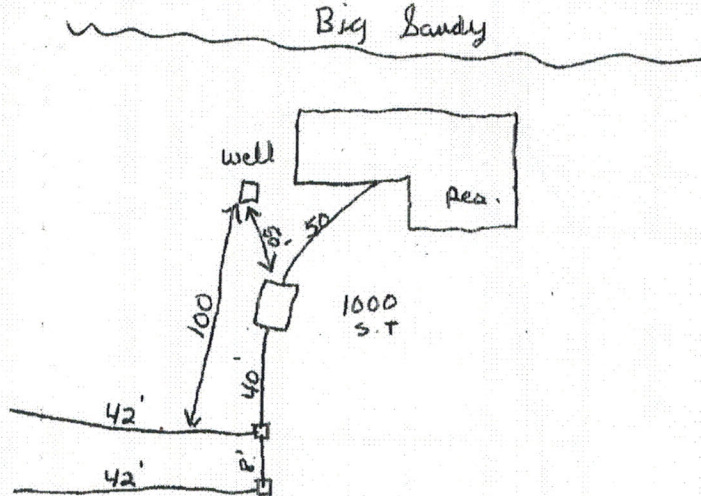

Inspector's Comments _____

Corrective Action Required _____

Inspector's Signature Ed Kehn

Installer's Signature Ken Eddy

White-County Yellow-Applicant Pink-Installer



Detailed Parcel Report

Parcel Number: 29-1-427600

General Information

Trailer middle lot.

Township/City: SHAMROCK TWP
 Taxpayer Name: LESTER, ROBERT & KIM TRUSTEES
 Taxpayer Address: 20139 CANBERRA CT
 FARMINGTON MN 55024
 Property Address: 50508 202nd PI
 Township: 49 Lake Number: 1906200
 Range: 23 Lake Name: BIG SANDY - BACK LOT
 Section: 8 Acres: 0.00
 Green Acres: No School District: 4.00
 Plat: LAKE VIEW CLARK AND REITERS PLAT SANDY LAKE
 Brief Legal Description: LOT 48

Tax Information

Class Code 1: Non-Comm Seasonal Residential Recreational
 Class Code 2: Unclassified
 Class Code 3: Unclassified
 Homestead: Non Homestead
 Assessment Year: 2022

Estimated Land Value:	\$25,000.00
Estimated Building Value:	\$38,100.00
Estimated Total Value:	<u>\$63,100.00</u>
Prior Year Total Taxable Value:	\$46,700.00
Current Year Net Tax (Specials Not Included):	\$380.00
Total Special Assessments:	\$0.00
**Current Year Balance Not Including Penalty:	\$190.00
Delinquent Taxes:	No

* For more information on delinquent taxes, please call the Aitkin County Treasurer's Office at 218-927-7325.

** Balance Due on a parcel does not include late payment penalties.