

Kohl's Concepts  
7-5-23

**JACOBSON PRECAST CONCRETE, LLC**

**TANK INSTALLATION INSTRUCTIONS**

Model # 1820 Date Built: 10-19-22 Gallons: 1820 Bury Depth 3'  
Model # 1000 Date Built: 9-15-21 Gallons: 1000 Bury Depth 3'

**SITE CONDITION:**

The site must be accessible to large, heavy trucks. Free of items like trees, stumps, overhead wires, etc. That could interfere with delivery or installation and allows trucks to within 3 to 5 ft of placement excavation.

**EXCAVATION:**

Excavation should be approximately 12" minimum larger than tank size to allow for adequate back fill. This may vary with soil conditions. Excavation shall have a level bottom so the weight bears on the outside walls of the tank.

**BEDDING:**

Each tank should be placed on about 6" of proper bedding material leveled, and should be compacted to minimum 95% compaction if tested, to ensure the life of the tank structure. Bedding must be capable of bearing the weight of the tank. Bedding material shall have the ability of 100% to pass through a 1/2" screen.

**WATER TABLE:**

When tanks are being placed where water levels can potentially be higher than the elevation of the tank cover, an alternate location should be considered. If water table is high installer must also consider the tank may float, if this is a possibility tank must be tied down before backfilling.

**BACKFILL MATERIAL:**

Sidewall of tanks require dry backfill materials that have the ability of 100% to be able to pass through a 2" screen and a minimum of 12" on all sides from the bottom to top of tank. Backfill material shall be placed to avoid impact loads on sidewall of the tank.

**COVER MATERIAL:**

Cover material shall be dry soil, material that has the ability of 100% to be able to pass through a 2" screen. Cover material shall be mounded over tank and around risers to direct run-off away from both.

**INLET & OUTLET:**

Pipe not to exceed 1" past the interior wall of tank where a baffle is used.

**BURIAL DEPTH:** Tanks to be installed according to model's maximum bury recommendations:

**SUBSURFACE SEWAGE TREATMENT SYSTEM INSPECTION FORM  
AITKIN COUNTY, MINNESOTA**

Township Shanpack Date of Inspection 7-14-23 final 7-5-23 Initial App. Number 2223-000306

Owner RASJ Landcs LLC series 1 Parcel Number 29-0-037400

Project Address 21726 497th Ln Installer Kahl's Concepts

City McGregor Zip Code 55765

New  Repair

DIST. or DROP BOX & TYPE \_\_\_\_\_

**SETBACKS:**  
Buildings to tank(s) 24' Hse 11' small shed  
Buildings to drainfield 36'  
Well(s) 50' or 100' 67'  
Lake/Creek/Wetland \_\_\_\_\_

**TRENCHES, BEDS, OR GRAVELLESS LEACHFIELD:**  
Trench/Bed depth \_\_\_\_\_  
Trench/Bed length \_\_\_\_\_  
Trench/Bed bottom width \_\_\_\_\_  
Trench spacing \_\_\_\_\_  
Drainfield rock below pipe \_\_\_\_\_  
Size of gravelless pipe \_\_\_\_\_  
Depth of backfill \_\_\_\_\_  
Absorption area: square feet \_\_\_\_\_  
lineal feet \_\_\_\_\_

**SEPTIC TANKS:** New  Existing \_\_\_\_\_  
Number of tanks installed 2 Jacobson Proline  
Liquid capacity and type 1825 Proline  
Type of baffle Plastic  
Inspection pipes manholes septic 2 @ 24" 1 @ 20"  
Manholes size LIFT 1-6" Insp 120"  
Manhole to grade Yes  No \_\_\_\_\_ Riser

**MOUNDS:**  
Percent slope 0  
Upslope sand width 12 2/6  
Downslope sand width 12 2/6  
Sideslope sand width 12 2/6  
Drainfield rock below pipe 9"  
Depth of sand below rock 18"  
Perforation size & spacing 1/4" x 3"  
Pipe size & spacing 2" x 3"  
Dimensions of rock bed 10' x 63'  
Dimensions of sand base 34' x 87'  
Final cover 18" sides 18" Top

**PUMPS:** New  Existing \_\_\_\_\_  
Tank capacity and type 1600 Proline  
Pump manufacturer & model # Liberty 283  
Horsepower & GPM .5 hp 42 gpm  
Feet of head 20'  
Gallons per cycle 188  
Size of discharge line 2"  
Type & location of alarm elec @ Tank  
Water meter \_\_\_\_\_

**DRAWING OF SYSTEM: (include soils)**

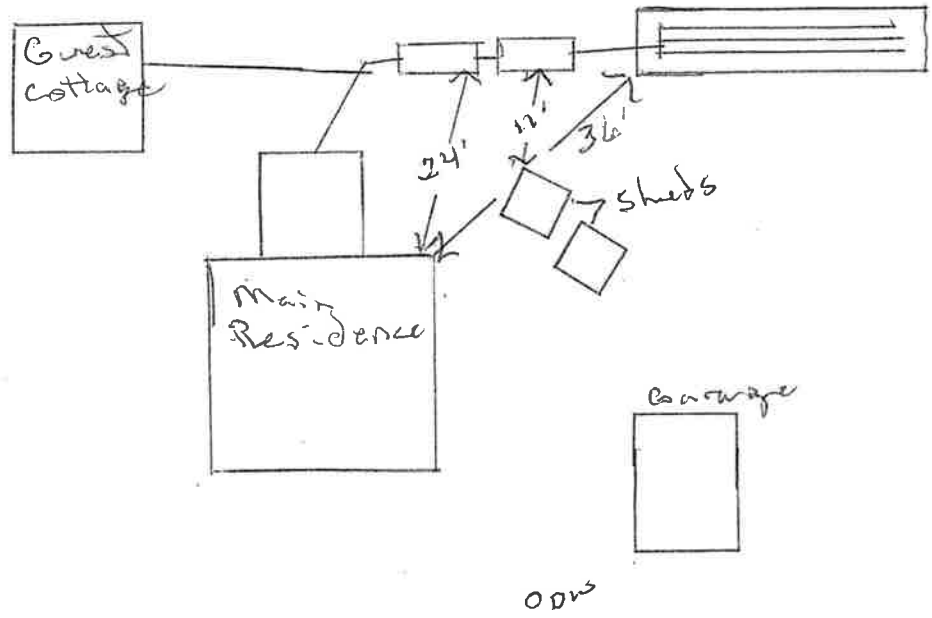

Inspector's Comments: \_\_\_\_\_

Inspector's Signature K. Durack Installer's Signature \_\_\_\_\_

**AITKIN COUNTY**  
**CERTIFICATE OF INSTALLATION/~~NOTICE OF NONCOMPLIANCE~~**

This certificate of installation/~~notice of noncompliance~~ has been issued this 14th day of July, 2023 to certify compliance/~~noncompliance~~ with Aitkin County's Subsurface Sewage Treatment System Ordinance.

The premises covered by this certificate are legally described as: S 114.50 ft of N 794.50 ft of Lot 3 E of Hwy 65

Section 18 Township 49 Range 23 Lake Big Sandy

PERMIT NO. 47780 Owner Name RASJ Landco LLC

Address 21720 497th Ln McGregor, Mn 55760

Installer Name Kohl's Concepts

Type of System Inspected 5 Bdrm Type I Mound

Parcel Number 29-0-037400

The certificate of installation/~~notice of noncompliance~~ was based on No 1 of the following:

- 1) Inspection of the installation or construction as in accordance with the above referenced permit and application design.
  
- 2) Review of as-built plans submitted in accordance with Subdivision 9.2 D of Aitkin County's Subsurface Sewage Treatment System Ordinance.

If the above permitted subsurface sewage treatment system is in noncompliance with Aitkin County's Subsurface Sewage Treatment System Ordinance, then the following shall serve as a Notice of Violation:

- 1) Statement of the findings of fact through inspections or investigations:

\_\_\_\_\_

- 2) List of specific violations of Ordinance: \_\_\_\_\_

\_\_\_\_\_

- 3) Requirements for correction or removal of violations: \_\_\_\_\_

\_\_\_\_\_

- 4) Time schedule for compliance: \_\_\_\_\_

Failure to correct or remove the above violation(s) will result in this matter being turned over to the Aitkin County Attorney's Office for further legal action, which may result in revocation of licenses, fines and/or imprisonment.

INSPECTOR SIGNATURE 