

SOILS CHARTS FOR BOTH PROPOSED AND ALTERNATE SITES

1 (PROPOSED) SOILS DATA

B1

DEPTH (INCHES)	TEXTURE	MUNSELL COLOR
0-8	T.S. Sandy Loam	7.5YR3/3
8-20	Sandy Loam friable no rocks	7.5YR4/3
21+	Reddish Stony	

2 (PROPOSED) SOILS DATA

B2

DEPTH (INCHES)	TEXTURE	MUNSELL COLOR
0-8	T.S. Sandy Loam	7.5YR3/3
8-22	Sandy Loam friable no rocks	7.5YR4/4
22+	Reddish Stony	

1 (ALTERNATE) SOILS DATA

ALT
SITE B3

DEPTH (INCHES)	TEXTURE	MUNSELL COLOR
0-8	T.S. Sandy Loam	7.5YR2.5/2
8-15	Sandy Loam Good Soil No Bedrock	7.5YR4/3

2 (ALTERNATE) SOILS DATA

B4

DEPTH (INCHES)	TEXTURE	MUNSELL COLOR
0-9	T.S. Sandy Loam	7.5YR2.5/2
9-15	Sandy Loam	7.5YR4/3

ADDITIONAL SOIL BORINGS MAY BE REQUIRED

Note: No Well on Property!

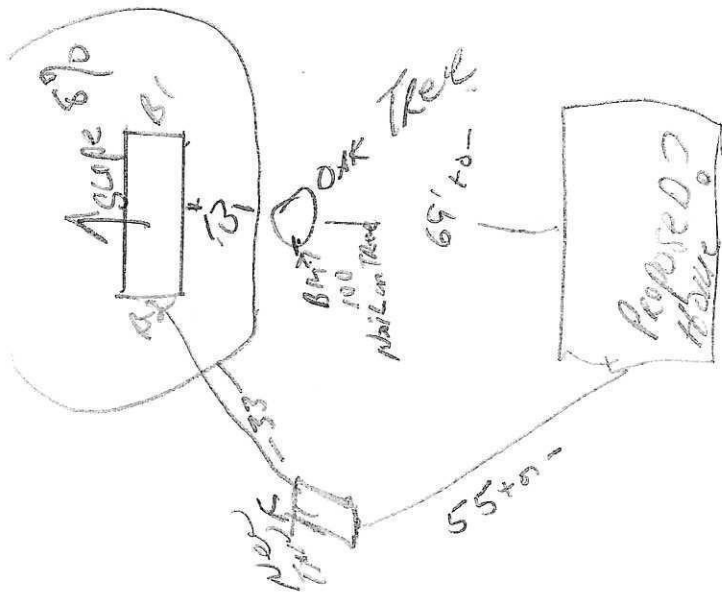

NORTH

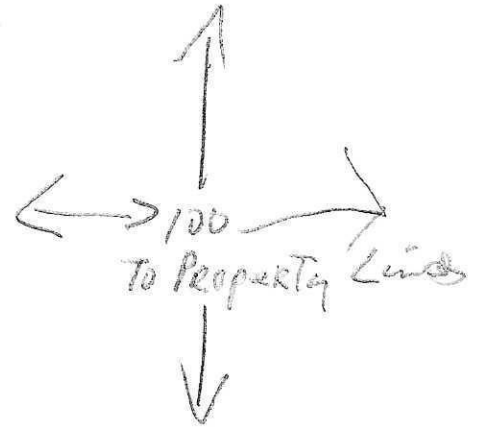

- 100 BM Nail in Oak Tree
- 95 G.L at Mound
- 97 G.L at Home
- 94 Projected line at Home
- 93 TANK Inlet
- 90.5 Pump ELV:
- 73.5 BORING Depth
- 96.5 SAND Night
- 97.4 Discharge Manifold
- 7.0 Pup Dis. Night.

Drain-culvert

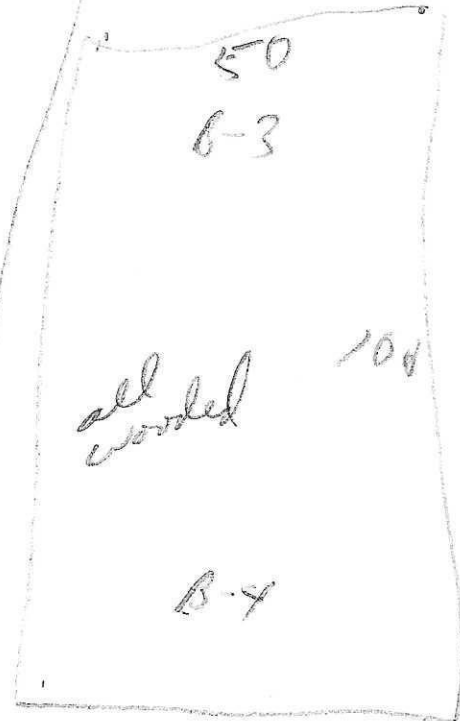

FIELD EDGE

Dave Lydell
 L 2006
 5/28/22