

Darlow ENT.
8-4-22
Heagle

JACOBSON PRECAST CONCRETE, LLC

TANK INSTALLATION INSTRUCTIONS

Model # 1650SP Date Built: 5/3/22 Gallons: 1650 Bury Depth 2 1/2'
#4
Model # _____ Date Built: _____ Gallons: _____ Bury Depth _____

SITE CONDITION:

The site must be accessible to large, heavy trucks. Free of items like trees, stumps, overhead wires, etc. That could interfere with delivery or installation and allows trucks to within 3 to 5 ft of placement excavation.

EXCAVATION:

Excavation should be approximately 12" minimum larger than tank size to allow for adequate back fill. This may vary with soil conditions. Excavation shall have a level bottom so the weight bears on the outside walls of the tank.

BEDDING:

Each tank should be placed on about 6" of proper bedding material leveled, and should be compacted to minimum 95% compaction if tested, to ensure the life of the tank structure. Bedding must be capable of bearing the weight of the tank. Bedding material shall have the ability of 100% to pass through a 1/2" screen.

WATER TABLE:

When tanks are being placed where water levels can potentially be higher than the elevation of the tank cover, an alternate location should be considered. If water table is high installer must also consider the tank may float, if this is a possibility tank must be tied down before backfilling.

BACKFILL MATERIAL:

Sidewall of tanks require dry backfill materials that have the ability of 100% to be able to pass through a 2" screen and a minimum of 12" on all sides from the bottom to top of tank. Backfill material shall be placed to avoid impact loads on sidewall of the tank.

COVER MATERIAL:

Cover material shall be dry soil, material that has the ability of 100% to be able to pass through a 2' screen. Cover material shall be mounded over tank and around risers to direct run-off away from both.

INLET & OUTLET:

Pipe not to exceed 1" past the interior wall of tank where a baffle is used.

BURIAL DEPTH: Tanks to be installed according to model's maximum bury recommendations:

AITKIN COUNTY
CERTIFICATE OF INSTALLATION/~~NOTICE OF NONCOMPLIANCE~~

This certificate of installation/~~notice of noncompliance~~ has been issued this 13th day of December, 2022 to certify compliance/~~noncompliance~~ with Aitkin County's Subsurface Sewage Treatment System Ordinance.

The premises covered by this certificate are legally described as: _____
Lots 19 thru 22 Indian Portage

Section 20 Township 49 Range 23 Lake _____
PERMIT NO. 47153 Owner Name Trevor Heagle
Address 48670 204th Ave McGregor, Mn 55760
Installer Name Darlow Excavating
Type of System Inspected 2 Bdrm Type I Mound
Parcel Number 29-1-077100

The certificate of installation/~~notice of noncompliance~~ was based on No 1 of the following:

- 1) Inspection of the installation or construction as in accordance with the above referenced permit and application design.

- 2) Review of as-built plans submitted in accordance with Subdivision 9.2 D of Aitkin County's Subsurface Sewage Treatment System Ordinance.

If the above permitted subsurface sewage treatment system is in noncompliance with Aitkin County's Subsurface Sewage Treatment System Ordinance, then the following shall serve as a Notice of Violation:

- 1) Statement of the findings of fact through inspections or investigations:

- 2) List of specific violations of Ordinance: _____

- 3) Requirements for correction or removal of violations: _____

- 4) Time schedule for compliance: _____

Failure to correct or remove the above violation(s) will result in this matter being turned over to the Aitkin County Attorney's Office for further legal action, which may result in revocation of licenses, fines and/or imprisonment.

INSPECTOR SIGNATURE _____



**SUBSURFACE SEWAGE TREATMENT SYSTEM INSPECTION FORM
AITKIN COUNTY, MINNESOTA**

Township Shamrock Date of Inspection 8-4-22 Initial ^{12-13-22 Final} App. Number 2022-009247

Owner Trevor Heagle Parcel Number 29-1-077100

Project Address 48676 204th Ave Installer Dashous

City McGregor Zip Code 55760

New Repair

SETBACKS:

Buildings to tank(s) 72'
Buildings to drainfield 105'
Well(s) 50' or 100' 110'
Lake/Creek/Wetland _____

SEPTIC TANKS: New Existing _____

Number of tanks installed 1 1150 Jacobson
Liquid capacity and type 1120 Permaid
Type of baffle Plastic
Inspection pipes _____
Manholes size 20 24 10 20
Manhole to grade Yes No _____

PUMPS: New Existing _____

Tank capacity and type 530 Paccard
Pump manufacturer & model # Goulds PE41
Horsepower & GPM 4 20 GPM
Feet of head 18
Gallons per cycle 90
Size of discharge line 1 1/2
Type & location of alarm Alarm @ Tank
Water meter _____

DIST. or DROP BOX & TYPE _____

TRENCHES, BEDS, OR GRAVELLESS LEACHFIELD:

Trench/Bed depth _____
Trench/Bed length _____
Trench/Bed bottom width _____
Trench spacing _____
Drainfield rock below pipe _____
Size of gravelless pipe _____
Depth of backfill _____
Absorption area: square feet _____
lineal feet _____

MOUNDS:

Percent slope 0
Upslope sand width 14
Downslope sand width 14
Sideslope sand width 14
Drainfield rock below pipe 9
Depth of sand below rock 2'
Perforation size & spacing 1/4 X 3
Pipe size & spacing 1 1/2 X 3
Dimensions of rock bed 10 X 25
Dimensions of sand base 38 X 53
Final cover 18" T 12" S

DRAWING OF SYSTEM: (include soils)

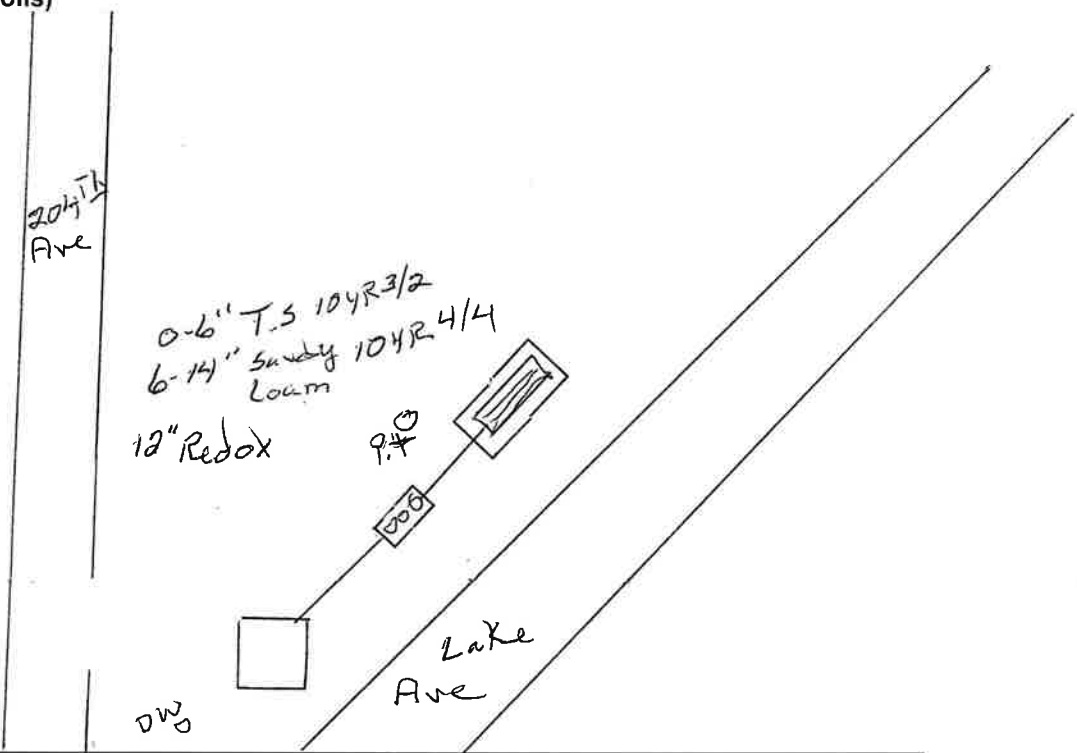

Inspector's Comments: _____

Inspector's Signature [Signature] Installer's Signature _____