



Minnesota Pollution Control Agency

520 Lafayette Road North
St. Paul, MN 55155-4194

Compliance Inspection Form
Existing Subsurface Sewage Treatment Systems (SSTS)

Doc Type: Compliance and Enforcement

Inspection results based on Minnesota Pollution Control Agency (MPCA) requirements and attached forms - additional local requirements may also apply.

Submit completed form to Local Unit of Government (LUG) and system owner within 15 days

For local tracking purposes:

System Status

System status on date (mm/dd/yyyy): 07/10/2019

[X] Compliant - Certificate of Compliance

(Valid for 3 years from report date, unless shorter time frame outlined in Local Ordinance.)

[] Noncompliant - Notice of Noncompliance
(See Upgrade Requirements on page 3.)

Reason(s) for noncompliance (check all applicable)

- [] Impact on Public Health (Compliance Component #1) - Imminent threat to public health and safety
[] Other Compliance Conditions (Compliance Component #3) - Imminent threat to public health and safety
[] Tank Integrity (Compliance Component #2) - Failing to protect groundwater
[] Other Compliance Conditions (Compliance Component #3) - Failing to protect groundwater
[] Soil Separation (Compliance Component #4) - Failing to protect groundwater
[] Operating permit/monitoring plan requirements (Compliance Component #5) - Noncompliant

Property Information

Property address: 22730 180th St. Parcel ID# or Sec/Twp/Range: 38-0-006501
Property owner: DENNIS & BONNIE ITHAMAKI Reason for inspection: Sale
Owner's representative: Representative phone: 218-927-7347
Local regulatory authority: ATKIN ZOENING Regulatory authority phone: 218-927-7347
Brief system description: GRAVITY TO TANK PSE LIFT TANK TO MOUND
Comments or recommendations:

Certification

I hereby certify that all the necessary information has been gathered to determine the compliance status of this system. No determination of future system performance has been nor can be made due to unknown conditions during system construction, possible abuse of the system, inadequate maintenance, or future water usage.

Inspector name: DAVE ENGDAHL Certification number: C4869
Business name: DAVE'S DIRT WORK License number: L2006
Inspector signature: Dave Engdahl Phone number: 572-3606

Necessary or Locally Required Attachments

- [X] Soil boring logs [X] System/As-built drawing [] Forms per local ordinance
[] Other information (list):

Property address: 22730 180th ST.

Inspector initials/Date: [Signature] 10/7/10/2019
(mm/dd/yyyy)

1. Impact on Public Health – Compliance component #1 of 5

Compliance criteria:

System discharges sewage to the ground surface.	<input type="checkbox"/> Yes <input checked="" type="checkbox"/> No
System discharges sewage to drain tile or surface waters.	<input type="checkbox"/> Yes <input checked="" type="checkbox"/> No
System causes sewage backup into dwelling or establishment.	<input type="checkbox"/> Yes <input checked="" type="checkbox"/> No

Any "yes" answer above indicates the system is an imminent threat to public health and safety.

Comments/Explanation:

Verification method(s):

- Searched for surface outlet
- Searched for seeping in yard/backup in home
- Excessive ponding in soil system/D-boxes
- Homeowner testimony (See Comments/Explanation)
- "Black soil" above soil dispersal system
- System requires "emergency" pumping
- Performed dye test
- Unable to verify (See Comments/Explanation)
- Other methods not listed (See Comments/Explanation)

2. Tank Integrity – Compliance component #2 of 5

Compliance criteria:

System consists of a seepage pit, cesspool, drywell, or leaching pit. <i>Seepage pits meeting 7080.2550 may be compliant if allowed in local ordinance.</i>	<input type="checkbox"/> Yes <input checked="" type="checkbox"/> No
Sewage tank(s) leak below their designed operating depth. If yes, which sewage tank(s) leaks:	<input type="checkbox"/> Yes <input checked="" type="checkbox"/> No

Any "yes" answer above indicates the system is failing to protect groundwater.

Comments/Explanation:

Verification method(s):

- Probed tank(s) bottom
- Examined construction records
- Examined Tank Integrity Form (Attach)
- Observed liquid level below operating depth
- Examined empty (pumped) tanks(s)
- Probed outside tank(s) for "black soil"
- Unable to verify (See Comments/Explanation)
- Other methods not listed (See Comments/Explanation)

3. Other Compliance Conditions – Compliance component #3 of 5

- a Maintenance hole covers are damaged, cracked, unsecured, or appear to be structurally unsound. Yes* No Unknown
- b Other issues (electrical hazards, etc.) to immediately and adversely impact public health or safety. Yes* No Unknown
*System is an imminent threat to public health and safety.

Explain:

- c. System is non-protective of ground water for other conditions as determined by inspector. Yes* No
*System is failing to protect groundwater.

Explain:

Property address: 22730 180th ST

Inspector initials/Date: [Signature] 07/10/2019
(mm/dd/yyyy)

4. Soil Separation – Compliance component #4 of 5

Date of installation: 08/04/2003 Unknown
(mm/dd/yyyy)

Shoreland/Wellhead protection/Food beverage lodging? Yes No

Compliance criteria:

For systems built prior to April 1, 1996, and not located in Shoreland or Wellhead Protection Area or not serving a food, beverage or lodging establishment: Yes No
Drainfield has at least a two-foot vertical separation distance from periodically saturated soil or bedrock.

Non-performance systems built April 1, 1996, or later or for non-performance systems located in Shoreland or Wellhead Protection Areas or serving a food, beverage, or lodging establishment: Yes No
Drainfield has a three-foot vertical separation distance from periodically saturated soil or bedrock.*

"Experimental", "Other", or "Performance" systems built under pre-2008 Rules; Type IV or V systems built under 2008 Rules (7080.2350 or 7080.2400 (Advanced Inspector License required)) Yes No
Drainfield meets the designed vertical separation distance from periodically saturated soil or bedrock.

Verification method(s):

Soil observation does not expire. Previous soil observations by two independent parties are sufficient, unless site conditions have been altered or local requirements differ.

- Conducted soil observation(s) (Attach boring logs)
- Two previous verifications (Attach boring logs)
- Not applicable (Holding tank(s), no drainfield)
- Unable to verify (See Comments/Explanation)
- Other (See Comments/Explanation)

Comments/Explanation:

Indicate depths or elevations

A. Bottom of distribution media	100
B. Periodically saturated soil/bedrock	97
C. System separation	3
D. Required compliance separation*	3

*May be reduced up to 15 percent if allowed by Local Ordinance.

Any "no" answer above indicates the system is failing to protect groundwater.

5. Operating Permit and Nitrogen BMP* – Compliance component #5 of 5 Not applicable

Is the system operated under an Operating Permit? Yes No If "yes", A below is required

Is the system required to employ a Nitrogen BMP? Yes No If "yes", B below is required

BMP = Best Management Practice(s) specified in the system design

If the answer to both questions is "no", this section does not need to be completed.

Compliance criteria

a. Operating Permit number: _____ Yes No
Have the Operating Permit requirements been met?

b. Is the required nitrogen BMP in place and properly functioning? Yes No

Any "no" answer indicates Noncompliance.

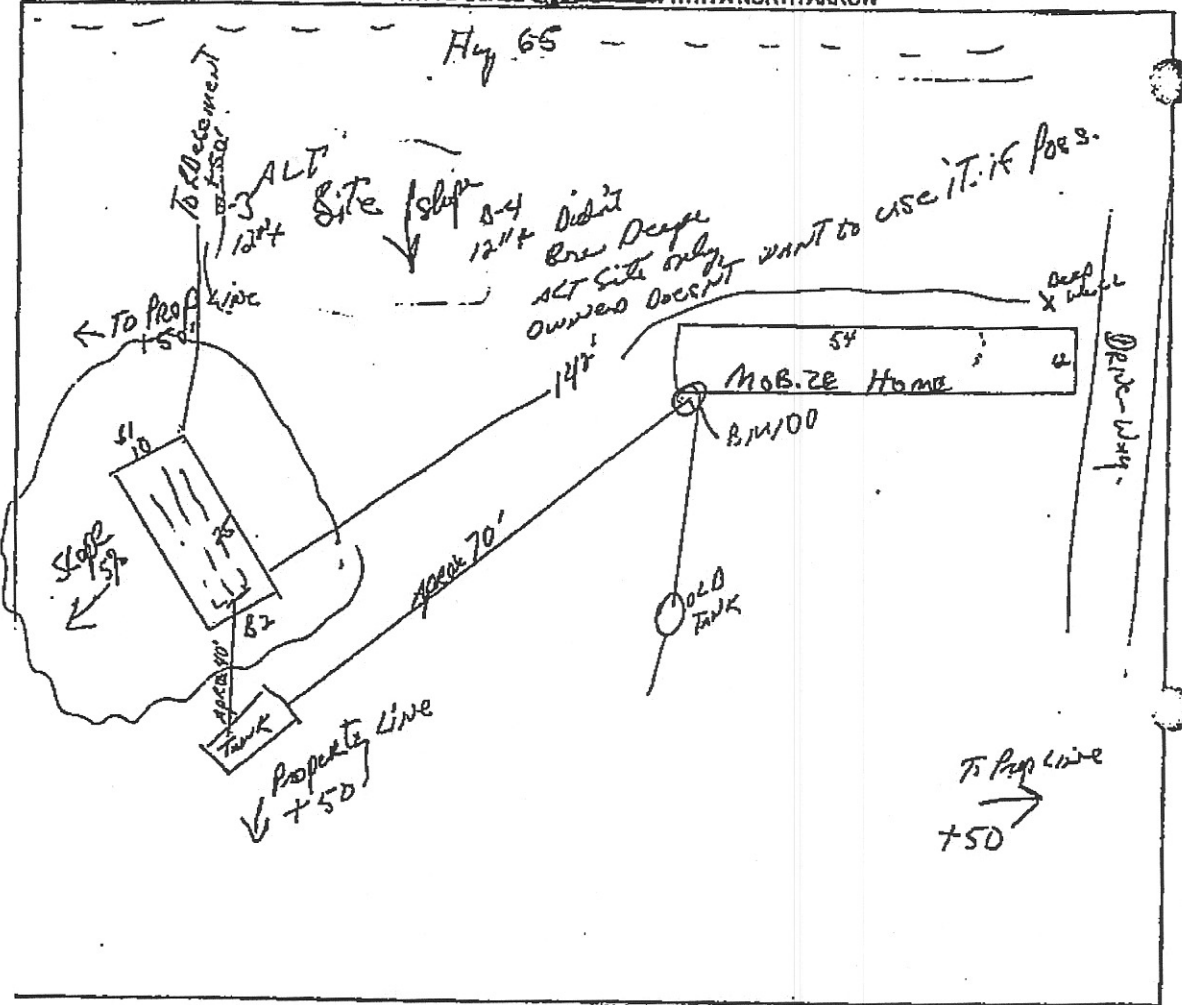

CHECK OFF LIST - HAVE ALL OF THE FOLLOWING BEEN DRAWN ON THE MAP??

- HOW EXISTING OR PROPOSED
- WATER WELLS WITHIN 100 FT OF TREATMENT AREAS
 - PRESSURE WATER LINES WITHIN 10 FT OF TREATMENT AREAS
 - STRUCTURES
 - ALL SOIL TREATMENT AREAS
 - HORIZONTAL AND VERTICAL REFERENCE
 - POINT OF SOIL BORINGS
 - LOT EASEMENTS
 - DISTURBED/COMPACTED AREAS
 - SITE PROTECTION - LATHE AND RIBBON EVERY 15 FT
 - ACCESS ROUTE FOR TANK MAINTENANCE
 - EQUIURED SETBACKS
 - STRUCTURES
 - OTHER
 - COMMENTS:

- LOT IMPROVEMENTS
- ALL 15TS COMPONENTS
- DIRECTION OF SLOPE
- ALL LOT DIMENSIONS
- PROPERTY LINES

INDICATE ELEVATIONS

- 100 BENCHMARK G.L. AT MOBILE HOME
- 99 ELEVATION OF SEWER LINE @ HOUSE
- 96 ELEVATION @ TANK INLET
- 102 ELEVATION @ BOTTOM OF ROCK LAYER
- 99 ELEVATION @ BOTTOM OF BORING OR RESTRICTIVE LAYER
- 93.5 ELEVATION OF PUMP
- 103 ELEVATION OF DISTRIBUTION DEVICE

DESIGNER SIGNATURE *Paul Engvall*
 CENSE# 2006

DATE 8/2/07

B-1 0-5 T.S. Sand Com 7.54 R 3/2
 B-2 0-4 T.S. Sand Com 7.54 R 3/2
 4-8 Sand Com 7.54 R 4/3
 7-12 Sand Com 7.54 R 4/4
 8-12 Sand Com 7.54 R 4/4

Relief 13" +
Engvall 7/1/2019
 2006

Relief 13" +