

**AITKIN COUNTY**  
**CERTIFICATE OF INSTALLATION/~~NOTICE OF NONCOMPLIANCE~~**

This certificate of installation/~~notice of noncompliance~~ has been issued this \_\_\_\_\_ day of \_\_\_\_\_, 20\_\_\_\_ to certify compliance/~~noncompliance~~ with Aitkin County's Subsurface Sewage Treatment System Ordinance.

The premises covered by this certificate are legally described as: \_\_\_\_\_  
\_\_\_\_\_  
\_\_\_\_\_

Section \_\_\_\_\_ Township \_\_\_\_\_ Range \_\_\_\_\_ Lake \_\_\_\_\_  
PERMIT NO. \_\_\_\_\_ Owner Name \_\_\_\_\_  
Address \_\_\_\_\_  
Installer Name \_\_\_\_\_  
Type of System Inspected \_\_\_\_\_  
Parcel Number \_\_\_\_\_

The certificate of installation/~~notice of noncompliance~~ was based on No \_\_\_ of the following:

- 1) Inspection of the installation or construction as in accordance with the above referenced permit and application design.
  
- 2) Review of as-built plans submitted in accordance with Subdivision 9.2 D of Aitkin County's Subsurface Sewage Treatment System Ordinance.

If the above permitted subsurface sewage treatment system is in noncompliance with Aitkin County's Subsurface Sewage Treatment System Ordinance, then the following shall serve as a Notice of Violation:

- 1) Statement of the findings of fact through inspections or investigations:  
\_\_\_\_\_  
\_\_\_\_\_

- 2) List of specific violations of Ordinance: \_\_\_\_\_  
\_\_\_\_\_  
\_\_\_\_\_

- 3) Requirements for correction or removal of violations: \_\_\_\_\_  
\_\_\_\_\_  
\_\_\_\_\_

- 4) Time schedule for compliance: \_\_\_\_\_  
\_\_\_\_\_

Failure to correct or remove the above violation(s) will result in this matter being turned over to the Aitkin County Attorney's Office for further legal action, which may result in revocation of licenses or registrations, fines and/or imprisonment.

INSPECTOR SIGNATURE \_\_\_\_\_

**SUBSURFACE SEWAGE TREATMENT SYSTEM INSPECTION FORM  
AITKIN COUNTY, MINNESOTA**

Township Shamrock Date of Inspection 9/12/2022 App. Number 46926 2022-8787

Owner Kenneth + Catherine Chlan Parcel Number 29-1-292700

Project Address 18668 470<sup>th</sup> Ln. Installer Jerry Farley

City McGregor Zip Code 55760 T2 HT

New  Repair

DIST. or DROP BOX & TYPE \_\_\_\_\_

**SETBACKS:**  
Buildings to tank(s) 11'  
Buildings to drainfield -  
Well(s) 50' or 100' SW:50'  
Lake/Creek/Wetland -

**TRENCHES, BEDS, OR GRAVELLESS LEACHFIELD:**  
Trench/Bed depth \_\_\_\_\_  
Trench/Bed length \_\_\_\_\_  
Trench/Bed bottom width \_\_\_\_\_  
Trench spacing \_\_\_\_\_  
Drainfield rock below pipe \_\_\_\_\_  
Size of gravelless pipe \_\_\_\_\_  
Depth of backfill \_\_\_\_\_  
Absorption area: square feet \_\_\_\_\_  
lineal feet \_\_\_\_\_

**SEPTIC TANKS:** New  Existing   
Number of tanks installed 1  
Liquid capacity and type 1820 Jac. Combo  
Type of baffle Plastic  
Inspection pipes -  
Manholes size 24"  
Manhole to grade Yes  No

**MOUNDS:**  
Percent slope \_\_\_\_\_  
Upslope sand width \_\_\_\_\_  
Downslope sand width \_\_\_\_\_  
Sideslope sand width \_\_\_\_\_  
Drainfield rock below pipe \_\_\_\_\_  
Depth of sand below rock \_\_\_\_\_  
Perforation size & spacing \_\_\_\_\_  
Pipe size & spacing \_\_\_\_\_  
Dimensions of rock bed \_\_\_\_\_  
Dimensions of sand base \_\_\_\_\_  
Final cover \_\_\_\_\_

**PUMPS:** New  Existing   
Tank capacity and type \_\_\_\_\_  
Pump manufacturer & model # \_\_\_\_\_  
Horsepower & GPM \_\_\_\_\_  
Feet of head \_\_\_\_\_  
Gallons per cycle \_\_\_\_\_  
Size of discharge line \_\_\_\_\_  
Type & location of alarm Manual Pop-up  
Water meter -

**DRAWING OF SYSTEM: (include soils)**

Inspector's Comments: \_\_\_\_\_

Inspector's Signature Bryan Hargrave Installer's Signature \_\_\_\_\_

# Aitkin County { Holding Tank Design }

Property Owner: Kenny Chlan      Date: 5/6/22      Designer's Initials: JB  
 One Inch = 40 ft.

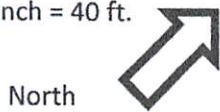

*One Inch = 40 ft.*

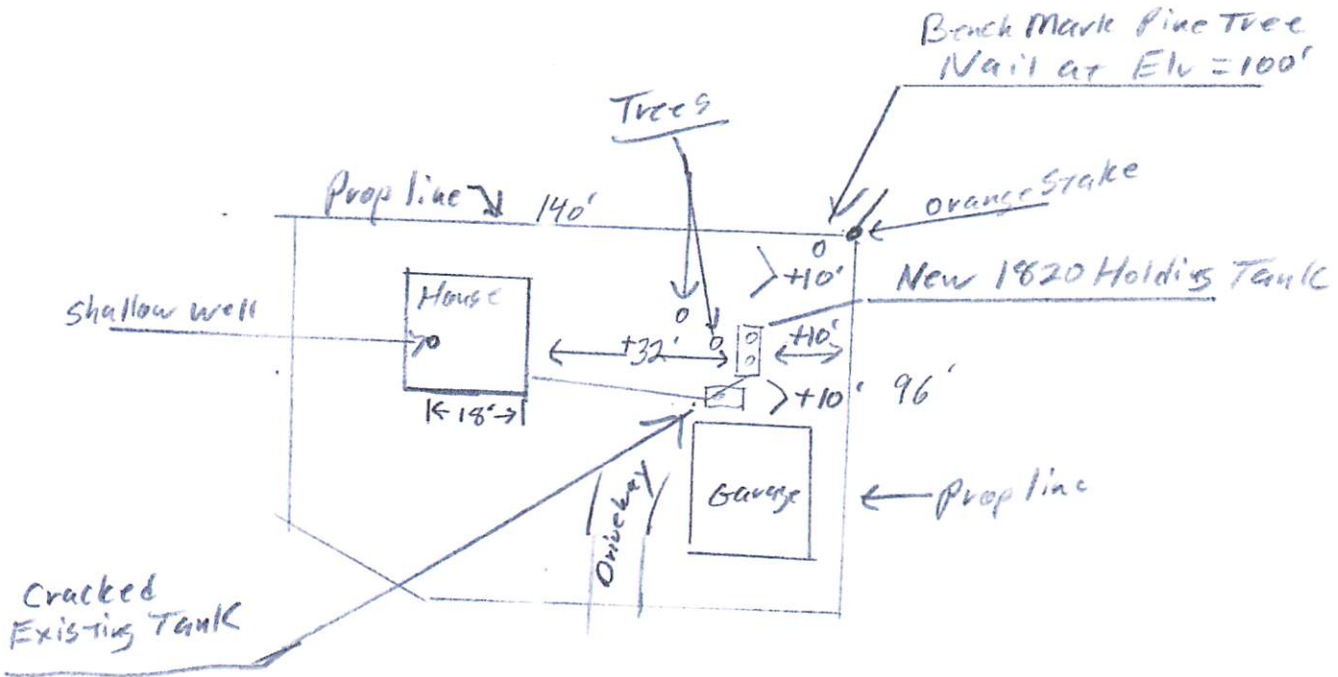

Please show all that apply ( Existing or Proposed ):      Please Draw to Scale with North to Top or Left Side of Page:

- Wells within 100ft. Of Drain field.
- Water lines within 10 ft. of Drain field.
- Drain field Areas:

- Disturbed/Compacted Areas
- Component Location
- OHW ordinary high water
- Lot Easements

- Access Route for Tank Maintenance
- Property Lines
- Structures
- Setbacks

<b>Elevations :</b>	Benchmark Elevation:	Elv.= 100' Nail on Pine Tree near NE lot corner
Existing tank grade Elv.= 99'		Existing Grade at house Elv. = 98.6'
Existing tank inlet Elv.= 96.6'		Estimated sewer pipe at house Elv.= 97'
New Tank Grade Elv. = 99'		Grade at Orange NE corner stake Elv.= 99.6'
Estimated New Tank Inlet Elv. = 96.5'		







