

**FIELD EVALUATION SHEET**

PRELIMINARY EVALUATION DATE 10-7-21, FIELD EVALUATION DATE 10-7-21  
PROPERTY OWNER: Adan Davis New Owner PHONE \_\_\_\_\_  
ADDRESS: 31417 359th Lane CITY, STATE, ZIP: A. 7th 56431  
LEGAL DESCRIPTION: SW-SE  
PIN# 15-0-036700 SEC 21 T 47 R 23 TWP NAME Kimberly Jwp  
FIRE# \_\_\_\_\_ LAKE/RIVER N/A LAKE CLASS N/A OIWL \_\_\_\_\_ FT.

**DESCRIPTION OF SOIL TREATMENT AREAS**

	AREA #1	AREA #2	REFERENCE BM ELEV. <u>160"</u> FT.
DISTURBED AREAS	YES _____ NO <u>X</u>	YES _____ NO _____	REFERENCE BM DESCRIPTION _____
COMPACTED AREAS	YES _____ NO <u>X</u>	YES _____ NO _____	<u>cap on tank Existing</u>
FLOODING	YES _____ NO <u>X</u>	YES _____ NO _____	_____
RUN ON POTENTIAL	YES _____ NO <u>X</u>	YES _____ NO _____	_____
SLOPE %	<u>0</u>	_____	_____
DIRECTION OF SLOPE	<u>0</u>	_____	_____
LANDSCAPE POSITION	<u>Level yard</u>	_____	_____
VEGETATION TYPES	<u>grass</u>	_____	_____

DEPTH TO STANDING WATER OR MOTTLED SOIL: BORING# 1 18", 1A \_\_\_\_\_, 2 \_\_\_\_\_, 2A \_\_\_\_\_

BOTTOM ELEVATION--FIRST TRENCH OR BOTTOM OF ROCK BED: #1 18" Sand Base #2 \_\_\_\_\_ FT.

SOIL SIZING FACTOR: SITE #1 1.27, SITE #2 \_\_\_\_\_

CONSTRUCTION RELATED ISSUES: 10x 38" Rock Bed on 18" Sand Base

LIC# 2028 SITE EVALUATOR SIGNATURE: Bob Bartel

SITE EVALUATOR NAME: Bob Bartel TELEPHONE# 218-831-6430

LUG REVIEW \_\_\_\_\_ DATE \_\_\_\_\_

Comments: \_\_\_\_\_  
\_\_\_\_\_  
\_\_\_\_\_

**SOIL BORING LOGS ON REVERSE SIDE**

15-0-36760

# SOILS CHARTS FOR BOTH PROPOSED AND ALTERNATE SITES

1 (PROPOSED) SOILS DATA

DEPTH (INCHES)	TEXTURE	MUNSELL COLOR
4"	Topsoil	10p 3/3
18"	Lo-snd	10p 4/4
	2 mat 1/3	7.5p 4/2
	Lo -	

2 (PROPOSED) SOILS DATA

DEPTH (INCHES)	TEXTURE	MUNSELL COLOR
-------------------	---------	------------------

1 (ALTERNATE) SOILS DATA

DEPTH (INCHES)	TEXTURE	MUNSELL COLOR
-------------------	---------	------------------

2 (ALTERNATE) SOILS DATA

DEPTH (INCHES)	TEXTURE	MUNSELL COLOR
-------------------	---------	------------------

ADDITIONAL SOIL BORINGS MAY BE REQUIRED

# MOUND DESIGN WORK SHEET (For Flows up to 1200 gpd)

## A. Average Design FLOW

15-0286700

Estimated 450 gpd (see figure A-1)  
 or measured \_\_\_\_\_ x 1.5 (safety factor) = \_\_\_\_\_ gpd

A-1: Estimated Sewage Flows in Gallons per Day

number of bedrooms	Class I	Class II	Class III	Class IV
2	300	225	180	60%
3	450	300	218	of the
4	600	375	256	values
5	750	450	294	in the
6	900	525	332	Class I,
7	1050	600	370	II, or III
8	1200	675	408	columns.

## B. SEPTIC TANK Capacity

1500 Existing and compliant gallons (see figure C-1)

C-1: Septic Tank Capacities (in gallons)

Number of Bedrooms	Minimum Liquid Capacity	Liquid capacity with garbage disposal	Liquid capacity with disposal & lift inside
2 or less	750	1125	1500
3 or 4	1000	1500	2000
5 or 6	1500	2250	3000
7, 8 or 9	2000	3000	4000

## C. SOILS (refer to site evaluation)

- Depth to restricting layer = 18" feet
- Depth of percolation tests = \_\_\_\_\_ feet
- Texture Sdy lo-  
Percolation rate \_\_\_\_\_ mpi
- Soil loading rate \_\_\_\_\_ gpd/sqft (see figure D-33)
- Percent land slope 0 %

## D. ROCK LAYER DIMENSIONS

- Multiply average design flow (A) by 0.83 to obtain required rock layer area.  
450 gpd x 0.83 sqft/gpd = 380 sqft
- Determine rock layer width = 0.83 sqft/gpd x linear Loading Rate (LLR)  
0.83 sqft/gpd x \_\_\_\_\_ gpd/sqft = \_\_\_\_\_ ft
- Length of rock layer = area ÷ width =  
380 sqft (D1) ÷ 10 ft (D2) = 38 ft

Mound LLR

< 120 MPI ≤ 12  
 ≥ 120 MPI ≤ 6

## E. ROCK VOLUME

- Multiply rock area (D1) by rock depth of 1 ft to get cubic feet of rock  
380 sqft x 1 ft = 380 cuft
- Divide cuft by 27 cuft/cuyd to get cubic yards  
380 cuft ÷ 27 cuyd/cuft = 15 cuyd
- Multiply cubic yards by 1.4 to get weight of rock in tons  
15 cuyd x 1.4 ton/cuyd = 20 tons

## F. SEWAGE ABSORPTION WIDTH

Absorption width equals absorption ratio (See Figure D-33) times rock layer width (D2)

1.50 x 10 ft = 15 ft

D-33: Absorption Width Sizing Table

Percolation Rate in Minutes per Inch (MPI)	Soil Texture	Loading Rate Gallons per day per square foot	Absorption Ratio
Faster than 5	Coarse Sand Medium Sand Loamy Sand Fine Sand	1.20	1.00
6 to 15	Sandy Loam	0.79	1.50
16 to 30	Loam	0.60	2.00
31 to 45	Silt Loam	0.50	2.40
46 to 60	Silt Silty Clay Loam	0.45	2.67
61 to 120	Silty Clay Loam Clay Loam Silty Clay Sandy Clay Clay	0.24	5.00
Slower than 120*			

\*System designed for these soils must be either of performance

G. Mound Slope Width and Length  
(landslope less than or equal to 1%)

<=1% land slope  
15-0-036700

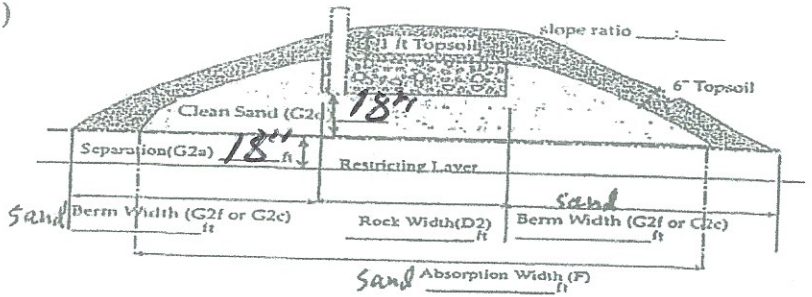

1. Absorption width (F) 15 ft

2. Calculate mound size

a. Determine depth of clean sand fill

at upslope edge of rock layer = 3 ft

minus the distance to restricting layer (C1)

3 ft - 18 ft = 18' ft

b. Mound height at the upslope edge of rock

layer = depth of clean sand for separation (G2a)

at upslope edge plus depth of rock layer (1 ft) plus depth of cover (1 ft)

1.5 ft + 1ft + 1ft = 3.5 ft

c. Berm width = upslope mound height (G2b) times 4 (4 is recommended, but could be 3-12)

3.5 x 3 = 10.5 ft

d. The total landscape width is the sum of berm (G2c) width plus rock layer width (D2) plus berm width (G2c): 10.5 ft + 10 ft + 10.5 ft = 31 ft

e. Additional width necessary for absorption = absorption width (F) minus the landscape width (G2d)

15 ft - 31 ft = -16 ft, if number is negative (<0) skip to g

f. Final berm width = additional width (G2e) plus the berm width (G2c)

10.5 ft + \_\_\_\_\_ ft = \_\_\_\_\_ ft

g. Total mound width is the sum of berm width (G2f or G2c) plus rock layer width (D2) plus berm width (G2f or G2c): 10.5 ft + 10 ft + 10.5 ft = 31 ft

h. Total mound length is the sum of berm (G2f or G2c) plus rock layer length (D3) plus berm (G2f or G2c): 10.5 ft + 38 ft + 10.5 ft = 59 ft

i. Setbacks from the rockbed are calculated as follows: the absorption width (F) minus the rock bed width (D2) divided by 2: (15 ft - 10 ft) ÷ 2 = 2.5 ft

**Final Dimensions:**  
31 x 59

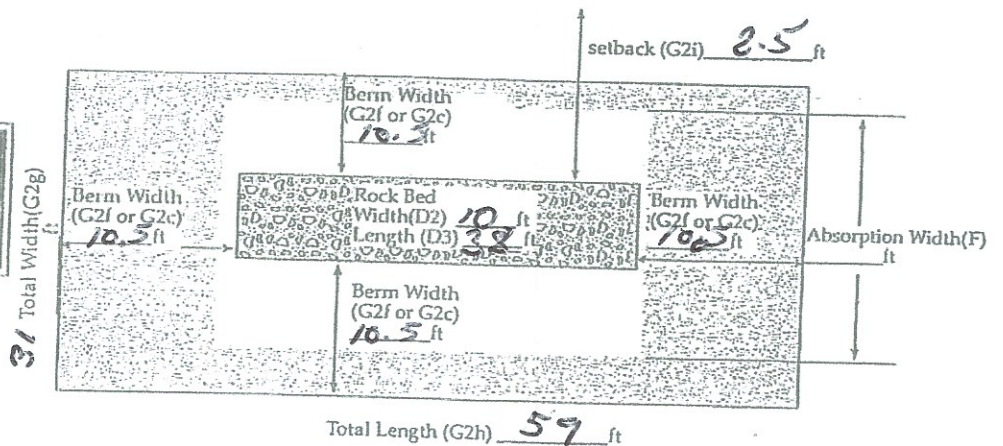

I hereby certify that I have completed this work in accordance with applicable ordinances, rules and laws.

Bob Bantl (signature)

(signature)

2088 (license #)

(license #)

10-9-21 (date)

(date)

**PRESSURE DISTRIBUTION SYSTEM**

15-0-036700

Geotextile fabric

- Select number of perforated laterals 3
- Select perforation spacing = 3 ft
- Since perforations should not be placed closer than 1 foot to the edge of the rock layer (see diagram), subtract 2 feet from the rock layer length.

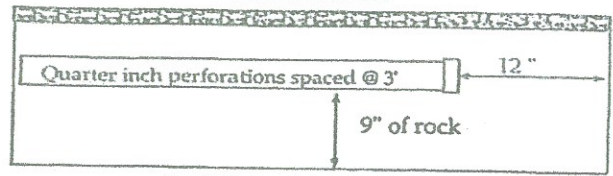

Perf Sizing 3/16" - 1/4"  
Perf Spacing 1.5' - 5'

$$\frac{380}{\text{Rock layer length}} - 2 \text{ ft} = 36 \text{ ft}$$

E-4: Maximum allowable number of 1/4-inch perforations per lateral to guarantee <10% discharge variation

perforation spacing (feet)	1 inch	1.25 inch	1.5 inch	2.0 inch
2.5	8	14	18	28
3.0	8	13	17	26
3.3	7	12	16	25
4.0	7	11	15	23
5.0	6	10	14	22

- Determine the number of spaces between perforations. Divide the length (3) by perforation spacing (2) and round down to nearest whole number.

Perforation spacing = 36 ft ÷ 3 ft = 12 spaces

- Number of perforations is equal to one plus the number of perforation spaces(4). Check figure E-4 to assure the number of perforations per lateral guarantees <10% discharge variation.

12 spaces + 1 = 13 perforations/lateral

- A. Total number of perforations = perforations per lateral (5) times number of laterals (1)

13 perfs/lat x 3 lat = 39 perforations

- B. Calculate the square footage per perforation. Should be 6-10 sqft/perf. Does not apply to at-grades.

Rock bed area = rock width (ft) x rock length (ft)

10 ft x 38 ft = 380 sqft

Square foot per perforation = Rock bed area ÷ number of perfs (6)

380 sqft ÷ 39 perfs = 9.7 sqft/perf

E-6: Perforation Discharge in gpm

head (feet)	perforation diameter (inches)			
	1/8	3/16	7/32	1/4
1.0 <sup>a</sup>	0.18	0.42	0.56	0.74
2.0 <sup>b</sup>	0.26	0.59	0.80	1.04
5.0	0.41	0.94	1.26	1.65

<sup>a</sup> Use 1.0 foot for single-family homes.  
<sup>b</sup> Use 2.0 feet for anything else.

- Determine required flow rate by multiplying the total number of perforations (6A) by flow per perforation (see figure E-6)

39 perfs x .74 gpm/perfs = 29 gpm

- If laterals are connected to header pipe as shown on upper example, to select minimum required lateral diameter; enter figure E-4 with perforation spacing (2) and number of perforations per lateral (5) Select minimum diameter for perforated lateral = 2 inches.

- If perforated lateral system is attached to manifold pipe near the center, lower diagram, perforated lateral length (3) and number of perforations per lateral (5) will be approximately one half of that in step 8. Using these values, select minimum diameter for perforated lateral = \_\_\_\_\_ inches.

MANIFOLD LOCATED AT END OF PRESSURE DISTRIBUTION SYSTEM

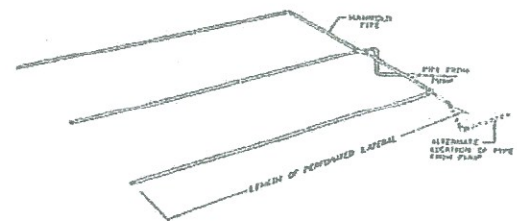

LAYOUT OF PERFORATED PIPE LATERALS FOR PRESSURE DISTRIBUTION IN MOUND

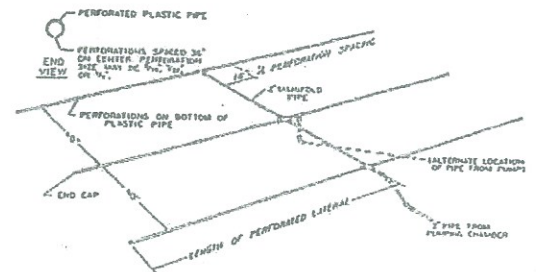

I hereby certify that I have completed this work in accordance with applicable ordinances, rules and laws.

Bob Bault (signature)

(signature)

2088 (license #)

(license #)

10.9.21 (date)

(date)

# PUMP SELECTION PROCEDURE

15-0-036700

## 1. Determine pump capacity:

### A. Gravity distribution

1. Minimum required discharge is 10 gpm
2. Maximum suggested discharge is 45 gpm. For other establishments at least 10% greater than the water supply rate, but no faster than the rate at which effluent will flow out of the distribution device.

### B. Pressure distribution

See pressure distribution work sheet

From A or B Selected pump capacity: 29 gpm

## 2. Determine pump head requirements:

### A. Elevation difference between pump and point of discharge?

5 feet

### B. Special head requirement? (See Figure at right - Special Head Requirements)

5 feet

### C. Calculate Friction loss

1. Select pipe diameter 2 in

2. Enter Figure E-9 with gpm (1A or B) and pipe diameter (C1).

Read friction loss in feet per 100 feet from Figure E-9

Friction Loss = 1.55 ft/100ft of pipe

3. Determine total pipe length from pump discharge to soil treatment discharge point. Estimate by adding 25 percent to pipe length for fitting loss. Total pipe length times 1.25 = equivalent pipe length

25 feet x 1.25 = 31.2 feet

4. Calculate total friction loss by multiplying friction loss (C2) in ft/100 ft by the equivalent pipe length (C3) and divide by 100.

= 1.55 ft/100ft x 31.2 ÷ 100 = .5 ft

### D. Total head required is the sum of elevation difference (A), special head requirements (B), and total friction loss (C4)

5 ft + 5 ft + .5 ft =

Total head: 10.5 feet

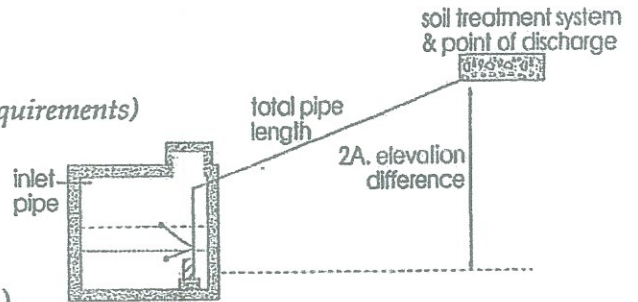

Special Head Requirements	
Gravity Distribution	0 ft
Pressure Distribution	5 ft

flow rate gpm	E-9: Friction Loss in Plastic Pipe Per 100 feet		
	nominal pipe diameter		
	1.5"	2"	3"
20	2.47	0.73	0.11
25	3.73	1.11	0.16
30	5.23	1.55	0.23
35	6.96	2.06	0.30
40	8.91	2.64	0.39
45	11.07	3.28	0.48
50	13.46	3.99	0.58
55		4.76	0.70
60		5.60	0.82
65		6.48	0.95
70		7.44	1.09

## 3. Pump selection

A pump must be selected to deliver at least 29 gpm (1A or B) with at least 10.5 feet of total head (2D)

I hereby certify that I have completed this work in accordance with applicable ordinances, rules and laws.

Bob Burt (signature)

(signature)

2088 (license #)

(license #)

10-9-21 (date)

(date)

# DOSING CHAMBER SIZING

15-0-036700

1. Determine area

A. Rectangle area =  $L \times W$   
 $\underline{\hspace{2cm}} \times \underline{\hspace{2cm}} = \underline{\hspace{2cm}}$  square feet

B. Circle area =  $\pi (3.14) \times \text{radius in feet} \times \text{radius in feet}$   
 $3.14 \times \underline{\hspace{2cm}} \text{ ft} \times \underline{\hspace{2cm}} \text{ ft} = \underline{\hspace{2cm}}$  sqft

C. Get area from manufacturer  $\underline{\hspace{2cm}}$  sqft

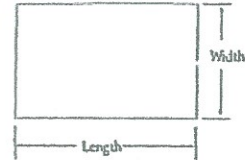

2. Calculate gallons per inch

There are 7.5 gallons per cubic foot of volume, therefore multiply the area (1A, B or C) times the conversion factor and divide by 12 inches per foot to calculate gallon per inch.  
 Area  $\times 7.5 \div 12 = \underline{\hspace{2cm}}$  sqft  $\times 7.5 \div 12 \text{ in/ft} = \underline{\hspace{2cm}}$  gallon per inch

3. Calculate total tank volume

A. Depth from bottom of inlet pipe to tank bottom  $\underline{\hspace{2cm}}$  in

B. Total tank volume = depth from bottom of inlet pipe to tank bottom (3A)  $\times$  gal/in (2)  
 =  $\underline{\hspace{2cm}}$  in  $\times$   $\underline{\hspace{2cm}}$  gal/in =  $\underline{\hspace{2cm}}$  gal

4. Calculate gallons to cover pump (with 2-3 inches of water covering pump)

(Pump and block height (inch) + 2 inch)  $\times$  gallon/inch  
 ( $\underline{\hspace{2cm}}$  in + 2 in)  $\times$   $\underline{\hspace{2cm}}$  gal/in =  $\underline{\hspace{2cm}}$  gallon

5. Calculate total pumpout volume

A. Select pump size for 4-5 does per day. Gallon per dose = gpd (see figure A-1) / doses per day =  $\underline{\hspace{2cm}}$  gpd  $\div$   $\underline{\hspace{2cm}}$  doses/day =  $\underline{\hspace{2cm}}$  gallons

B. Calculate drainback

1. Determine total pipe length  $\underline{\hspace{2cm}}$  feet

2. Determine liquid volume of pipe,  $\underline{\hspace{2cm}}$  gal per ft (see figure E-20)

3. Drainback quantity =  $\underline{\hspace{2cm}}$  ft (5B1)  $\times$   $\underline{\hspace{2cm}}$  gal per ft (5B2) =  $\underline{\hspace{2cm}}$  gal

C. Total pump out volume = dose volume (5A) + drainback (5B3)  
 $\underline{\hspace{2cm}}$  gal +  $\underline{\hspace{2cm}}$  gal =  $\underline{\hspace{2cm}}$  Total gallon

6. Float separation distance (using total pumpout volume)

Total pumpout volume (5C)  $\div$  gal/inch (2)  
 $\underline{\hspace{2cm}}$  gal  $\div$   $\underline{\hspace{2cm}}$  gal/in =  $\underline{\hspace{2cm}}$  inch

7. Calculate volume for alarm (typically 2 to 3 inches)

Alarm depth (inch)  $\times$  gallon/inch (2) =  $\underline{\hspace{2cm}}$  in  $\times$   $\underline{\hspace{2cm}}$  gal/in =  $\underline{\hspace{2cm}}$  gal

8. Calculate total gallon = gallons over pump (4) + gallons pumpout (5C) + gallons alarm (7)

$\underline{\hspace{2cm}}$  gal +  $\underline{\hspace{2cm}}$  gal +  $\underline{\hspace{2cm}}$  gal =  $\underline{\hspace{2cm}}$  gallons

9. Total Tank Depth = total gallon (8)  $\div$  gallon/inch (2)

$\underline{\hspace{2cm}}$  gal  $\div$   $\underline{\hspace{2cm}}$  gal/in =  $\underline{\hspace{2cm}}$  in

**Legal Tank:**  
 500 gallons or  
 100% the Daily flow  
 or  
 Alternating Pumps

number of bedrooms	Class I	Class II	Class III	Class IV
2	300	225	180	60%
3	450	300	218	of the
4	600	375	256	values
5	750	450	294	in the
6	900	525	332	Class I,
7	1050	600	370	II, or III
8	1200	675	408	columns.

Pipe Diameter inches	Gallons per foot
1	0.045
1.25	0.078
1.5	0.11
2	0.17
2.5	0.25
3	0.38
4	0.66

**Recommended:**  
 Calculate reserve capacity (75% the daily flow)  
 Daily flow  $\times .75 = \underline{\hspace{2cm}}$   $\times .75 = \underline{\hspace{2cm}}$  gallons

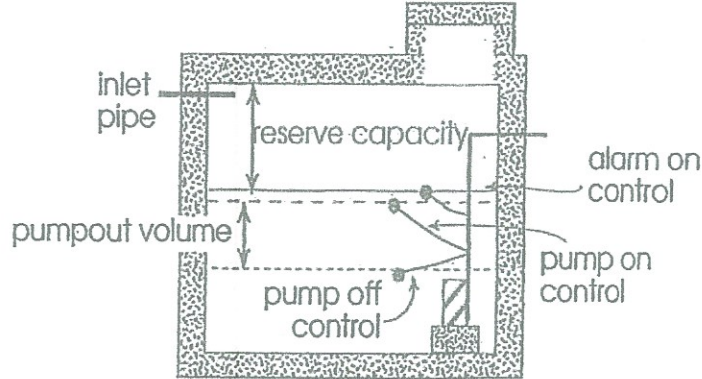

I hereby certify that I have completed this work in accordance with applicable ordinances, rules and laws.  
Bob Burtel (signature) 2088 (license #) 10-9-21 (date)

SKETCH SHEET

CLIENT: Adon Davis Now

DATE: 10-9-21

359<sup>th</sup> Lane

15-0-036700  
MAP DRAWN TO SCALE WITH A NORTH ARROW

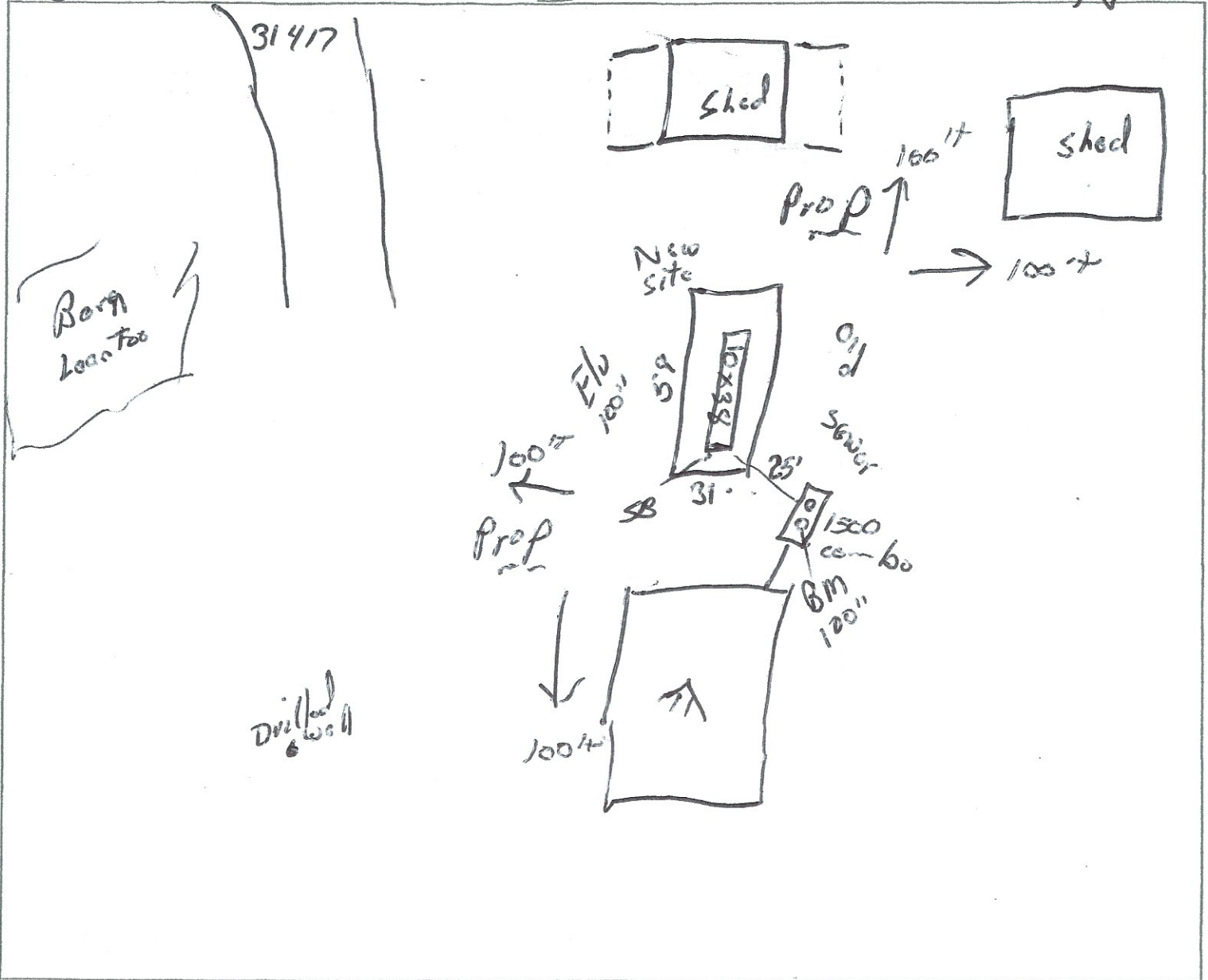

CHECK OFF LIST--HAVE ALL OF THE FOLLOWING BEEN DRAWN ON THE MAP??

SHOW EXISTING OR PROPOSED

- WATER WELLS WITHIN 100 FT OF TREATMENT AREAS
- PRESSURE WATER LINES WITHIN 10 FT OF TREATMENT AREAS
- STRUCTURES
- ALL SOIL TREATMENT AREAS
- HORIZONTAL AND VERTICAL REFERENCE
- POINT OF SOIL BORINGS
- LOT EASEMENTS
- DISTURBED/ COMPACTED AREAS
- SITE PROTECTION--LATHE AND RIBBON EVERY 15 FT
- ACCESS ROUTE FOR TANK MAINTENANCE

REQUIRED SETBACKS

- STRUCTURES
- OHWL
- LOT IMPROVEMENTS
- ALL ISTS COMPONENTS
- DIRECTION OF SLOPE
- ALL LOT DIMENSIONS
- PROPERTY LINES

COMMENTS:

INDICATE ELEVATIONS

- BENCHMARK 100"
- ELEVATION OF SEWER LINE @ HOUSE Exist-
- ELEVATION @ TANK INLET Exist-
- ELEVATION @ BOTTOM OF ROCK LAYER 18"
- ELEVATION @ BOTTOM OF BORING OR RESTRICTIVE LAYER 82"
- ELEVATION OF PUMP 44"
- ELEVATION OF DISTRIBUTION DEVICE 27"

DESIGNER SIGNATURE Bob Bull  
LICENSE# 2082

DATE 10-9-21



15-0-036700

# Subsurface Sewage Treatment System Management Plan

*New Owner!*  
Property Owner: Adam Davis Phone: 507-469-7260 Date: 10-9-21  
Mailing Address: \_\_\_\_\_ City: \_\_\_\_\_ Zip: \_\_\_\_\_  
Site Address: 31417 359<sup>th</sup> Lane City: Watkins Zip: 56431

This management plan will identify the operation and maintenance activities necessary to ensure long-term performance of your septic system. Some of these activities must be performed by you, the homeowner. Other tasks must be performed by a licensed septic service provider.

System Designer: check every \_\_\_\_\_ months.  
Local Government: check every \_\_\_\_\_ months.  
State Requirement: check every 36 months.

**My System needs to be checked every 24 months.**

*(State requirements are based on MIN Rules Chapter 7080.2450, Subp. 2 & 3)*

### Homeowner Management Tasks

- Leaks* – Check (look, listen) for leaks in toilets and dripping faucets. Repair leaks promptly.
- Surfacing sewage* – Regularly check for wet or spongy soil around your soil treatment area.
- Effluent filter* – *Inspect and clean twice a year or more.*
- Alarms* – Alarm signals when there is a problem. Contact a service provider any time an alarm signals.
- Event counter or water meter* – Record your water use.  
-recommend meter readings be conducted (circle one: DAILY WEEKLY MONTHLY)

### Professional Management Tasks

- Check to make sure tank is not leaking
- Check and clean the in-tank effluent filter
- Check the sludge/scum layer levels in all septic tanks
- Recommend if tank should be pumped
- Check inlet and outlet baffles
- Check the drainfield effluent levels in the rock layer
- Check the pump and alarm system functions
- Check wiring for corrosion and function
- Check dissolved oxygen and effluent temperature in tank
- Provide homeowner with list of results and any action to be taken
- Flush and clean laterals if cleanouts exist

"I understand it is my responsibility to properly operate and maintain the sewage treatment system on this property, utilizing the Management Plan. If requirements in the Management Plan are not met, I will promptly notify the permitting authority and take necessary corrective actions. If I have a new system, I agree to adequately protect the reserve area for future use as a soil treatment system."

Property Owner Signature: \_\_\_\_\_ Date: \_\_\_\_\_  
Designer Signature: Bob Barth Date: 10-9-21

See Reverse Side for Management Log

15-0-036700

**Maintenance Log**

Activity	Date Accomplished											
<b>Check frequently:</b>												
* Leaks: check for plumbing leaks												
* Soil treatment area check for surfacing												
Lint filter: check, clean if needed												
Effluent screen: if owner-maintained												
Water usage rate (monitor frequency _____)												
<b>Check annually:</b>												
* Caps: inspect, replace if needed												
* Sludge & Scum/Pump												
* Inlet & Outlet baffles												
* Drainfield effluent leaks												
Pump, alarm, wiring												
Flush & clean laterals if cleanouts exists												
Other: _____												
Other: _____												

Notes: \_\_\_\_\_  
\_\_\_\_\_  
\_\_\_\_\_  
\_\_\_\_\_

Mitigation/corrective action plan: \_\_\_\_\_  
\_\_\_\_\_  
\_\_\_\_\_  
\_\_\_\_\_