

**AITKIN COUNTY**  
**CERTIFICATE OF INSTALLATION/~~NOTICE OF NONCOMPLIANCE~~**

This certificate of installation/~~notice of noncompliance~~ has been issued this \_\_\_\_\_ day of \_\_\_\_\_, 20\_\_\_\_ to certify compliance/~~noncompliance~~ with Aitkin County's Subsurface Sewage Treatment System Ordinance.

The premises covered by this certificate are legally described as: \_\_\_\_\_  
\_\_\_\_\_  
\_\_\_\_\_

Section \_\_\_\_\_ Township \_\_\_\_\_ Range \_\_\_\_\_ Lake \_\_\_\_\_  
PERMIT NO. \_\_\_\_\_ Owner Name \_\_\_\_\_  
Address \_\_\_\_\_  
Installer Name \_\_\_\_\_  
Type of System Inspected \_\_\_\_\_  
Parcel Number \_\_\_\_\_

The certificate of installation/~~notice of noncompliance~~ was based on No \_\_\_ of the following:

- 1) Inspection of the installation or construction as in accordance with the above referenced permit and application design.
  
- 2) Review of as-built plans submitted in accordance with Subdivision 9.2 D of Aitkin County's Subsurface Sewage Treatment System Ordinance.

If the above permitted subsurface sewage treatment system is in noncompliance with Aitkin County's Subsurface Sewage Treatment System Ordinance, then the following shall serve as a Notice of Violation:

- 1) Statement of the findings of fact through inspections or investigations:  
\_\_\_\_\_  
\_\_\_\_\_

- 2) List of specific violations of Ordinance: \_\_\_\_\_  
\_\_\_\_\_  
\_\_\_\_\_

- 3) Requirements for correction or removal of violations: \_\_\_\_\_  
\_\_\_\_\_  
\_\_\_\_\_

- 4) Time schedule for compliance: \_\_\_\_\_  
\_\_\_\_\_

Failure to correct or remove the above violation(s) will result in this matter being turned over to the Aitkin County Attorney's Office for further legal action, which may result in revocation of licenses or registrations, fines and/or imprisonment.

INSPECTOR SIGNATURE \_\_\_\_\_

**SUBSURFACE SEWAGE TREATMENT SYSTEM INSPECTION FORM  
AITKIN COUNTY, MINNESOTA**

Township 51-27 Unorg. Date of Inspection 11/2/2021 App. Number 46551

Owner Jodi Doree Parcel Number 540-005000

Project Address 63618 Winding Rd Installer AI Nystrom

City Swatara Zip Code 55785 T13BR PB

New  Repair

**SETBACKS:**

Buildings to tank(s) 28'

Buildings to drainfield 40'

Well(s) 50' or 100' DW: 68' to DF

Lake/Creek/Wetland —

SEPTIC TANKS: New  Existing

Number of tanks installed 1

Liquid capacity and type 1350 Existing

Type of baffle Plastic

Inspection pipes —

Manholes size 24"

Manhole to grade Yes  No

PUMPS: New  Existing

Tank capacity and type 1000G pump tank

Pump manufacturer & model # Zoeller BQ9B

Horsepower & GPM 0.5HP 37GPM

Feet of head 14'

Gallons per cycle 90 GPC

Size of discharge line 2"

Type & location of alarm Elec. on tank

Water meter —

DIST. or DROP BOX & TYPE \_\_\_\_\_

**TRENCHES, BEDS, OR GRAVELLESS LEACHFIELD:**

Trench/Bed depth 24" to bottom rock bed

Trench/Bed length 57'

Trench/Bed bottom width 10'

<sup>lateral</sup> Trench spacing (3) 2" laterals

Drainfield rock below pipe 6"

Size of gravelless pipe —

Depth of backfill 12"

Absorption area: square feet 570 sf

lineal feet —

**MOUNDS:**

Percent slope 10%

Upslope sand width \_\_\_\_\_

Downslope sand width \_\_\_\_\_

Sideslope sand width \_\_\_\_\_

Drainfield rock below pipe \_\_\_\_\_

Depth of sand below rock \_\_\_\_\_

Perforation size & spacing 0.25" / 36" sp.

Pipe size & spacing 2" / 36" sp.

Dimensions of rock bed \_\_\_\_\_

Dimensions of sand base \_\_\_\_\_

Final cover \_\_\_\_\_

**DRAWING OF SYSTEM: (include soils)**

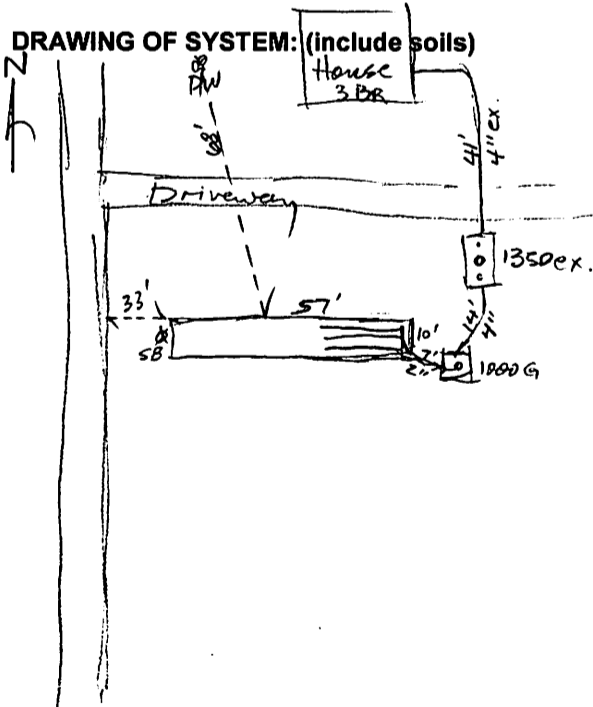

soil  
 A 0-5" 10YR 3/2 S.L 0-5% cf  
 E 5-14" 10YR 5/3 S.L 5-10% cf  
 Bw 14-20" 10YR 6/3 S.L 5-10% cf  
 2B 20-36" 10YR 5/4 SL 10-20% cf  
 3c1 36-60" 10YR 5/4 GrS 15-25% cf  
 3c2 60"- 10YR 6/4 GrS 25-30% cf

Inspector's Comments: \_\_\_\_\_

Inspector's Signature Bryan Hargrave Installer's Signature \_\_\_\_\_



2021/11/02



2021/11/02



2021/11/02



2021/11/02