

CERTIFICATE OF SURVEY

PRELIMINARY

TAME FISH LAKE
 Lake No.: 18000200
 Lake Classification: Recreational Development
 Date: April 28, 2021
 Water Elevation = 1261.3 feet (NGVD 29)
 O.H.W. Elevation = 1260.9 feet (NGVD 29)



DESCRIPTION - (As Per Doc. No. - 299817 Parcel No.: 11-0-022600)

That part of Government Lot One (1) in Section Seven (7), Township Forty-five (45), Range Twenty-seven (27) described as follows to-wit:

Commencing at a point in said Government Lot 1 which is 400 feet East of the West line thereof and 263.3 feet North of the South line thereof and running thence 73°37' to the right for a distance of 174.2 feet; thence deflecting to the left 90° for a distance of 254 feet, more or less, to the shore of Long Lake; thence Southwesterly along the shore of Long Lake to a point 400 feet East of the West line of said Government Lot 1 and thence Southerly parallel to the West line of Government Lot 1 to the point of beginning, and situate in Aitkin County, Minnesota; together with all the perpetual right of the first party to use the private road running from the East side of said Lot One (1) to the above described property for ingress and egress, Aitkin County, Minnesota.

SURVEYOR'S NOTES:

1. Bearing Orientation: The west line of Government Lot 1 of Section 7, Township 45, Range 27 is assumed to have a bearing of North 00 degrees 03 minutes 09 seconds East.
2. Arro Land Surveying of Brainerd, INC. has made no investigation or independent search for easements of record, encumbrances, restrictive covenants, ownership title evidence, or any other facts that an accurate and current title search may disclose.
3. The improvements shown east of subject property have been digitized from the Aitkin County GIS and should be verified prior to any description changes.
4. Wetlands may exist on subject property but were not identified in the preparation of this survey.
5. The utilities as shown on this survey were developed from the visible utilities across your property and is not implied nor intended to be the complete inventory of utilities in this area. It is the client's responsibility to verify the location of all utilities prior to construction or improving your property.

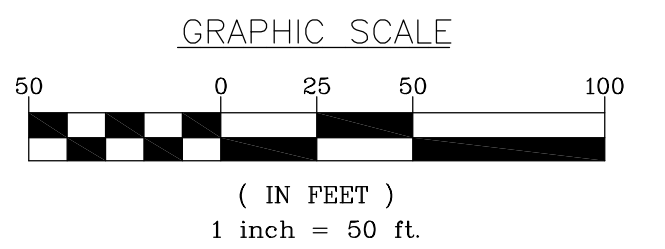
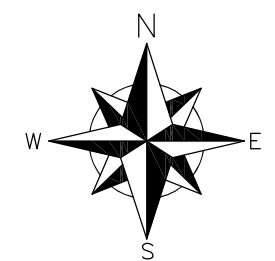

DRAWN BY: JAS	CHECKED BY: MTD		
APPROVED BY: MTD	JOB NUMBER: 21-070B		
NO.	DATE	BY	REVISION DESCRIPTION

CLIENT: **Pam Shaw**
 Property Address:
 26783 456th Place,
 Aitkin, MN 56431

BOUNDARY SURVEY

Part of Gov't Lot 1,
 Sec. 7, T.45, R.27,
 Aitkin County, MN

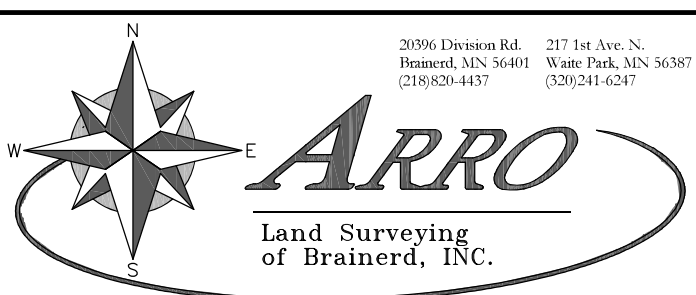

I hereby certify that this survey, plan or report was prepared by me or under my direct supervision and that I am a duly licensed land surveyor under the laws of the state of Minnesota.

Dated this _____ day of _____

By: _____
 Mark T. Downing, Minnesota License No. 46165