

**SUBSURFACE SEWAGE TREATMENT SYSTEM INSPECTION FORM
AITKIN COUNTY, MINNESOTA**

Township Hill Lake Date of Inspection 6/11/2021 App. Number 2021-7370
46075
Owner John + Denise Scharber Parcel Number 12-1-073900
Project Address 67161 348th Pl Installer Dave Lange
City Hill City Zip Code 55748 TZ HT

New Repair DIST. or DROP BOX & TYPE -

SETBACKS:
Buildings to tank(s) 18'
Buildings to drainfield -
Well(s) 50' or 100' DW: 100' + to closest tank
Lake/Creek/Wetland Hill Lake: 100' + to tank

TRENCHES, BEDS, OR GRAVELLESS LEACHFIELD:
Trench/Bed depth _____
Trench/Bed length _____
Trench/Bed bottom width _____
Trench spacing _____
Drainfield rock below pipe _____
Size of gravelless pipe _____
Depth of backfill _____
Absorption area: square feet _____
lineal feet _____

SEPTIC TANKS: New Existing
Number of tanks installed (1) 1500G Interceptor
Liquid capacity and type 1500 (Ex) + 1500G
Type of baffle Plastic
Inspection pipes (1) 6" on existing
Manholes size 24"
Manhole to grade Yes No

MOUNDS:
Percent slope _____
Upslope sand width _____
Downslope sand width _____
Sideslope sand width _____
Drainfield rock below pipe _____
Depth of sand below rock _____
Perforation size & spacing _____
Pipe size & spacing _____
Dimensions of rock bed _____
Dimensions of sand base _____
Final cover _____

PUMPS: New Existing
Tank capacity and type _____
Pump manufacturer & model # _____
Horsepower & GPM _____
Feet of head _____
Gallons per cycle _____
Size of discharge line _____
Type & location of alarm Manual popup
Water meter _____

DRAWING OF SYSTEM: (include soils)

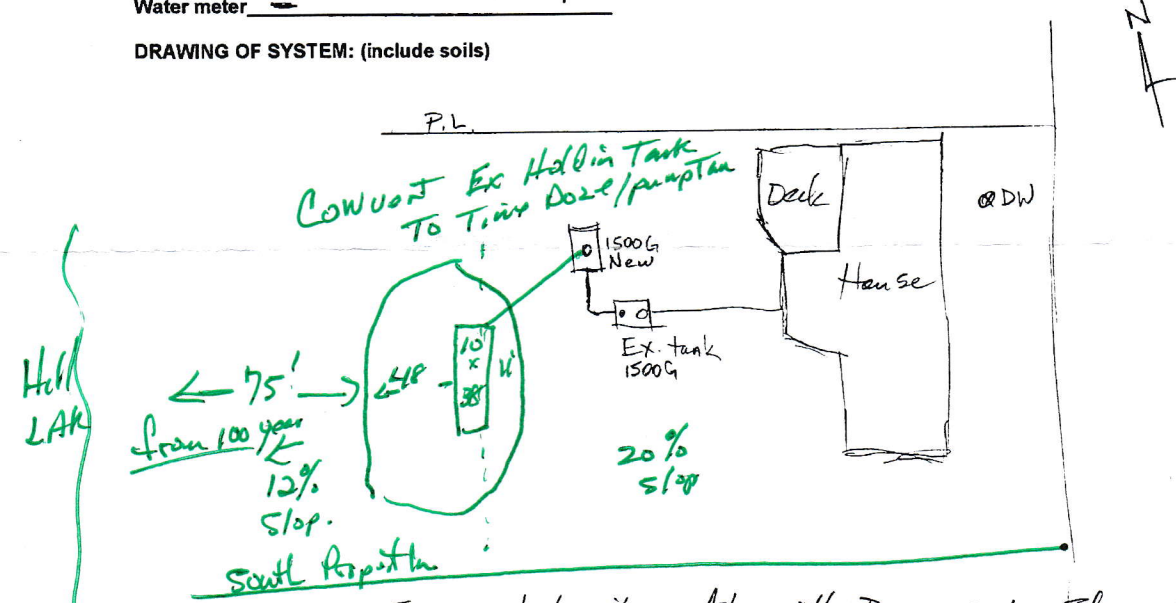

Inspector's Comments: I inspected soil profile with Dave earlier. Slope of available site for mound in excess of 20%. There was no other suitable site. Holding tanks only option. Depth tank 4'
Inspector's Signature Bryan Hargrave Installer's Signature _____