

AITKIN COUNTY
CERTIFICATE OF INSTALLATION/~~NOTICE OF NONCOMPLIANCE~~

This certificate of installation/~~notice of noncompliance~~ has been issued this _____ day of _____, 20____ to certify compliance/~~noncompliance~~ with Aitkin County's Subsurface Sewage Treatment System Ordinance.

The premises covered by this certificate are legally described as: _____

Section _____ Township _____ Range _____ Lake _____
PERMIT NO. _____ Owner Name _____
Address _____
Installer Name _____
Type of System Inspected _____
Parcel Number _____

The certificate of installation/~~notice of noncompliance~~ was based on No ___ of the following:

- 1) Inspection of the installation or construction as in accordance with the above referenced permit and application design.

- 2) Review of as-built plans submitted in accordance with Subdivision 9.2 D of Aitkin County's Subsurface Sewage Treatment System Ordinance.

If the above permitted subsurface sewage treatment system is in noncompliance with Aitkin County's Subsurface Sewage Treatment System Ordinance, then the following shall serve as a Notice of Violation:

- 1) Statement of the findings of fact through inspections or investigations:

- 2) List of specific violations of Ordinance: _____

- 3) Requirements for correction or removal of violations: _____

- 4) Time schedule for compliance: _____

Failure to correct or remove the above violation(s) will result in this matter being turned over to the Aitkin County Attorney's Office for further legal action, which may result in revocation of licenses or registrations, fines and/or imprisonment.

INSPECTOR SIGNATURE _____

**SUBSURFACE SEWAGE TREATMENT SYSTEM INSPECTION FORM
AITKIN COUNTY, MINNESOTA**

Township Macville Date of Inspection 10/25/2021 I
11/2/2021 F App. Number 46437

Owner Kevin Gulbraa Parcel Number 20-0-011700

Project Address 62968 Osprey Ave. Installer Dave Lange

City Swatara Zip Code 55785 T1 3BR Mshnd.

New Repair

DIST. or DROP BOX & TYPE —

SETBACKS:

Buildings to tank(s) 24'
Buildings to drainfield 42'
Well(s) 50' or 100' DW: 52'
Lake/Creek/Wetland —

TRENCHES, BEDS, OR GRAVELLESS LEACHFIELD:

Trench/Bed depth —
Trench/Bed length —
Trench/Bed bottom width —
Trench spacing —
Drainfield rock below pipe —
Size of gravelless pipe —
Depth of backfill —
Absorption area: square feet —
lineal feet —

SEPTIC TANKS:

New Existing

Number of tanks installed (1) 1650 Tac Combo
Liquid capacity and type 1120 part Combo
Type of baffle Plastic
Inspection pipes —

MOUNDS:

Percent slope 8%
Upslope sand width 6'
Downslope sand width 17'
Sideslope sand width 10'
Drainfield rock below pipe 9"
Depth of sand below rock 24"
Perforation size & spacing 0.25"/36" sp.
Pipe size & spacing 2"/36" sp.
Dimensions of rock bed 10' X 38'
Dimensions of sand base 33' X 58'
Final cover 12" cover over rb; 4" TS

Manholes size 24"
Manhole to grade Yes No

PUMPS:

New Existing

Tank capacity and type 533 part
Pump manufacturer & model # Zoeller B99B
Horsepower & GPM 1/2 HP 27GPM
Feet of head 14'
Gallons per cycle 113 GPC
Size of discharge line 2"
Type & location of alarm Elec. on tank
Water meter —

DRAWING OF SYSTEM: (include soils)

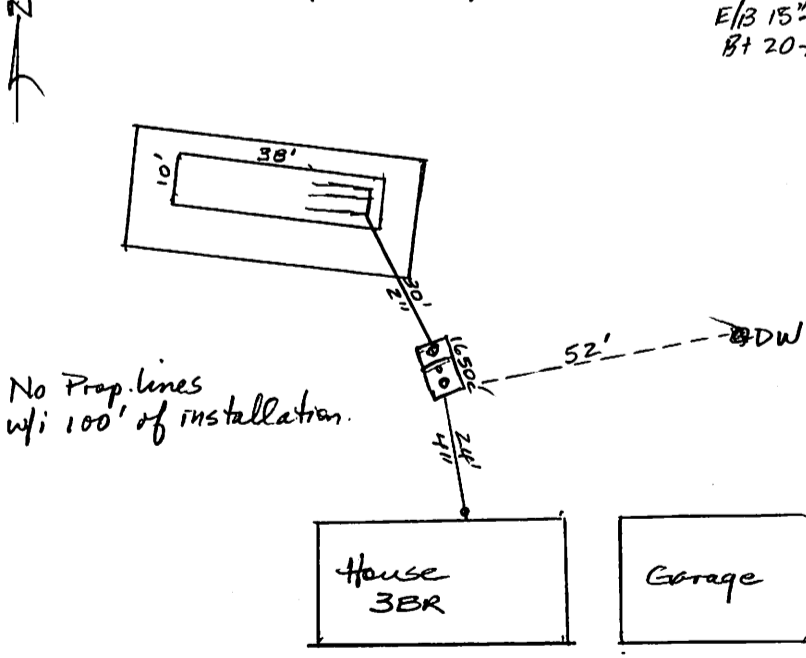

soil
A 0-7" 10YR 3/2 FSL 0-5%ocf No redox w/; 25"
E 7-15" 10YR 5/3 FSL 5-10%ocf
E/B 15-20" 10YR 5/3 L 5-10%ocf
Bt 20-26" 10YR 4/4 L

Inspector's Comments: 24' 4" 30' 2"

Inspector's Signature Bryan Hargrave

Installer's Signature Dave Lange



2021/10/25



2021/10/25



2021/10/25



2021/10/25



2021/10/25



2021/10/25



2021/11/02



2021/11/02



2021/11/02