

COMPANY INFORMATION

ALL ENERGY SOLAR, INC
 1264 ENERGY LANE
 ST PAUL, MN 55108
 (800) 620-3370
 INFO@ALLEENERGYSOLAR.COM

CLIENT INFORMATION

PEGGY JONES
 35374 350TH AVE
 AITKIN, MN 56431
PO 45110

Panel Type

LG 370 BOB (USA)

of Panels

28

System Size (kW)

10.360

Ground Mount

NOTES:

1. (28) ENPHASE IQ7PLUS INVERTER(S)
2. ARRAY 1:
 35° TILT, 180° AZIMUTH

AZIMUTH



REVISIONS

LAST: 08/6/21 BX

PROJECT-PAGE TITLE

COVER PAGE

PAGE NUMBER

A0

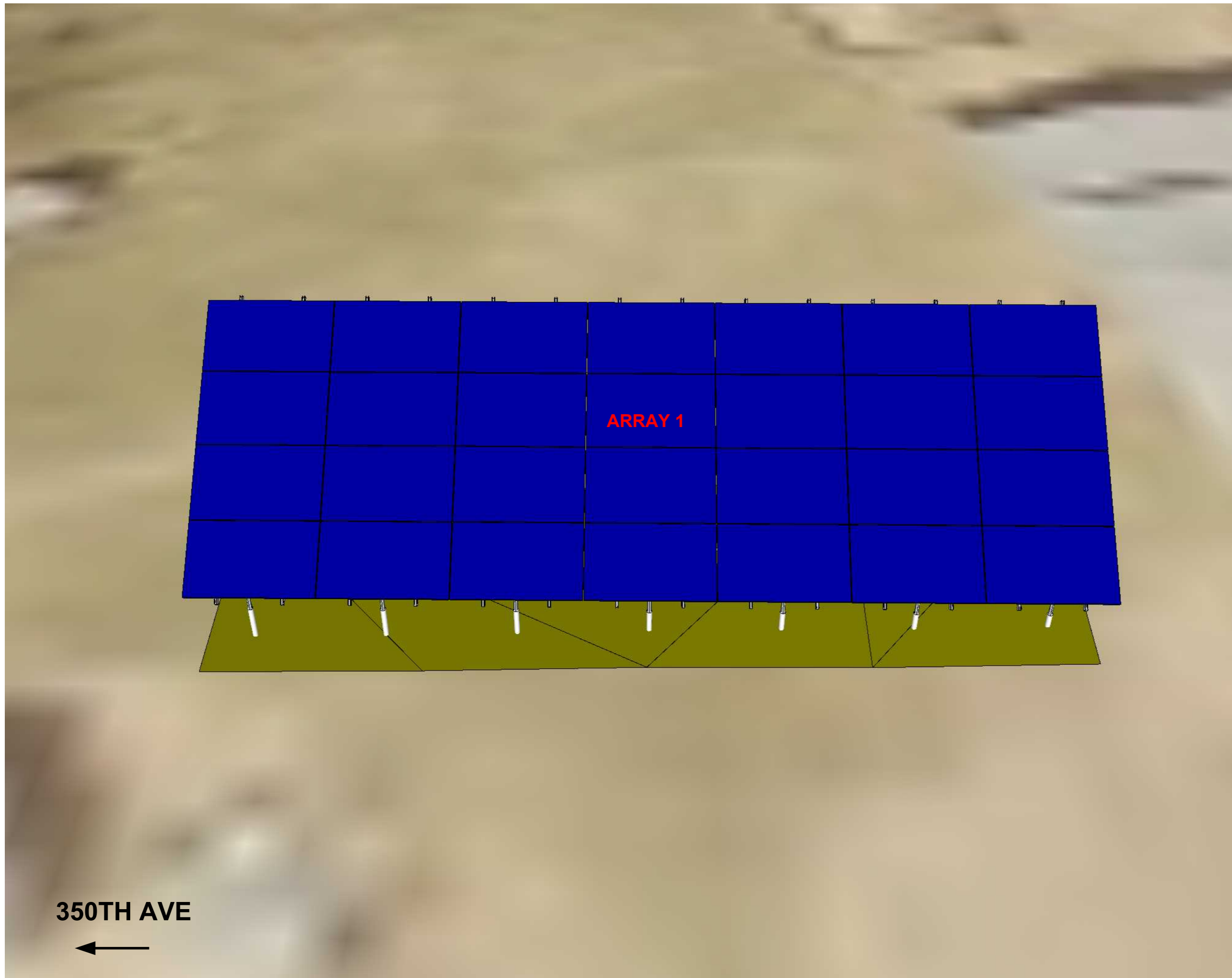

350TH AVE





COMPANY INFORMATION

ALL ENERGY SOLAR, INC
 1264 ENERGY LANE
 ST PAUL, MN 55108
 (800) 620-3370
 INFO@ALLEENERGYSOLAR.COM

CLIENT INFORMATION

PEGGY JONES
 35374 350TH AVE
 AITKIN, MN 56431
 PO 45110

SYSTEM DETAILS

- NOTES:
1. (28) ENPHASE IQ7PLUS INVERTER(S) = 8.12kW AC
 2. ARRAY 1:
 180° AZIMUTH, 35° TILT
 (28) LG 370W = 10.36kW

ACCOUNT: 33-25-004-04
 PREMISE:
 METER: 202735

AZIMUTH



REVISIONS

LAST: 08/6/21 BX

PROJECT-PAGE TITLE

PROPERTY MAP

PAGE NUMBER

A1

NORTH ELEVATION

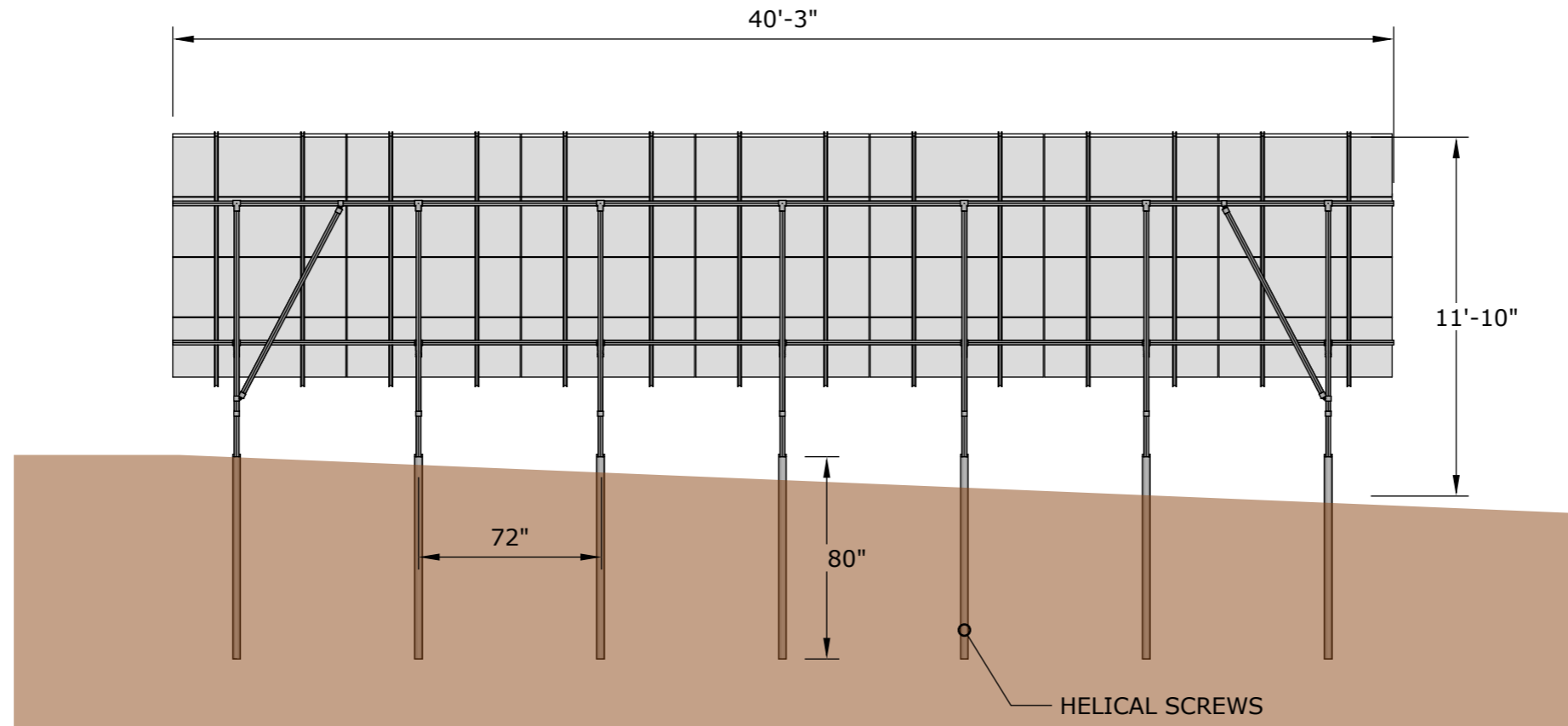

WEST ELEVATION

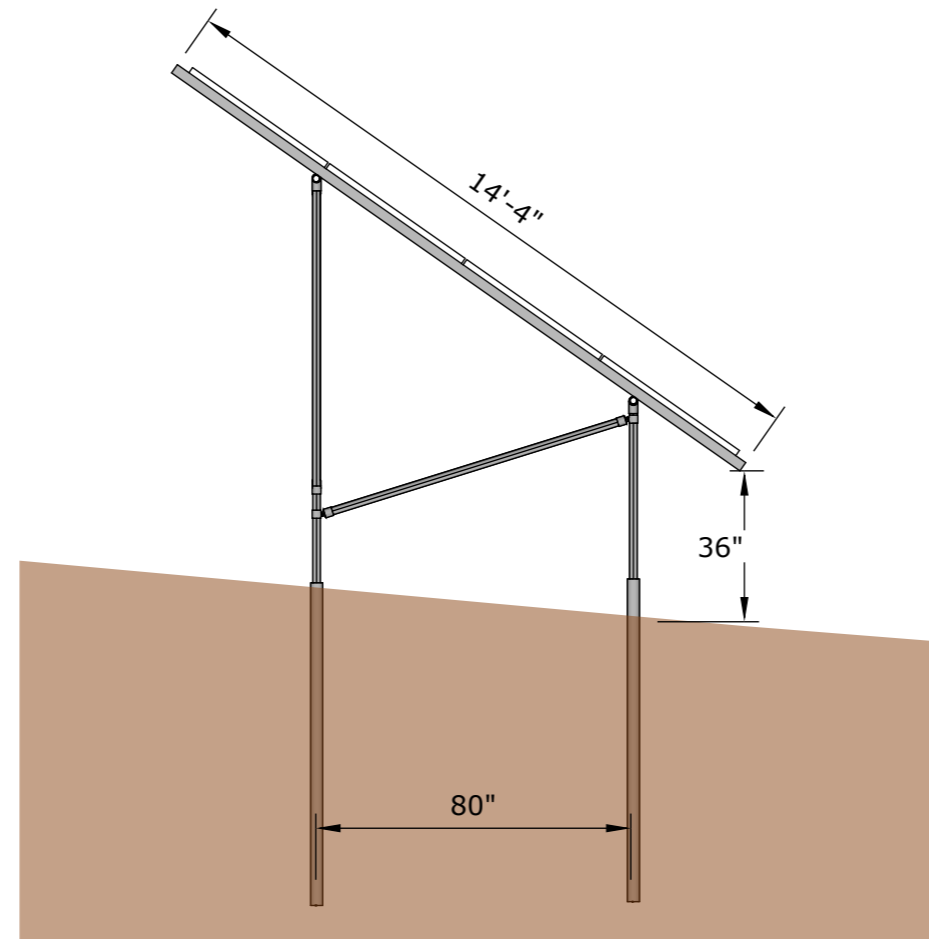

COMPANY INFORMATION

ALL ENERGY SOLAR, INC
 1264 ENERGY LANE
 ST PAUL, MN 55108
 (800) 620-3370
 INFO@ALLEENERGYSOLAR.COM

CLIENT INFORMATION

PEGGY JONES
 35374 350TH AVE
 AITKIN, MN 56431
 PO 45110

SYSTEM DETAILS

NOTES:

1. ELEVATIONS MAY VARY DEPENDING ON GROUND ELEVATION BUT ARE DRAWN TO THE BEST OF OUR ABILITY

REVISIONS

LAST: 08/6/21 BX

PROJECT-PAGE TITLE

ELEVATION DRAWINGS

PAGE NUMBER

A2

COMPANY INFORMATION

ALL ENERGY SOLAR, INC
 1264 ENERGY LANE
 ST PAUL, MN 55108
 (800) 620-3370
 INFO@ALLENERGYSOLAR.COM

CLIENT INFORMATION

PEGGY JONES
 35374 350TH AVE
 AITKIN, MN 56431
 PO 45110

SYSTEM DETAILS

SUNMODO MOUNTING HARDWARE:

- (14) FOOTINGS
- SEE CONFIGURATION IN DRIVE FOR ADDITIONAL MATERIALS

**STRINGING TO BE DETERMINED ON SITE*

AZIMUTH



REVISIONS

LAST: 08/6/21 BX

PROJECT-PAGE TITLE

RAIL AND STRINGING DIAGRAM

PAGE NUMBER

A3

NOTES: UNLESS OTHERWISE SPECIFIED

- THIS DRAWING IS NOT FOR CONSTRUCTION UNTIL ENGINEERING HAS REVIEWED AND STAMPED THIS DOCUMENT. **12. K10448-001 IS AN ACCEPTABLE SUBSTITUTE FOR K10342-001 PIPE SPLICE KIT**
- DIMENSIONS SHOWN ARE INCHES.
- THE SELF-BONDING SYSTEM AND SINGLE GROUND LUG IS FOR USE WITH PV MODULES THAT HAVE A MAXIMUM SERIES FUSE RATING OF 30A.
- MATERIALS ARE AS SPECIFIED OR EQUIVALENT:
 HARDWARE: 304 STAINLESS STEEL
 FABRICATED EXTRUDED PARTS: 6005-T5 ALUMINUM ALLOY
 FABRICATED DIE CAST PARTS: ANSI/AA A380 ALUMINUM ALLOY
 STEEL PIPE: SCHEDULE 40 GALVANIZED
 ALUMINUM PIPE: SCHEDULE 10 ANODIZED
- THE MAXIMUM PERMISSIBLE LENGTH OF ANY STRUCTURE SHALL BE 200 FT. FOR SYSTEMS USING A SHARED RAIL CONFIGURATION, A THERMAL BREAK IS REQUIRED IN THE RAIL EVERY 40 FT. PER THE DRAWING DETAILS.
- 4LX7-35DEG-STR-GSM-AGM-BGM-PGM**
- APPROVED RAIL PROFILES VARY BASED ON ENGINEERING REQUIREMENTS. CONFIRM SELECTION WITH STRUCTURAL ENGINEER. SEE BOM IN BOTTOM RIGHT CORNER.
- K10224-XXX END CLAMP KIT OR K10299-XXX ADJ. END CLAMP KIT.
- FOUNDATION TYPES:
 GSM = GROUND SCREW GROUND MOUNT
 AGM = HELICAL AUGER GROUND MOUNT
 PGM = POST-IN-CONCRETE GROUND MOUNT
 BSM = BALLAST GROUND MOUNT

- 1 OF 1 ARRAY TYPES
- 1 ARRAYS TOTAL

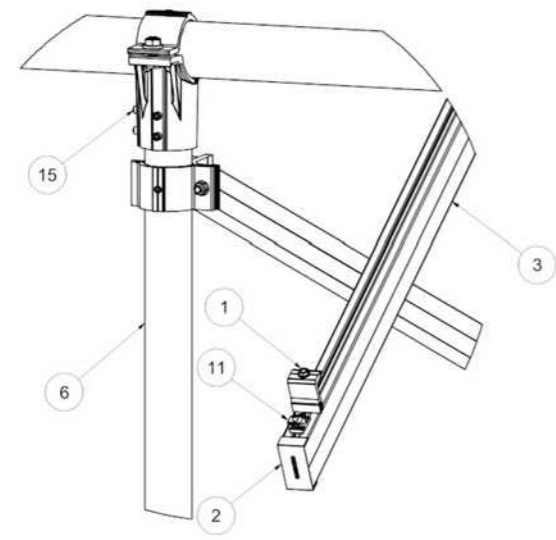
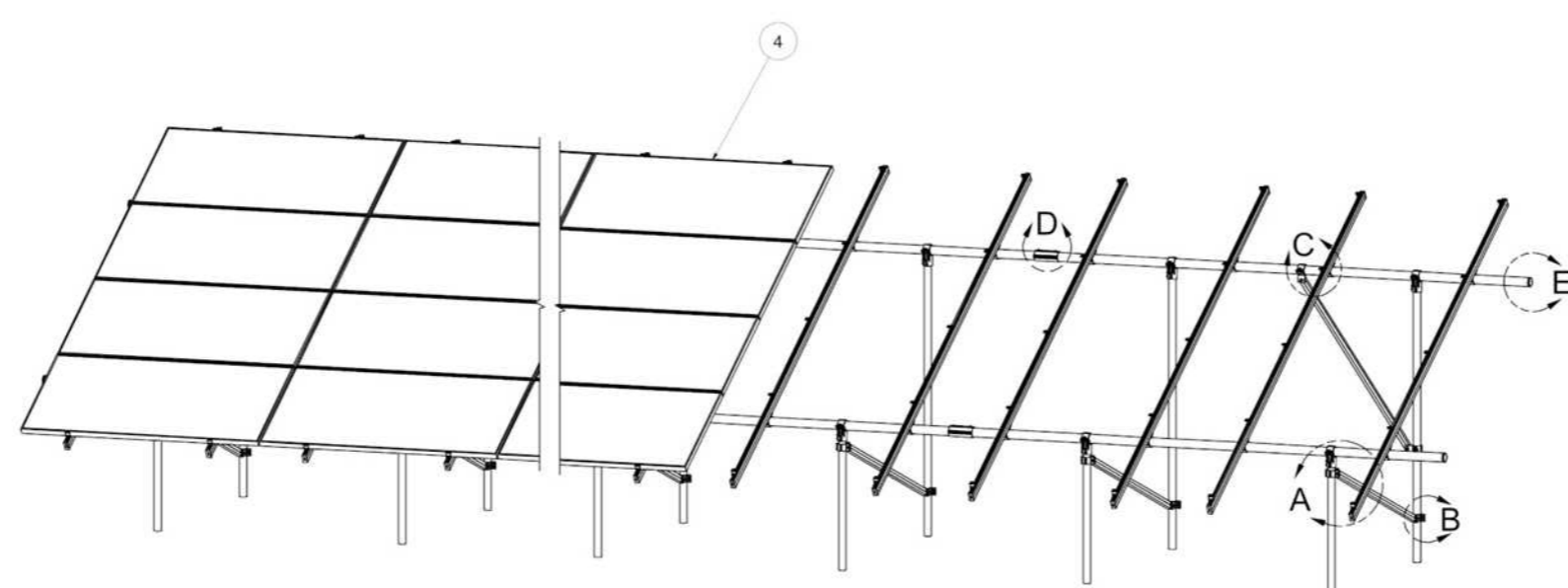

DETAIL A

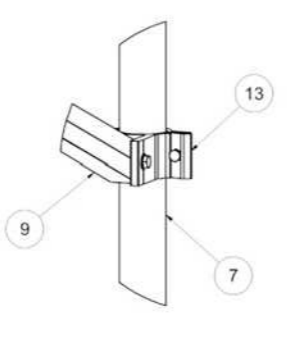

DETAIL B

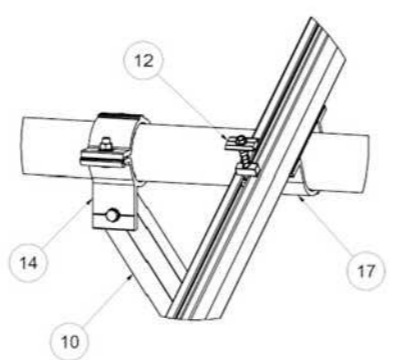

DETAIL C

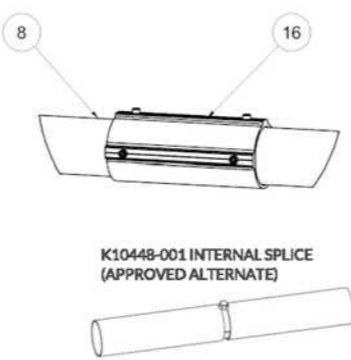

DETAIL D

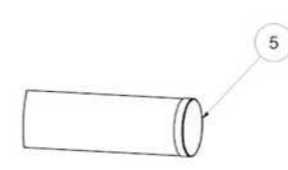

DETAIL E

K10448-001 INTERNAL SPLICE (APPROVED ALTERNATE)

PACKET A9	
Model Code	ASCE 7-16
Exposure Category	C
Wind Speed	105
Ground Snow Load	60
Tilt	35

4LX7 ARRAY

17	K10343-004	2.5" Pipe U-Clamp Kit	28
16	K10448-001	2.5" Pipe Splice Kit	8
15	K10341-002	2.5" Pipe T-Cap Kit	14
14	K10222-001	2.5" Pipe Clamp Kit	2
13	K10219-001	2" Pipe Clamp Kit	16
12	K10180-001	Universal Mid Clamp Kit	42
11	K10179-002	Grounding Lug	1
10	A50164-066	HSS E/W Tube Brace	2
9	A50164-092	HSS N/S Tube Brace	7
8	A21168-112	2.875" OD E/W Pipe Beam, 112"	10
7	A21165-060	HSS 2.375" OD Front Pipe	7
6	A21165-120	HSS 2.375" OD Rear Pipe	7
5	A20380-001	2.5" PIPE END CAP (OPTIONAL)	4
4		Panel 1,740 x1,041 x40.0mm	28
3	A20288-206-ML	Helio Rail HR300, 206"	14
2	A20297-001	Rail End Cap	28
1	K10224-140	End Clamp Kit	28

ITEM	PART NUMBER	DESCRIPTION	QTY
SEE BOM			
SunModo Corp.			
14800 NE 65TH STREET, VANCOUVER WA 98682			
TITLE: PEGGY JONES 45110			
D 43DOC4			
SCALE: N.T.S. SHEET 1 of 4			

(28) LG LG370N1K-A6 MODULES (28) ENPHASE IQ7PLUS INVERTER(S)	MAX CIRCUIT LENGTH (120/240V)	15A BREAKER	20A BREAKER
	ENPHASE IQ7	12	16
	ENPHASE IQ7+	9	13
	ENPHASE IQ7X	9	12
	ENPHASE IQ7A	8	11

CIRCUITS:

(2) CIRCUIT(S) OF 9 MICROS

(1) CIRCUIT(S) OF 10 MICROS

THIS DRAWING IS CONFIDENTIAL PROPERTY OF SUNMODO AND ITS CONTENTS MAY NOT BE DISCLOSED WITHOUT THE PRIOR WRITTEN CONSENT OF SUNMODO CORP.



COMPANY INFORMATION

ALL ENERGY SOLAR, INC
1264 ENERGY LANE
ST PAUL, MN 55108
(800) 620-3370
INFO@ALLEENERGYSOLAR.COM

CLIENT INFORMATION

TOM JONES
PEGGY JONES
35374 350TH AVE
AITKIN, MN 56431
PO 45110

SYSTEM DETAILS

NOTES:

- (28) ENPHASE IQ7PLUS INVERTER(S) = 8.12kW AC
- ARRAY 1:
180° AZIMUTH, 35° TILT
(28) LG 370W = 10.36kW

ACCOUNT: 33-25-004-04
PREMISE:
METER: 202735

AZIMUTH



REVISIONS

LAST: 08/6/21 BX

PROJECT-PAGE TITLE

SITE MAP

PAGE NUMBER

A4

DISTANCES

SOLAR PANELS - INVERTERS: 5' MAX
INVERTERS - PV COMBINER PANEL: 50' MAX
PV COMBINER PANEL - IQ COMBINER PANEL: 120' MAX
IQ COMBINER PANEL - UTILITY AC DISCONNECT: 2'
UTILITY AC DISCONNECT - PV PRODUCTION METER: 2'
PV PRODUCTION METER - MAIN ELECTRIC SERVICE: 2'
MAIN ELECTRIC SERVICE - BI-DIRECTIONAL METER: 2'

CALL-OUTS:

- SOLAR PANELS
- INVERTERS
- PV COMBINER PANEL
- ENPHASE IQ COMBINER PANEL
- UTILITY AC DISCONNECT
- PV PRODUCTION METER
- MAIN ELECTRIC SERVICE
- BI-DIRECTIONAL METER

350TH AVE

↓ 2,040'
47 RD

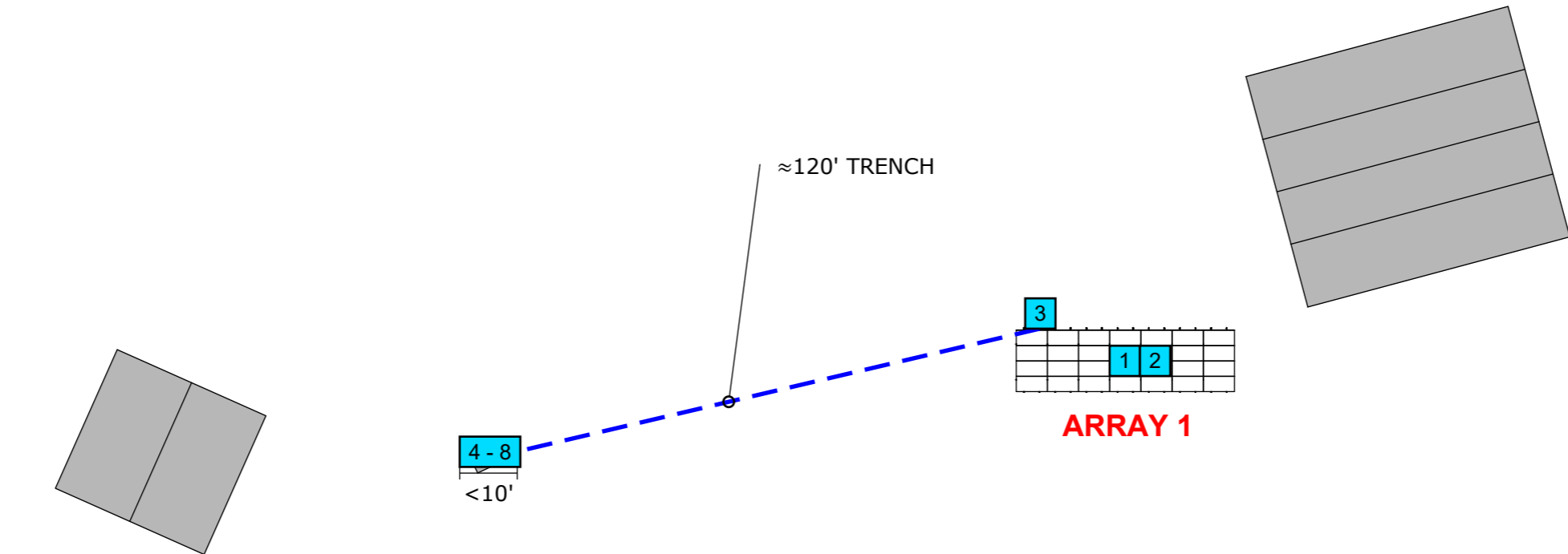

NOTES:

- LOCATION OF SERVICE PANEL AND ELECTRICAL EQUIPMENT ARE SHOWN. FINAL LOCATION MAY CHANGE
- LOCATION OF SERVICE PANEL AND ADDITIONAL ELECTRICAL EQUIPMENT NOT DRAWN TO SCALE
- PV INTERCONNECTION IS A SECONDARY INTERCONNECTION
- AC DISCONNECT AND PRODUCTION METER IN READILY ACCESSIBLE LOCATION WITHIN 10' OF MAIN SERVICE METER/BI-DIRECTIONAL METER. 24/7 UNESCORTED KEYLESS ACCESS TO BE PROVIDED FOR UTILITY AC DISCONNECT, PV PRODUCTION METER, & BI-DIRECTIONAL METER.**

5. PV EQUIPMENT SHALL BE INSTALLED IN ACCORDANCE WITH NEC 690 AND POSTED WITH APPLICABLE WARNINGS, SIGNAGE, AND PLAQUES PER NEC 705-10, 690-17, & 690-64 (b)(5).

6. CIRCUITS:

- (2) CIRCUIT(S) OF 9 (15AMPS EACH)
- (1) CIRCUIT(S) OF 10 (20AMPS EACH)

LABELS LOCATED ON PV PRODUCTION METER, BI-DIRECTIONAL METER, AC DISCONNECT(S), INVERTER(S), AND APPROPRIATE LABELS ON MAIN ELECTRIC SERVICE. ALL LABELS ARE PERMANENT, WEATHERPROOF, AND DURABLE

THERE ARE NO CLEARANCE ISSUES DUE TO OVERHEAD POWERLINES.