

Mille Lacs LAKE

Address: ID 16-1-093500
 Myron & Wendy Lee
 1339 329th Ave
 Isle MN 56342

- Proposed 28' wide 48' deep 16' tall.
 - stud FRAME Garage

- 2x6 stud FRAME 2' OC
- Floating thickened edge concrete floor
- metal Roof siding
- 4' OC truss

- An design & materials provided by MILLNER BUILDING CENTER
- APPROXIMATELY 130' FROM 329th AVE on East side
- APPROXIMATELY 489' FROM Mille Lacs LAKE on West side

Kot Line

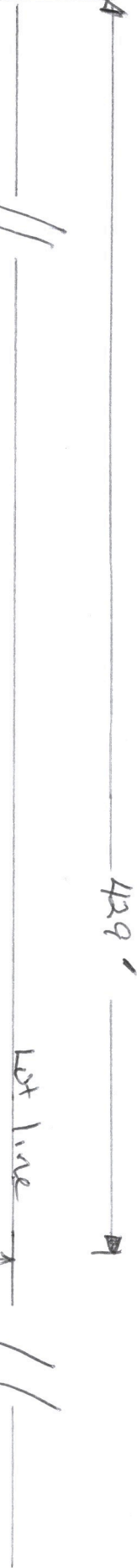
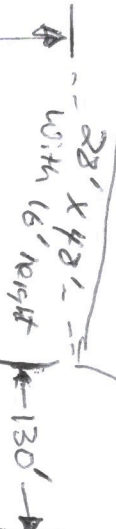
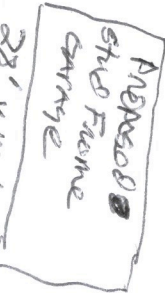
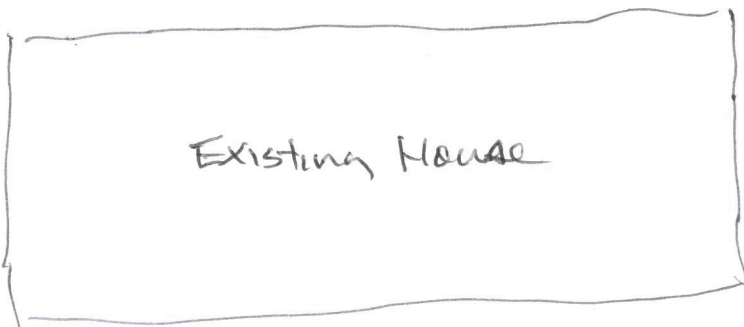

Not to Scale / Measurements are Approximate

329th Ave