

AITKIN COUNTY
CERTIFICATE OF INSTALLATION/~~NOTICE OF NONCOMPLIANCE~~

This certificate of installation/~~notice of noncompliance~~ has been issued this _____ day of _____, 20____ to certify compliance/~~noncompliance~~ with Aitkin County's Subsurface Sewage Treatment System Ordinance.

The premises covered by this certificate are legally described as: _____

Section _____ Township _____ Range _____ Lake _____
PERMIT NO. _____ Owner Name _____
Address _____
Installer Name _____
Type of System Inspected _____
Parcel Number _____

The certificate of installation/~~notice of noncompliance~~ was based on No ___ of the following:

- 1) Inspection of the installation or construction as in accordance with the above referenced permit and application design.

- 2) Review of as-built plans submitted in accordance with Subdivision 9.2 D of Aitkin County's Subsurface Sewage Treatment System Ordinance.

If the above permitted subsurface sewage treatment system is in noncompliance with Aitkin County's Subsurface Sewage Treatment System Ordinance, then the following shall serve as a Notice of Violation:

- 1) Statement of the findings of fact through inspections or investigations:

- 2) List of specific violations of Ordinance: _____

- 3) Requirements for correction or removal of violations: _____

- 4) Time schedule for compliance: _____

Failure to correct or remove the above violation(s) will result in this matter being turned over to the Aitkin County Attorney's Office for further legal action, which may result in revocation of licenses or registrations, fines and/or imprisonment.

INSPECTOR SIGNATURE _____

**SUBSURFACE SEWAGE TREATMENT SYSTEM INSPECTION FORM
AITKIN COUNTY, MINNESOTA**

Township Clark Date of Inspection 9/27/2021 I
10/28/2021 F App. Number 46346

Owner Kristic Fugera Parcel Number 05-0-017100

Project Address 43281 110th Ave. Installer Advanced Excavating

City Tamarack Zip Code 55787 T3 3BR mound

New Repair

DIST. or DROP BOX & TYPE —

SETBACKS:

Buildings to tank(s) 15'

Buildings to drainfield 33'

Well(s) 50' or 100' DW: 109' to tank

Lake/Creek/Wetland —

TRENCHES, BEDS, OR GRAVELLESS LEACHFIELD:

Trench/Bed depth —

Trench/Bed length —

Trench/Bed bottom width —

Trench spacing —

Drainfield rock below pipe —

Size of gravelless pipe —

Depth of backfill —

Absorption area: square feet —

lineal feet —

SEPTIC TANKS: New Existing

Number of tanks installed (1) 1500 Del Zotto comb

Liquid capacity and type 1000G Part Combo

Type of baffle Plastic

Inspection pipes —

Manholes size 24"

Manhole to grade Yes No

MOUNDS:

Percent slope 1%

Upslope sand width 15'

Downslope sand width 17'

Sideslope sand width 6'

Drainfield rock below pipe 6"

Depth of sand below rock 36"

Perforation size & spacing 0.25"/36" sp

Pipe size & spacing 2"/36" sp

Dimensions of rock bed 10' x 38'

Dimensions of sand base 42' x 50'

Final cover 12" cover over r b, 4" TS

PUMPS: New Existing

Tank capacity and type 500 part combo

Pump manufacturer & model # Gould PF31

Horsepower & GPM 1/2 HP 27GPM

Feet of head 14.5'

Gallons per cycle 113 GPC

Size of discharge line 2"

Type & location of alarm Elec

Water meter Event counter

DRAWING OF SYSTEM: (include soils)

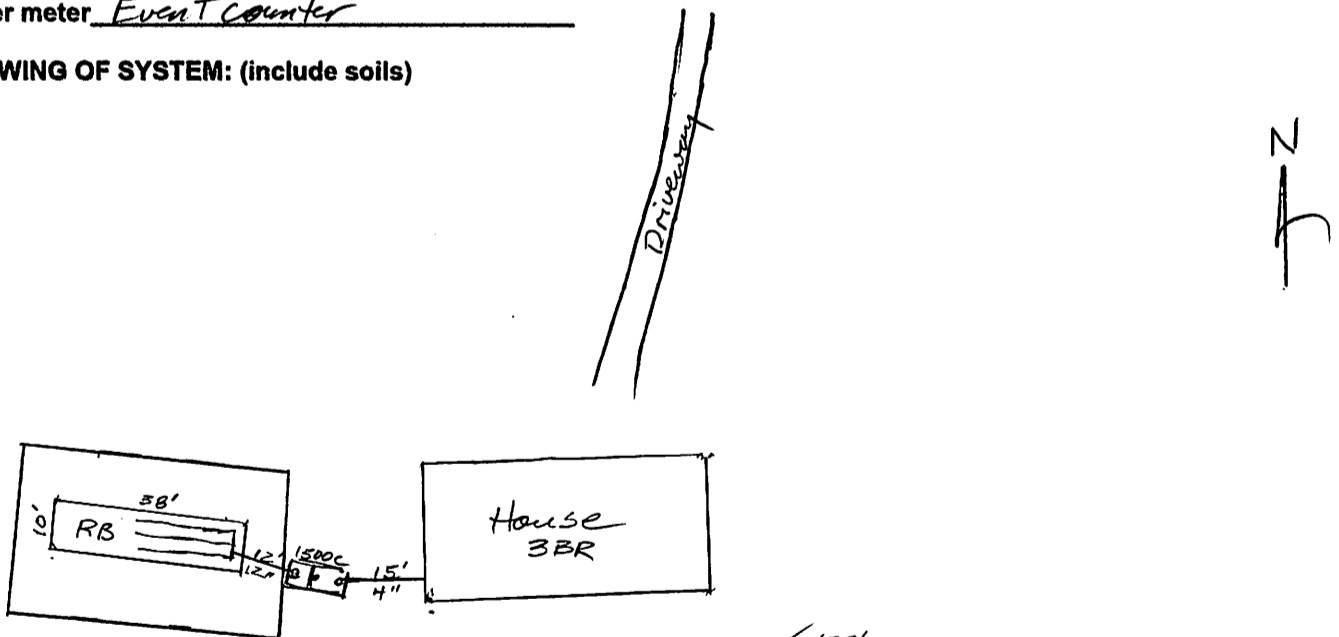

No Prop. Lines w/i 100' of installation

Inspector's Comments: DeCone - Sawyer Sand. Type 3 system - meets 36\"/>

Inspector's Signature Bryan Hargrave Installer's Signature —



2021/09/27



2021/09/27



2021/09/27



2021/09/27



2021/09/27



ANOTHER QUALITY HOME FROM
MOBILE
HOUSING
L.P.'S
DUBLIN, MN
218-722-0871

2021/09/27