

36993 690th Lane,
Hill City.
12-0-007500

AITKIN COUNTY BUILDING PERMIT SITE PLAN

Please indicate the location of: Wells, well setback to system components, buildings, septic system components, reserved septic system area, property lines, waterways, and buried lines. Include size, length, and appropriate distances from fixed reference points. Provide a North directional arrow!

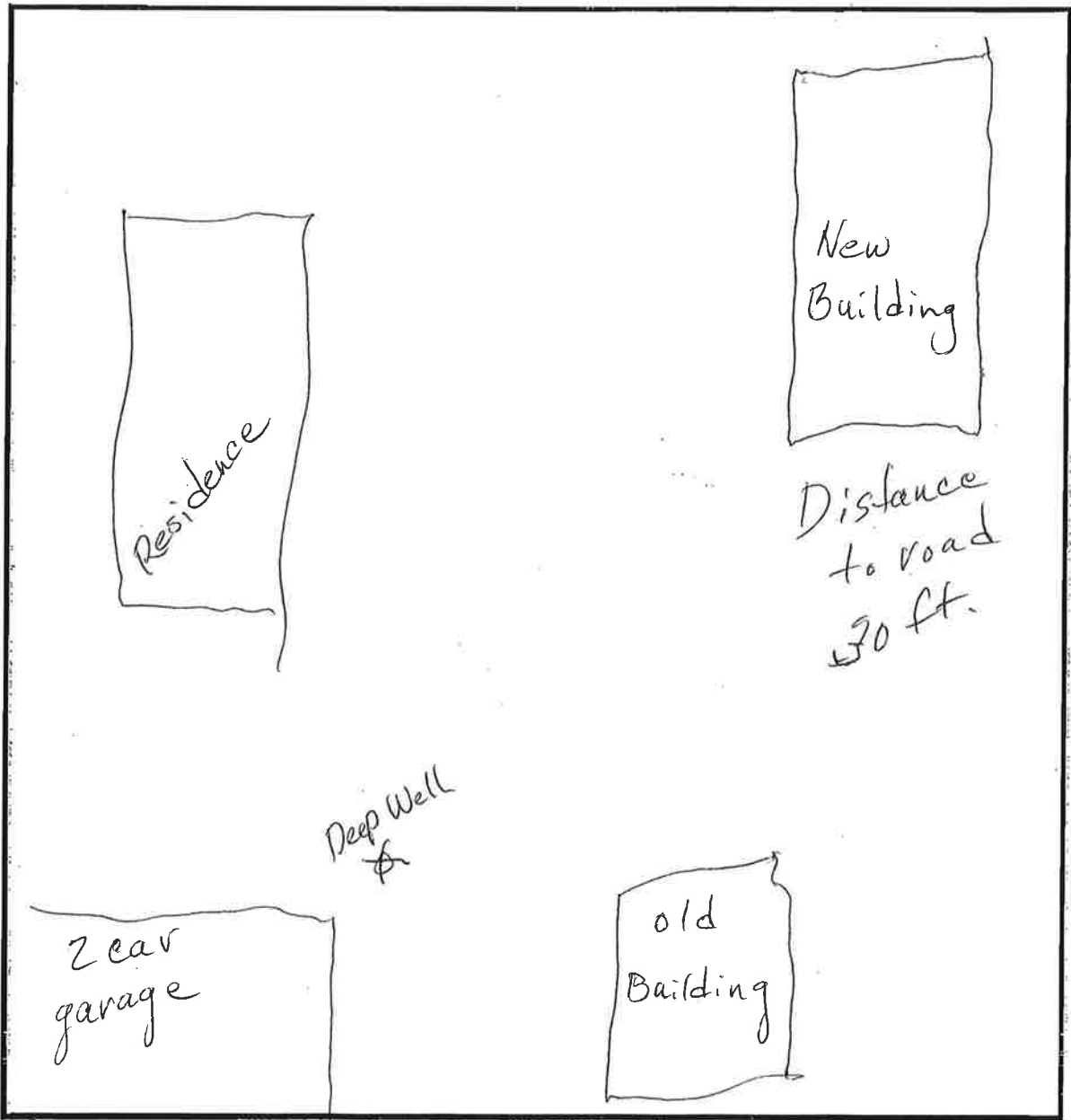



Map may not be valid at this scale.

These data are provided on an "AS-IS" basis, without warranty of any type, expressed or implied, including but not limited to any warranty as to their performance, merchantability, or fitness for any particular purpose.



Date: 5/27/2021

1:3,879
 0 120 240 ft
 1 inch = 323 feet