

Barta



21947 Co. Rd. 3  
Merrifield, MN, 56465  
218-829-9678 or 800-829-5755

Tank Installation Instructions

**Site Conditions**

The site must be accessible for a heavy truck 10.5' wide, 13' height, 28' – 35' long and heavy weight up to 75,000 lbs. Free of items like trees, stumps, sharp objects, construction materials, vehicles, ext. Notified of overhead wires and/or underground wires, gas lines, old tanks ext. trucks must be on flat level ground conditions may vary and might interfere with the delivery or installation 3' to 6' from placement of tank for installing.

**Excavation**

Excavation should be 12" minimum larger than length and width of tank size to allow adequate backfill. Excavation should be level on the bottom so the weight bears on outside of tank walls and 4" greater than invert height to allow proper bedding. This may vary with soil conditions

**Bedding**

Proper bedding material is important to ensure service life of the tanks structure. Bedding must be capable of bearing the weight of a full tank. Bedding material shall have the ability of 100% to be able to pass through ¼ inch screen. Bedding thickness shall be 4" minimum compacted (thickness may vary with existing soil conditions)

**Joint seal**

Mid seam tanks or tanks that need to be set in two pieces need to be cleaned, dried, and properly place according to the manufactures recommendations for models-SCP2400,SCP2450,SCP2250,SCP2500,SCP2800,SCP2850,SCP2950, tanks

**Water Table**

When tanks are being placed where water levels can potentially be higher than the elevation of the tank cover, an alternate location should be considered.

**Backfill material**

Sidewall of tanks require dry backfill materials that have the ability of 100% to be able to pass through a 2" screen and a minimum of 12" on all sides from bottom to top of tank. Backfill material shall be placed to avoid loads on the sidewall of the tank.

**Cover Material**

Cover material shall be dry soil, materials that have the ability of 100% to be able to pass through a 4" screen. Cover material shall be mounded over tank and around risers to direct run-off away from tank and risers.

**Risers**

All risers on tanks should be completely sealed to prevent water from coming in around them into the tank. Sealant used should be placed between the tank and the riser. Sealant should be placed on clean dry surface and full circumference of riser should be placed on the sealant. All sealing of the risers is the responsibility of the installer upon installation and in the future.

**Rubber Boots**

All inlet and outlet pipe should be placed inside the rubber boot and tightened with the clamp provided to ensure a leak proof seal. All inlet and outlet pipe sealing is the responsibility of the installer upon installation and in the future unless the rubber boot or clamp is defective.

**Inlet & Outlet**

Pipe not to exceed 1" past interior wall of tank where baffle is used.

**Burial Depth**

Tanks to be installed to depths according to each model's maximum bury recommendations

Model # 1500 Manufacturers Date 11/14/20  
Gallons 1023/508 Maximum buried depth 6 Ft

**AITKIN COUNTY**  
**CERTIFICATE OF INSTALLATION/~~NOTICE OF NONCOMPLIANCE~~**

This certificate of installation/~~notice of noncompliance~~ has been issued this 23rd day of November, 20 20 to certify compliance/~~noncompliance~~ with Aitkin County's Subsurface Sewage Treatment System Ordinance.

The premises covered by this certificate are legally described as: Lot 25 Lakeshore Acres

Section 23 Township 49 Range 23 Lake Horseshoe  
PERMIT NO. 45691 Owner Name Lowell & Helen Carlen  
Address 485780 173rd PI McGregor, MN 55760  
Installer Name B&T Sales  
Type of System Inspected Type I tank replacement  
Parcel Number 29-1-340600

The certificate of installation/~~notice of noncompliance~~ was based on No 1 of the following:

- 1) Inspection of the installation or construction as in accordance with the above referenced permit and application design.
  
- 2) Review of as-built plans submitted in accordance with Subdivision 9.2 D of Aitkin County's Subsurface Sewage Treatment System Ordinance.

If the above permitted subsurface sewage treatment system is in noncompliance with Aitkin County's Subsurface Sewage Treatment System Ordinance, then the following shall serve as a Notice of Violation:

- 1) Statement of the findings of fact through inspections or investigations:

2) List of specific violations of Ordinance: \_\_\_\_\_

3) Requirements for correction or removal of violations: \_\_\_\_\_

4) Time schedule for compliance: \_\_\_\_\_

Failure to correct or remove the above violation(s) will result in this matter being turned over to the Aitkin County Attorney's Office for further legal action, which may result in revocation of licenses, fines and/or imprisonment.

INSPECTOR SIGNATURE



**SUBSURFACE SEWAGE TREATMENT SYSTEM INSPECTION FORM  
AITKIN COUNTY, MINNESOTA**

Township Shamrock Date of Inspection 11-20-2020 App. Number 2020-006766

Owner Lawell & Helen Carlen Parcel Number 29-1-340600

Project Address 4852A 173rd Pl. Installer B&T Sales

City McGregor Zip Code 55760

New  Repair

**SETBACKS:**

Buildings to tank(s) Access Road > 50'  
Buildings to drainfield Existing D.F.  
Well(s) 50' or 100' > 50'  
Lake/Creek/Wetland > 100'

SEPTIC TANKS: New  Existing

Number of tanks installed 1 Suther Combo  
Liquid capacity and type 1000 precast  
Type of baffle Plastic  
Inspection pipes -  
Manholes size 3 @ 24"  
Manhole to grade Yes  No

PUMPS: New  Existing

Tank capacity and type 500 precast  
Pump manufacturer & model # Wayne SE150  
Horsepower & GPM 5 50 gpm  
Feet of head 12  
Gallons per cycle 100  
Size of discharge line 2"  
Type & location of alarm Mechanical  
Water meter -

DIST. or DROP BOX & TYPE \_\_\_\_\_

**TRENCHES, BEDS, OR GRAVELLESS LEACHFIELD:**

Trench/Bed depth \_\_\_\_\_  
Trench/Bed length \_\_\_\_\_  
Trench/Bed bottom width \_\_\_\_\_  
Trench spacing \_\_\_\_\_  
Drainfield rock below pipe \_\_\_\_\_  
Size of gravelless pipe \_\_\_\_\_  
Depth of backfill \_\_\_\_\_  
Absorption area: square feet \_\_\_\_\_  
lineal feet \_\_\_\_\_

MOUNDS: Existing - CI on file

Percent slope \_\_\_\_\_  
Upslope sand width \_\_\_\_\_  
Downslope sand width \_\_\_\_\_  
Sideslope sand width \_\_\_\_\_  
Drainfield rock below pipe \_\_\_\_\_  
Depth of sand below rock \_\_\_\_\_  
Perforation size & spacing \_\_\_\_\_  
Pipe size & spacing \_\_\_\_\_  
Dimensions of rock bed \_\_\_\_\_  
Dimensions of sand base \_\_\_\_\_  
Final cover \_\_\_\_\_

**DRAWING OF SYSTEM: (include soils)**

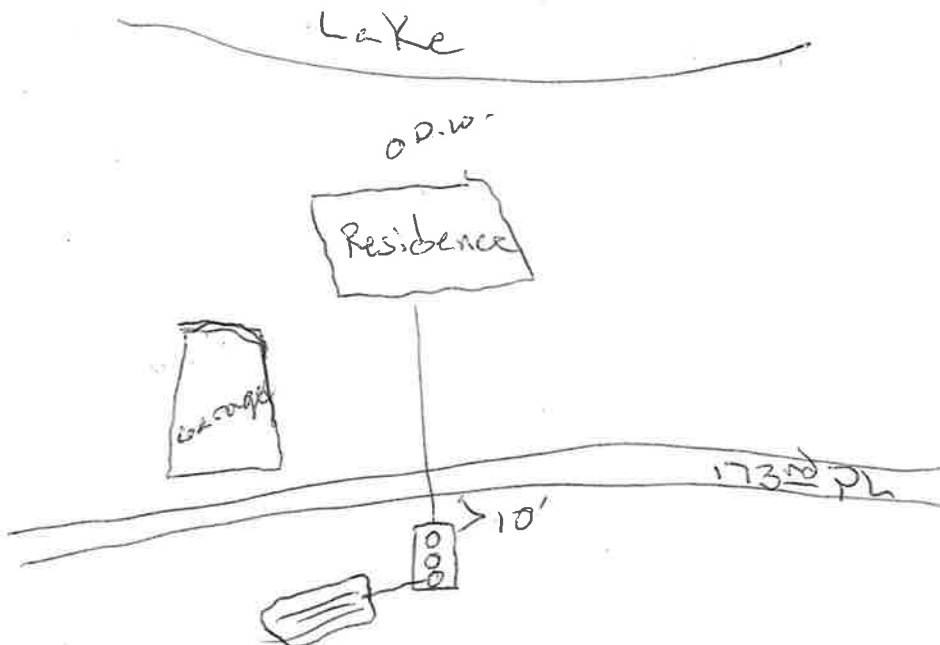

Inspector's Comments: \_\_\_\_\_

Inspector's Signature [Signature]

Installer's Signature \_\_\_\_\_