

AITKIN COUNTY
CERTIFICATE OF INSTALLATION/~~NOTICE OF NONCOMPLIANCE~~

This certificate of installation/~~notice of noncompliance~~ has been issued this 17th day of August, 2020 to certify compliance/~~noncompliance~~ with Aitkin County's Subsurface Sewage Treatment System Ordinance.

The premises covered by this certificate are legally described as: SE-SW

Section 10 Township 49 Range 22 Lake _____
PERMIT NO. 45273 Owner Name Scott & Jessica Paulsen
Address 49994 Kestral Ave. Tamarack, Mn
Installer Name Antonsen Excavating
Type of System Inspected 2 bedroom Type I pressure bed
Parcel Number 10-0-015800

The certificate of installation/~~notice of noncompliance~~ was based on No 1 of the following:

- 1) Inspection of the installation or construction as in accordance with the above referenced permit and application design.

- 2) Review of as-built plans submitted in accordance with Subdivision 9.2 D of Aitkin County's Subsurface Sewage Treatment System Ordinance.

If the above permitted subsurface sewage treatment system is in noncompliance with Aitkin County's Subsurface Sewage Treatment System Ordinance, then the following shall serve as a Notice of Violation:

- 1) Statement of the findings of fact through inspections or investigations:

- 2) List of specific violations of Ordinance: _____

- 3) Requirements for correction or removal of violations: _____

- 4) Time schedule for compliance: _____

Failure to correct or remove the above violation(s) will result in this matter being turned over to the Aitkin County Attorney's Office for further legal action, which may result in revocation of licenses, fines and/or imprisonment.

INSPECTOR SIGNATURE



**SUBSURFACE SEWAGE TREATMENT SYSTEM INSPECTION FORM
AITKIN COUNTY, MINNESOTA**

Township Nauvoo Date of Inspection 2-17-2020 App. Number 2020-006195
 Owner Scott & Jessica Paulsen Parcel Number 12-0-115800
 Project Address 49994 Kestral Ave Installer Antonsen
 City Tamarack Zip Code 55787

New Repair

SETBACKS:

Buildings to tank(s) 26'
 Buildings to drainfield 74'
 Well(s) 50' or 100' _____
 Lake/Creek/Wetland N/A

SEPTIC TANKS: New Existing _____

Number of tanks installed 1 combo Sather
 Liquid capacity and type 1000 precast
 Type of baffle Plastic
 Inspection pipes 1.4" on lift
 Manholes size 3 @ 24"
 Manhole to grade Yes No _____

PUMPS: New Existing _____

Tank capacity and type 500 Precast
 Pump manufacturer & model # Zeller Bn 98
 Horsepower & GPM 15 33 gpm
 Feet of head 16
 Gallons per cycle 75
 Size of discharge line 2"
 Type & location of alarm Buzzer at tank
 Water meter _____

DRAWING OF SYSTEM: (include soils)

DIST. or DROP BOX & TYPE _____

TRENCHES, BEDS, OR GRAVELLESS LEACHFIELD:

Trench/Bed depth 9"
 Trench/Bed length 38'
 Trench/Bed bottom width 12"
 Trench spacing _____
 Drainfield rock below pipe 9"
 Size of gravelless pipe _____
 Depth of backfill 12"
 Absorption area: square feet 380
 lineal feet _____

MOUNDS:

Percent slope _____
 Upslope sand width _____
 Downslope sand width _____
 Sideslope sand width _____
 Drainfield rock below pipe _____
 Depth of sand below rock _____
 Perforation size & spacing 1/4" x 2.5
 Pipe size & spacing 1 1/2" x 2.5
 Dimensions of rock bed _____
 Dimensions of sand base _____
 Final cover _____

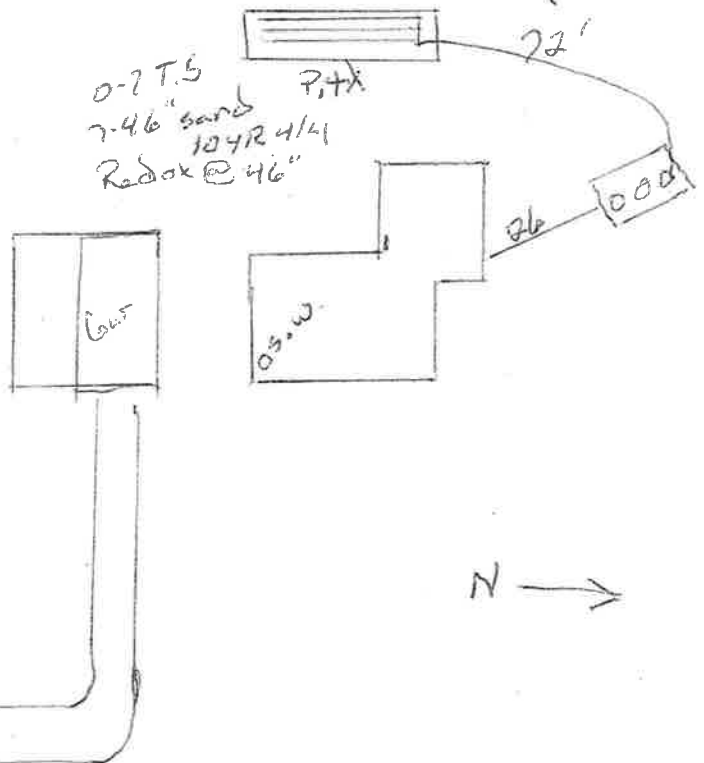

Inspector's Comments: _____

Inspector's Signature [Signature]

Installer's Signature [Signature]



21947 Co. Rd. 3
Merrifield, MN, 56465
218-829-9678 or 800-829-5755

Tank Installation Instructions

Site Conditions

The site must be accessible for a heavy truck 10.5' wide, 13' height, 28' – 35' long and heavy weight up to 75,000 lbs. Free of items like trees, stumps, sharp objects, construction materials, vehicles, ext. Notified of overhead wires and/or underground wires, gas lines, old tanks ext. trucks must be on flat level ground conditions may vary and might interfere with the delivery or installation 3' to 6' from placement of tank for installing.

Excavation

Excavation should be 12" minimum larger than length and width of tank size to allow adequate backfill. Excavation should be level on the bottom so the weight bears on outside of tank walls and 4" greater than invert height to allow proper bedding. This may vary with soil conditions

Bedding

Proper bedding material is important to ensure service life of the tanks structure. Bedding must be capable of bearing the weight of a full tank. Bedding material shall have the ability of 100% to be able to pass through ¼ inch screen. Bedding thickness shall be 4" minimum compacted (thickness may vary with existing soil conditions)

Joint seal

Mid seam tanks or tanks that need to be set in two pieces need to be cleaned, dried, and properly place according to the manufactures recommendations for models-SCP2400,SCP2450,SCP2250,SCP2500,SCP2800,SCP2850,SCP2950, tanks

Water Table

When tanks are being placed where water levels can potentially be higher than the elevation of the tank cover, an alternate location should be considered.

Backfill material

Sidewall of tanks require dry backfill materials that have the ability of 100% to be able to pass through a 2" screen and a minimum of 12" on all sides from bottom to top of tank. Backfill material shall be placed to avoid loads on the sidewall of the tank.

Cover Material

Cover material shall be dry soil, materials that have the ability of 100% to be able to pass through a 4" screen. Cover material shall be mounded over tank and around risers to direct run-off away from tank and risers.

Risers

All risers on tanks should be completely sealed to prevent water from coming in around them into the tank. Sealant used should be placed between the tank and the riser. Sealant should be placed on clean dry surface and full circumference of riser should be placed on the sealant. All sealing of the risers is the responsibility of the installer upon installation and in the future.

Rubber Boots

All inlet and outlet pipe should be placed inside the rubber boot and tightened with the clamp provided to ensure a leak proof seal. All inlet and outlet pipe sealing is the responsibility of the installer upon installation and in the future unless the rubber boot or clamp is defective.

Inlet & Outlet

Pipe not to exceed 1" past interior wall of tank where baffle is used.

Burial Depth

Tanks to be installed to depths according to each models maximum bury recommendations

Model # 41500 Manufacturers Date 8-3-20

Gallons 1025, 504 Maximum buried depth 4 Ft