



Minnesota Pollution Control Agency

520 Lafayette Road North
St. Paul, MN 55155-4194

Compliance Inspection Form

Existing Subsurface Sewage Treatment Systems (SSTS)

Doc Type: Compliance and Enforcement

Inspection results based on Minnesota Pollution Control Agency (MPCA) requirements and attached forms – additional local requirements may also apply.

Submit completed form to Local Unit of Government (LUG) and system owner within 15 days

For local tracking purposes:

System Status

System status on date (mm/dd/yyyy): 7/11/2019

Compliant – Certificate of Compliance
(Valid for 3 years from report date, unless shorter time frame outlined in Local Ordinance.)

Noncompliant – Notice of Noncompliance
(See Upgrade Requirements on page 3.)

Reason(s) for noncompliance (check all applicable)

- Impact on Public Health (Compliance Component #1) – Imminent threat to public health and safety
- Other Compliance Conditions (Compliance Component #3) – Imminent threat to public health and safety
- Tank Integrity (Compliance Component #2) – Failing to protect groundwater
- Other Compliance Conditions (Compliance Component #3) – Failing to protect groundwater
- Soil Separation (Compliance Component #4) – Failing to protect groundwater
- Operating permit/monitoring plan requirements (Compliance Component #5) – Noncompliant

Property Information

Parcel ID# or Sec/Twp/Range: 24-0-048700

Property address: 34002 290th St Aitkin MN 56431 Reason for inspection: Permit

Property owner: Kenneth Zuehlsdorff Owner's phone: 952-496-1170

Owner's representative: Kerry Zuehlsdorff Representative phone: 952-686-3381

Local regulatory authority: Aitkin Co Regulatory authority phone: 218-927-7342

Brief system description: Gravity to a 1350 Prinz Tank, gravity to 2 drop boxes and 2 trenches each 65' long, 6" rock under pipe.

Comments or recommendations:

Clean-out near shed. Manhole and inspection pipe for tank raised to surface, both baffles in-place, Working Level OK. Owner states they pump tank every 2 years. Both dropboxes have inspection pipes to surface, also inspection pipes at trench terminal ends. There is no evidenced of ponding, surfacing or backing up.

Certification

I hereby certify that all the necessary information has been gathered to determine the compliance status of this system. No determination of future system performance has been nor can be made due to unknown conditions during system construction, possible abuse of the system, inadequate maintenance, or future water usage.

Inspector name: Jeff Brummer Certification number: C-3589

Business name: Brummer Septic LLC. License number: L-1347

Inspector signature: Phone number: 218-821-0704

Necessary or Locally Required Attachments

- Soil boring logs
- System/As-built drawing
- Forms per local ordinance
- Other information (list): MN Well Index

1. Impact on Public Health – Compliance component #1 of 5

Compliance criteria:

System discharges sewage to the ground surface.	<input type="checkbox"/> Yes <input checked="" type="checkbox"/> No
System discharges sewage to drain tile or surface waters.	<input type="checkbox"/> Yes <input checked="" type="checkbox"/> No
System causes sewage backup into dwelling or establishment.	<input type="checkbox"/> Yes <input checked="" type="checkbox"/> No

Any "yes" answer above indicates the system is an imminent threat to public health and safety.

Comments/Explanation:

Verification method(s):

- Searched for surface outlet
- Searched for seeping in yard/backup in home
- Excessive ponding in soil system/D-boxes
- Homeowner testimony (See Comments/Explanation)
- "Black soil" above soil dispersal system
- System requires "emergency" pumping
- Performed dye test
- Unable to verify (See Comments/Explanation)
- Other methods not listed (See Comments/Explanation)

2. Tank Integrity – Compliance component #2 of 5

Compliance criteria:

System consists of a seepage pit, cesspool, drywell, or leaching pit. <i>Seepage pits meeting 7080.2550 may be compliant if allowed in local ordinance.</i>	<input type="checkbox"/> Yes <input checked="" type="checkbox"/> No
Sewage tank(s) leak below their designed operating depth. If yes, which sewage tank(s) leaks:	<input type="checkbox"/> Yes <input checked="" type="checkbox"/> No

Any "yes" answer above indicates the system is failing to protect groundwater.

Comments/Explanation:

Manhole raised, both baffles inplace, Working Level OK.

Verification method(s):

- Probed tank(s) bottom
- Examined construction records
- Examined Tank Integrity Form (Attach)
- Observed liquid level below operating depth
- Examined empty (pumped) tanks(s)
- Probed outside tank(s) for "black soil"
- Unable to verify (See Comments/Explanation)
- Other methods not listed (See Comments/Explanation)

3. Other Compliance Conditions – Compliance component #3 of 5

- a. Maintenance hole covers are damaged, cracked, unsecured, or appear to be structurally unsound. Yes* No Unknown
- b. Other issues (electrical hazards, etc.) to immediately and adversely impact public health or safety. Yes* No Unknown
***System is an imminent threat to public health and safety.**

Explain:

- c. System is non-protective of ground water for other conditions as determined by inspector. Yes* No
***System is failing to protect groundwater.**

Explain:

4. Soil Separation – Compliance component #4 of 5

Date of installation: 6/5/2007 Unknown
(mm/dd/yyyy)

Shoreland/Wellhead protection/Food beverage lodging? Yes No

Compliance criteria:

For systems built prior to April 1, 1996, and not located in Shoreland or Wellhead Protection Area or not serving a food, beverage or lodging establishment: Yes No

Drainfield has at least a two-foot vertical separation distance from periodically saturated soil or bedrock.

Non-performance systems built April 1, 1996, or later or for non-performance systems located in Shoreland or Wellhead Protection Areas or serving a food, beverage, or lodging establishment: Yes No

Drainfield has a three-foot vertical separation distance from periodically saturated soil or bedrock.*

“Experimental”, “Other”, or “Performance” systems built under pre-2008 Rules; Type IV or V systems built under 2008 Rules (7080.2350 or 7080.2400 (Advanced Inspector License required) Yes No

Drainfield meets the designed vertical separation distance from periodically saturated soil or bedrock.

Any “no” answer above indicates the system is failing to protect groundwater.

Verification method(s):

Soil observation does not expire. Previous soil observations by two independent parties are sufficient, unless site conditions have been altered or local requirements differ.

- Conducted soil observation(s) (Attach boring logs)
- Two previous verifications (Attach boring logs)
- Not applicable (Holding tank(s), no drainfield)
- Unable to verify (See Comments/Explanation)
- Other (See Comments/Explanation)

Comments/Explanation:

Dug soil pit with mini ex.

Indicate depths or elevations

A. Bottom of distribution media	Elv. = 96.4'
B. Periodically saturated soil/bedrock	Below Elv.= 93.3
C. System separation	36"
D. Required compliance separation*	36"

*May be reduced up to 15 percent if allowed by Local Ordinance.

5. Operating Permit and Nitrogen BMP* – Compliance component #5 of 5 Not applicable

Is the system operated under an Operating Permit? Yes No **If “yes”, A below is required**

Is the system required to employ a Nitrogen BMP? Yes No **If “yes”, B below is required**

BMP = Best Management Practice(s) specified in the system design

If the answer to both questions is “no”, this section does not need to be completed.

Compliance criteria

- a. Operating Permit number: _____
Have the Operating Permit requirements been met? Yes No
- b. Is the required nitrogen BMP in place and properly functioning? Yes No

Any “no” answer indicates Noncompliance.

Upgrade Requirements (Minn. Stat. § 115.55) An imminent threat to public health and safety (ITPHS) must be upgraded, replaced, or its use discontinued within ten months of receipt of this notice or within a shorter period if required by local ordinance. If the system is failing to protect ground water, the system must be upgraded, replaced, or its use discontinued within the time required by local ordinance. If an existing system is not failing as defined in law, and has at least two feet of design soil separation, then the system need not be upgraded, repaired, replaced, or its use discontinued, notwithstanding any local ordinance that is more strict. This provision does not apply to systems in shoreland areas, Wellhead Protection Areas, or those used in connection with food, beverage, and lodging establishments as defined in law.

{ Inspection Drawing }

Property Owner: Kenneth Zuehlsdorff Date: 7/10/2019 Designer's Initials: JB
 Parcel ID. Number: 24-0-048700 Address: 34002 290th St. Aitkin MN 56431
 Aitkin Co. One Inch = 40ft.'

Drainfield As/built was confirmed and used for parts of this inspection

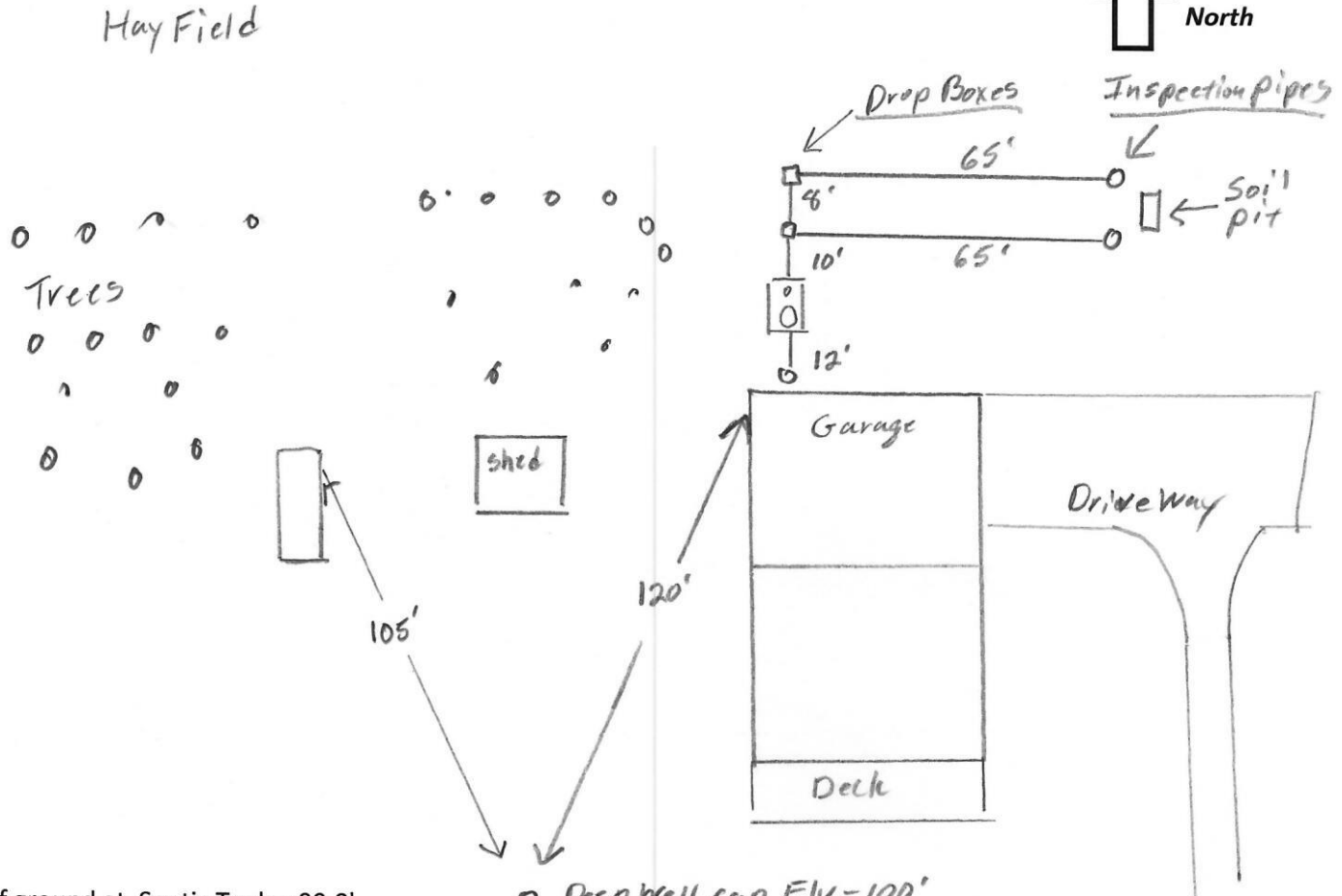

Elv. Of ground at Septic Tank = 99.8'
 Inlet Septic Tank Elv. = 98'
 Outlet of Septic Tank Elv. = 97.8'
 Inlet 1st Drop Box Elv. = 97.7'
 Bench Mark Elv. = 100' Top of Deep Well Cap
 Ground at well Elv. = 98.2'
 Elv. Of grade near East Inspection Pipes Elv. = 98.9'
 Elv. Of bottom of rock Elv. = 96.4'
 18" cover + 12" rock = 30" or 2.5'

o Deep Well cap ELV = 100'

SB -	1	Top of Ground Soil Pit	Elv. = 98.9'
Depth (in.)		Texture	Color
0 - 8		Top Soil/loam	10YR3/2
8 - 20		Sandy Loam	10YR5/4
20 - 55		Med Sand	7.5YR4/4
55 - 68		Med Sand	10YR4/4

Elv. **93.3'**

SB -		Top of Ground	Elv.
Depth (in.)		Texture	Color

Please show all that apply (Existing)

- Wells within 100ft. Of Drain field.
- Water lines within 10 ft. of Drain field.
- Drain field Areas:

Please Draw to Scale with North to Top or Left Side of Page:

- | | |
|---------------------------|-----------------------------------|
| Disturbed/Compacted Areas | Access Route for Tank Maintenance |
| Component Location | Property Lines |
| OHW ordinary high water | Structures |
| Lot Easements | Setbacks |



Minnesota Well Index

General Information

Unique Well ID:	753470	Well Name:	NORTHBURG, RICH	County:	Aitkin	Aquifer:	Quat. buried artes. aquifer
Well Elevation (msl in feet):	1300	Drilled Depth (ft):	111	Well Completed (ft):	111	Date Drilled:	06/14/2007
Township:	46	Range:	26	Dir:	W	Section:	29
Subsection:	ACDADA	Use:	domestic	Well Status:	Active	Depth To Bedrock:	
Driller:	Hasskamp Bros. Well Drilling	Entry Date:		Update Date:	06/13/2018		

Related Resources:

[Go to MN Well Index Map](#)
 [Well Log Report](#)
 [Scanned Record\(s\)](#)
 [Stratigraphy Report](#)

[More Details](#)
 [Stratigraphy](#)
 [Address](#)
 [Chemical Data](#)
 [Construction](#)
 [Pump Test](#)
 [Static Water](#)
 [Comments](#)

[Location Changes](#)
 [Overview Map](#)

Description	From(ft)	To(ft)	Color	Hardness	Lith Primary	Lith Secondary	Interpretation
GRAVEL	0	25	BROWN	MEDIUM	GRVL		gravel (+larger)-brown
CLAY & SAND	25	85	BROWN	SOFT	CLAY		clay+sand-brown
CLAY & ROCKS	85	98	BROWN	MEDIUM	CLAY		pebbly sand/silt/clay-brown
LEDGE ROCK	91	111	RED	MEDIUM	BLDR		boulder or boulders



Detailed Parcel Report

Parcel Number: 24-0-048700

General Information

Township/City: NORDLAND TWP
 Taxpayer Name: ZUEHLSDORFF, KENNETH & MARLENE
 Taxpayer Address: 1772 BOULDER POINTE
 SHAKOPEE MN 55379
 Property Address: 34002 290TH ST *aitkin Mn 56431*
 Township: 46 Lake Number: 0
 Range: 26 Lake Name:
 Section: 25 Acres: 39.00
 Green Acres: No School District: 1.00
 Plat:
 Brief Legal Description: SE SE LESS W33 FT

Tax Information

Class Code 1: Non-Homestead Qualifying Single Res Unit
 Class Code 2: Non-Homestead Agricultural Land
 Class Code 3: Non-Homestead Agricultural Land
 Homestead: Non Homestead
 Assessment Year: 2019

Estimated Land Value:	\$74,700.00
Estimated Building Value:	\$123,200.00
Estimated Total Value:	\$197,900.00
Prior Year Total Taxable Value:	\$201,200.00
Current Year Net Tax (Specials Not Included):	\$1,552.00
Total Special Assessments:	\$0.00
**Current Year Balance Not Including Penalty:	\$776.00
Delinquent Taxes:	No

* For more information on delinquent taxes, please call the Aitkin County Treasurer's Office at 218-927-7325.

** Balance Due on a parcel does not include late payment penalties.