

INQPCL-1
Data Set: PRD Production

Parcel Description

4/26/19
08:29:11

Parcel/Acct : 20-0-049900	19116	Asmt/Tax year: 2019 2020	
Pri. owner : 26485	Undl Tax Adr: N	State UTA . . .	21 2 00 Type: RE
HOLM, CHARLES		Unit . . .	Hold tax stmt:
Taxpayer . . .	26485 FALCO: 1 F.O.	Emergency # . . .	Lease Type:
HOLM, CHARLES		Escrow . . .	
Ref. parcel : 00220000049900		Surveyed . . .	Notes :
Lake #/Name :		Com district: 5	UDI . . : 100.00%
Physical adr: 59175 Osprey Ave		MH court nbr:	Billing: P
SWATARA 55785		TIF district:	KD:
Acres :	40.00	User defined:	
Lot/Block . . :		UTA-Twp/City: 20	MACVILLE TWP
Plat/Desc . . :		School . . . :	2 HILL CITY
Sec/Twp/Rge : 30 51.0 26		AMBU *****	*****
Description : SE OF SE		00 00 00 00	
			<--Version: 1

Press Enter to continue or enter new parcel/tax year: 20-0-049900 2020
F1=Help F2=Trans History F3=Exit
F6=Parcel History F7=Name/Addresses F8=Legal F24=More keys

FIELD EVALUATION SHEET

Sewer Sites for
Property Split

PRELIMINARY EVALUATION DATE April 30, 2019, FIELD EVALUATION DATE April 30, 2019
PROPERTY OWNER: Charles Helm (Tim Hanson Rep.) PHONE 218-393-3514
ADDRESS: 59175 Osprey Ave. CITY, STATE, ZIP: Swatara, Moa 55785
LEGAL DESCRIPTION: _____
PIN# 20-0-049900 SEC. 30 T. 51 R. 26 TWP NAME Macville
FIRE# _____ LAKE/RIVER _____ LAKE CLASS _____ OHWL _____ FT.

DESCRIPTION OF SOIL TREATMENT AREAS

	AREA #1	AREA #2	REFERENCE BM ELEV. _____ FT.
DISTURBED AREAS	YES _____ NO <u>X</u>	YES _____ NO <u>X</u>	REFERENCE BM DESCRIPTION _____
COMPACTED AREAS	YES _____ NO <u>X</u>	YES _____ NO <u>X</u>	_____
FLOODING	YES _____ NO <u>X</u>	YES _____ NO <u>X</u>	_____
RUN ON POTENTIAL	YES _____ NO <u>X</u>	YES _____ NO <u>X</u>	_____
SLOPE %	<u>6</u>	<u>6</u>	_____
DIRECTION OF SLOPE	<u>North</u>	<u>North</u>	_____
LANDSCAPE POSITION	<u>E-W</u>	<u>E-W</u>	_____
VEGETATION TYPES	<u>Hay field</u>		_____

DEPTH TO STANDING WATER OR MOTTLED SOIL: BORING# 1 20", 1A 20", 2 20", 2A 20"

BOTTOM ELEVATION—FIRST TRENCH OR BOTTOM OF ROCK BED: #1 _____ FT., #2 _____ FT.

SOIL SIZING FACTOR: SITE #1 1eb.7, SITE #2 1eb.7

CONSTRUCTION RELATED ISSUES: Follow contour of land allow them to be Sites can be relocated if soils

LIC# L2132 SITE EVALUATOR SIGNATURE: Tom O'Neil

SITE EVALUATOR NAME: Tom O'Neil TELEPHONE# 218-927-6070

LUG REVIEW _____ DATE _____

Comments: _____

SOIL BORING LOGS ON REVERSE SIDE

North

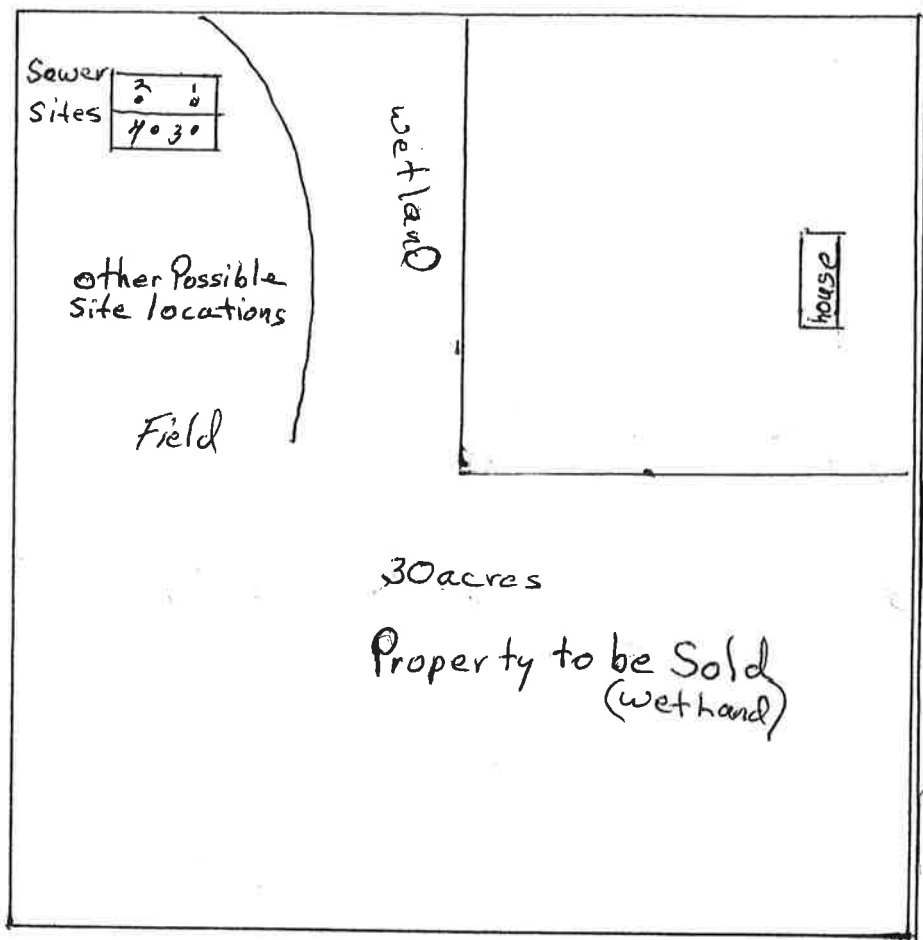

Should be other Sewer Sites available on this property depending on the location of any buildings that will be built. Existing sites will probably be mounds. The farther up the hill will possibly be inground systems

Sprey Ave. County Road 29

SOILS DATA

DEPTH (INCHES)	TEXTURE	MUNSELL COLOR
0-4	loam	10yr 3/2
4-12	Sandy loam	10yr 4/3
12-20	Fine Sand	10yr 4/4-4/6

no mottles found at these depths

SOILS DATA

DEPTH (INCHES)	TEXTURE	MUNSELL COLOR
0-4	loam	10yr 3/2
4-10	Sandy loam	10yr 4/3
10-21	Fine Sand	10yr 4/4

SOILS DATA

DEPTH (INCHES)	TEXTURE	MUNSELL COLOR
0-5	loam	10yr 3/2
5-10	Sandy loam	10yr 4/3
10-21	Fine-Med Sand	10yr 4/4

SOILS DATA

DEPTH (INCHES)	TEXTURE	MUNSELL COLOR
0-4	loam	10yr 3/2
4-9	Sandy loam	10yr 4/3
9-20	Fine-Med Sand	10yr 4/4-4/6