

AITKIN COUNTY BUILDING PERMIT SITE PLAN

Please indicate the location of: Wells, well setback to system components, buildings, septic system components, reserved septic system area, property lines, waterways, and buried lines. Include size, length, and appropriate distances from fixed reference points. Provide a North directional arrow!

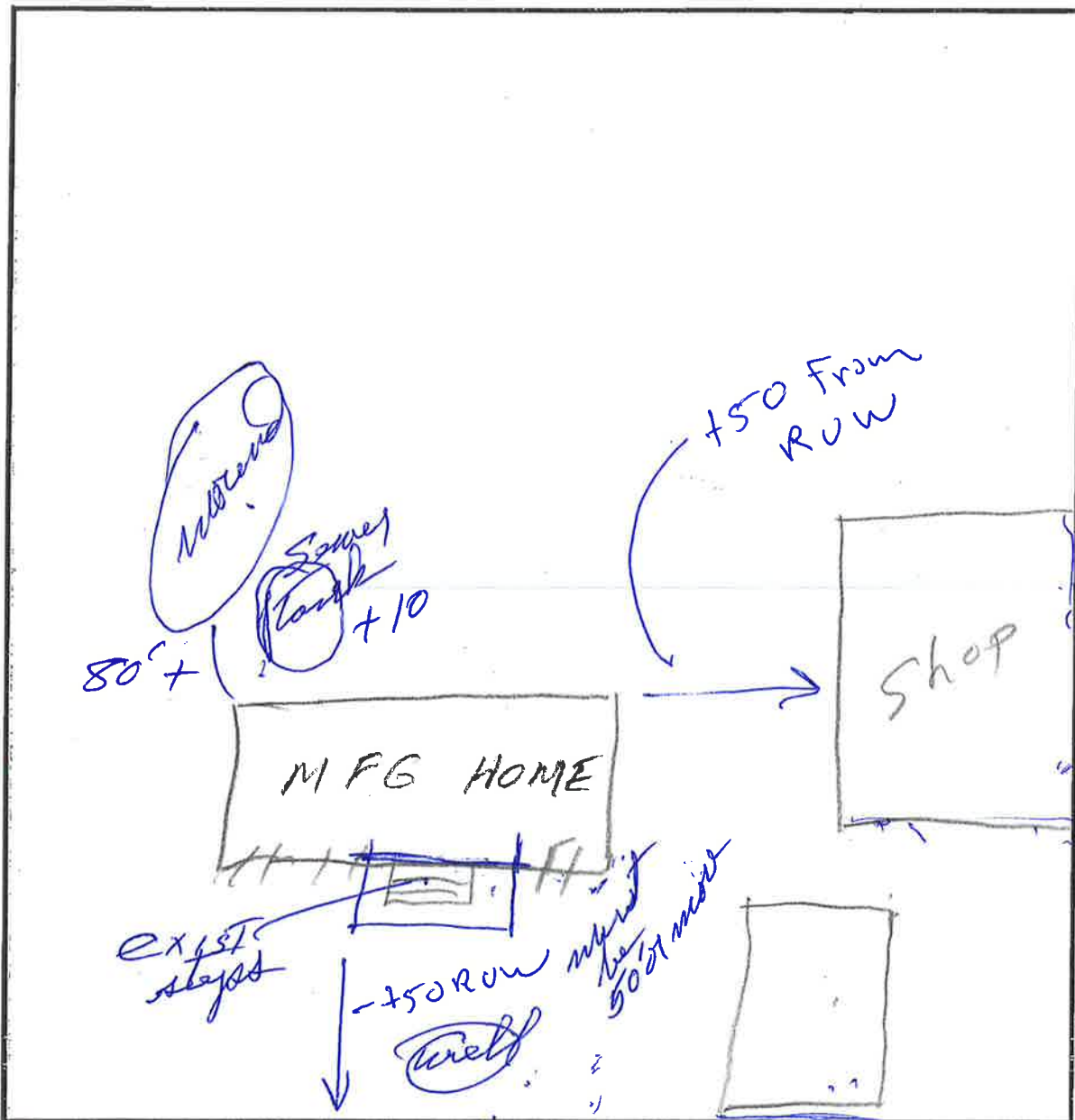

These data are provided on "as-is" basis and are not intended to be used for any purpose other than the general information provided. No warranty is made as to the accuracy or completeness of the information. Any particular purpose is not intended to be used for any purpose other than the general information provided.



15012 St Hwy 27 County Aerial





Roof 2x4 16" oc
 floor 2x8 16" oc
 3/4" floor T&G
 walls 2x4 16" oc
 4x4 Post on loading blocks
 siding ?
 mat 1 door 5/8" 4x8 sheets

comb. window
 storm door



**proposed enclosed porch to be roughly 8x24 ft
with steps to be moved to front**

*Sob
Altrichter*