

\* No Vegetation removed \*

\* Scale 1" = 8'

DPG - Dwarf Pampas Grass  
 GBS - Globe Blue Spruce  
 SVH - Strawberry Vanilla Hydrangea  
 KO - Double Knock Out Shrub Rose  
 TG - Twister Grass

**Villa**  
 LANDSCAPES  
 The Design, Build & Maintain of Your Dream

OAKDALE  
 Main Office  
 6348 Hwy. 36, Suite 3  
 Oakdale, MN 55128  
 (651) 773-7440  
 (651) 773-7441 fax

Deft and Deb Gorham  
 83363 US 5th Ave.  
 Atkin MN 56431  
 612-350-1598

Designer: STEG  
 Smedley  
 Drawn: GST-887-8885  
 Dated: \_\_\_\_\_  
 Revised: 5/25/17

Scale  
 1" = 8'

North

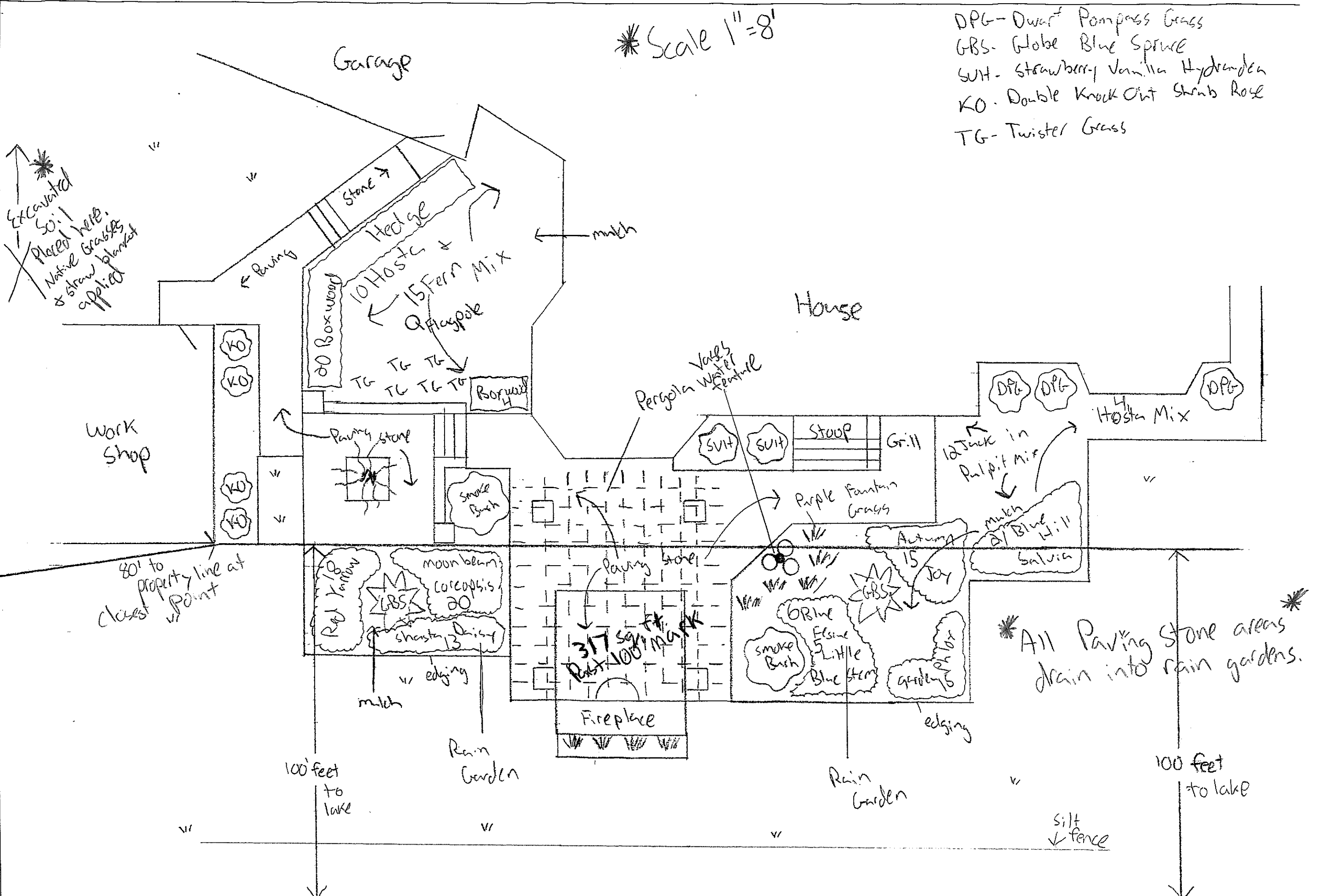

\* All Paving Stone areas drain into rain gardens.