

SKETCH SHEET & SOIL BORING LOG

SITE ADDRESS: 43292 325th Place PARCEL #: 08-1-077300
Palisade, MN. 56469

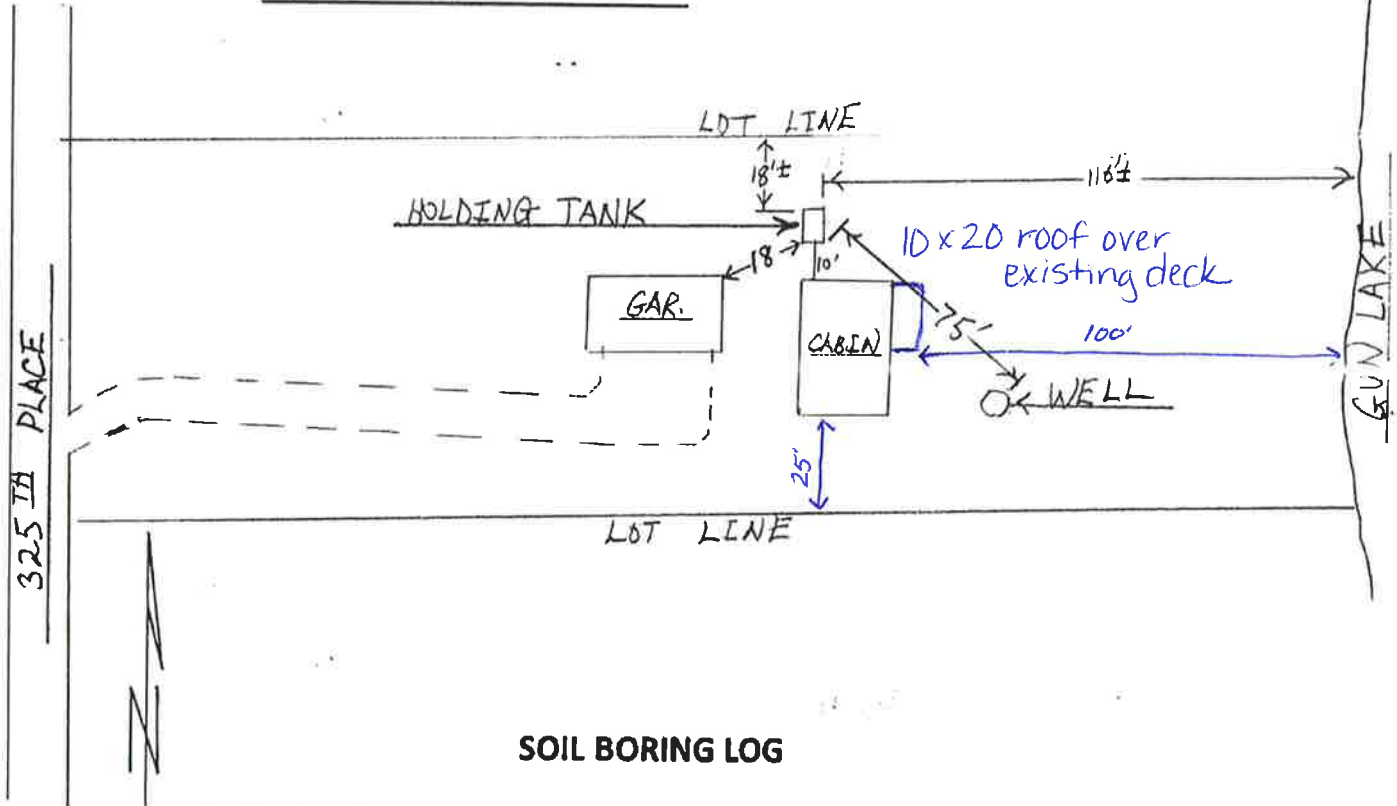

SOIL BORING LOG

Soil Boring #1			Soil Boring #2		
Depth	Texture	Munsell Color	Depth	Texture	Munsell Color

NO SOIL BORINGS DONE / HOLDING TANK

COMPANY: Goble's Sewer Service, Inc. MPCA License # L455

INSPECTOR: Charles J. Virginia Cert. #: C4023

Signature: *Charles J. Virginia*

8/10/2016