

FIELD EVALUATION SHEET

NAME RADERMACHER, D & ALTMAN, J PERMIT # 2016-000504
 PARCEL # 25-0-018200 TWP 44-23 SECTION 12

CHECK THE FOLLOWING PRIOR TO INSPECTION

B. Hargrave NAME OF SITE EVALUATOR
 _____ NAME OF DESIGNER
 _____ NAME OF INSTALLER

- LOT OF RECORD BEFORE 1-21-92 (SL) IR 1-10-95 (NSL), IF NO, ALT.SITE? _____
- _____ SITE PLAN WITH SETBACK DISTANCES AND DIMENSIONS
- _____ ARE ISTS SITES PROTECTED FROM DAMAGE? IF NOT, WHEN _____
- _____ DESIGN _____ PERC TESTS _____ SOIL BORINGS, 2 PER SITE
- _____ NUMBER OF BEDROOMS (INCLUDE POTENTIAL)
- _____ CROSS SECTION SHEET _____ TRENCH DESIGN SHEET
- _____ MOUND DESIGN SHEET _____ OTHER OR PERFORM.
- _____ PRESSURE DISTRIBUTION SHEET _____ PUMP CALC. TEST
- _____ WATER USE CALCULATIONS _____
- _____ GARBAGE DISPOSAL _____ HOT TUB
- _____ EASEMENTS ON LOT, IS ROAD PUBLIC OR PRIVATE SEE DEED/PLAT
- _____ NATURAL LANDSCAPE PROTECTION PLAN

STAKING: BUILDINGS _____, DRAINFIELD _____, BORINGS _____, WELL _____
 BUILDING SETBACKS: ROAD _____, SIDE _____, REAR _____, BLUFF _____,
 LAKE/RIVER _____

COMPLETE DURING SITE EVALUATION
 BUILDINGS STAKED _____ DRAINFIELD STAKED _____ BORINGS STAKED _____
 _____ WELL STAKED

SETBACKS (MEASURE DISTANCE)

	<u>DRAINFIELD</u>	<u>HOUSE</u>
FLOOD PLAIN	YES/NO	YES/NO
WETLANDS	YES/NO	YES/NO
LAKE, RIVER, PROTECTED WATERS	_____	_____
ROAD RIGHT OF WAY	_____	_____
BLUFF	_____	_____
SIDE LOT LINE	_____	_____
REAR LOT LINE	_____	_____
HOUSE OR OTHER STRUCTURE	_____	_____
WELL	_____	_____
EASEMENTS	_____	_____
NEIGHBORING WELL (S) TO ISTS	(1) _____ (2) _____	(3) _____ (4) _____
DRAINFIELD AREA DISTURBED	_____	_____

see site plan + aerial photo.

CONFORMING SEPTIC SYSTEM: YES _____ NO If no, list reasons below.
 COMMENTS OR PROBLEMS (drainage, swales, wetlands, need gutters, etc.)
Site inspection done by GIS analysis.

APPROVED: YES OR NO

INSPECTORS NAME Bryan Hargrave DATE 7/4/2016 # PICTURES _____

SOIL BORING LOGS AND SKETCH PLAN ON REVERSE SIDE

Brutus 18
218-927-7342

Kristy

Permit #17500
Last #613

Street Information
City, State, Zip, Elevation
City, State, Zip

Job No.
Sales Representative Name
City, State, Zip

Storage Yard
City, State, Zip
City, State, Zip

Hancock Office & Plant
City, State, Zip

Central Office & Plant
City, State, Zip

Bill Aufderheide
City, State, Zip
City, State, Zip

Minneapolis Office
5275 Cedar Industrial Boulevard
Minneapolis, MN 55412-2117
(952) 837-2420

Brian Walter
Director of Engineering
Cell # (320) 815-5827
Rick Langguth
Sales Representative
Southwest/Metro
Cell # (320) 760-1260

Jim Looney
Director of Marketing/Sales
Cell # (320) 760-5475

Canon Falls Office & Plant
(952) 261-9210



17 Atlantic Avenue, Hancock, MN 58244
(320) 392-5207 Fax: (320) 392-5155
www.hancockconcrete.com

Scan

PROJECT

15884 BIRCH ST

DATE

8/22/12

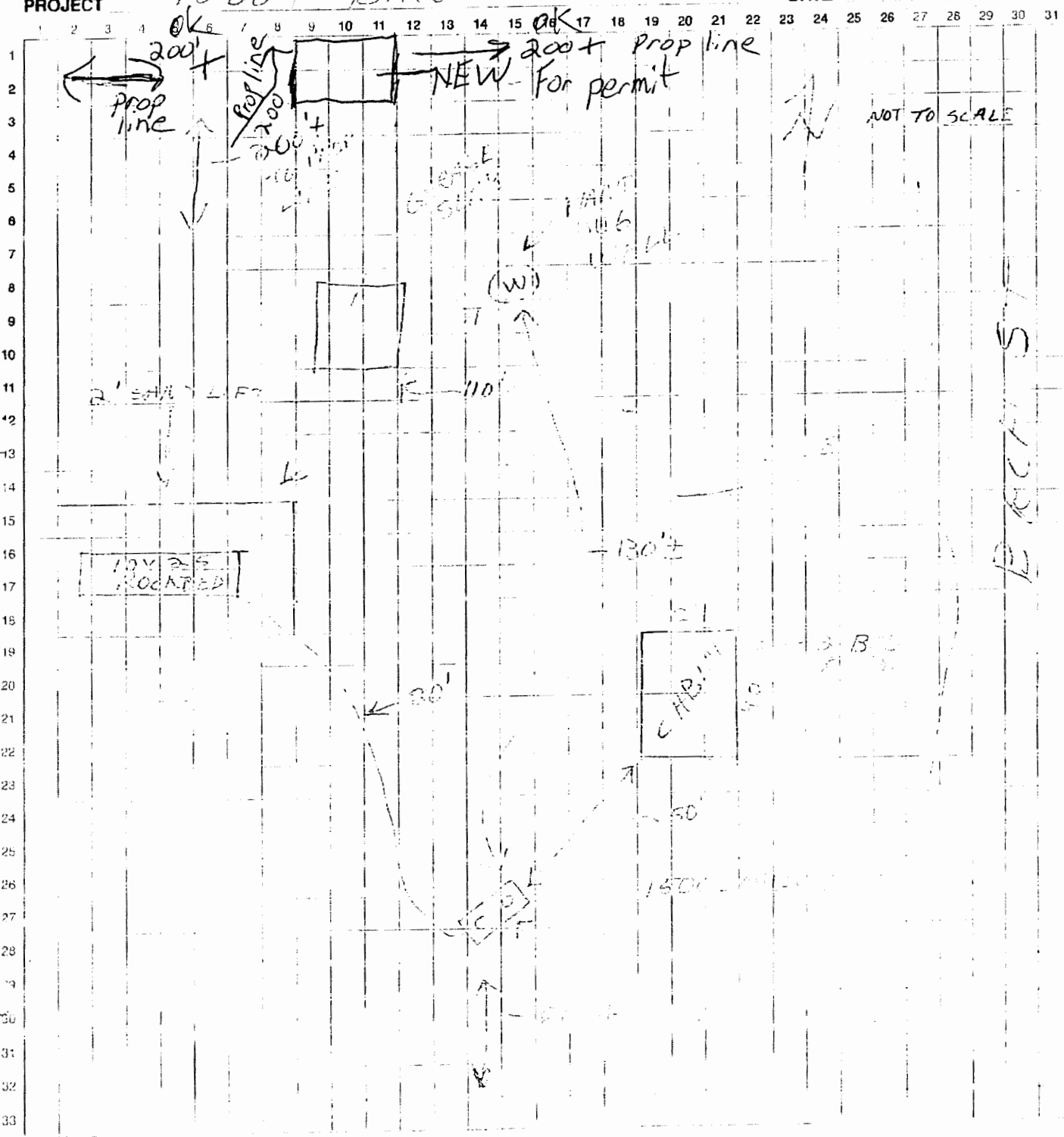



Proposed 32' X 48' pole bldg

BIRCH ST