

HOLDING TANK REPLACEMENT DESIGN

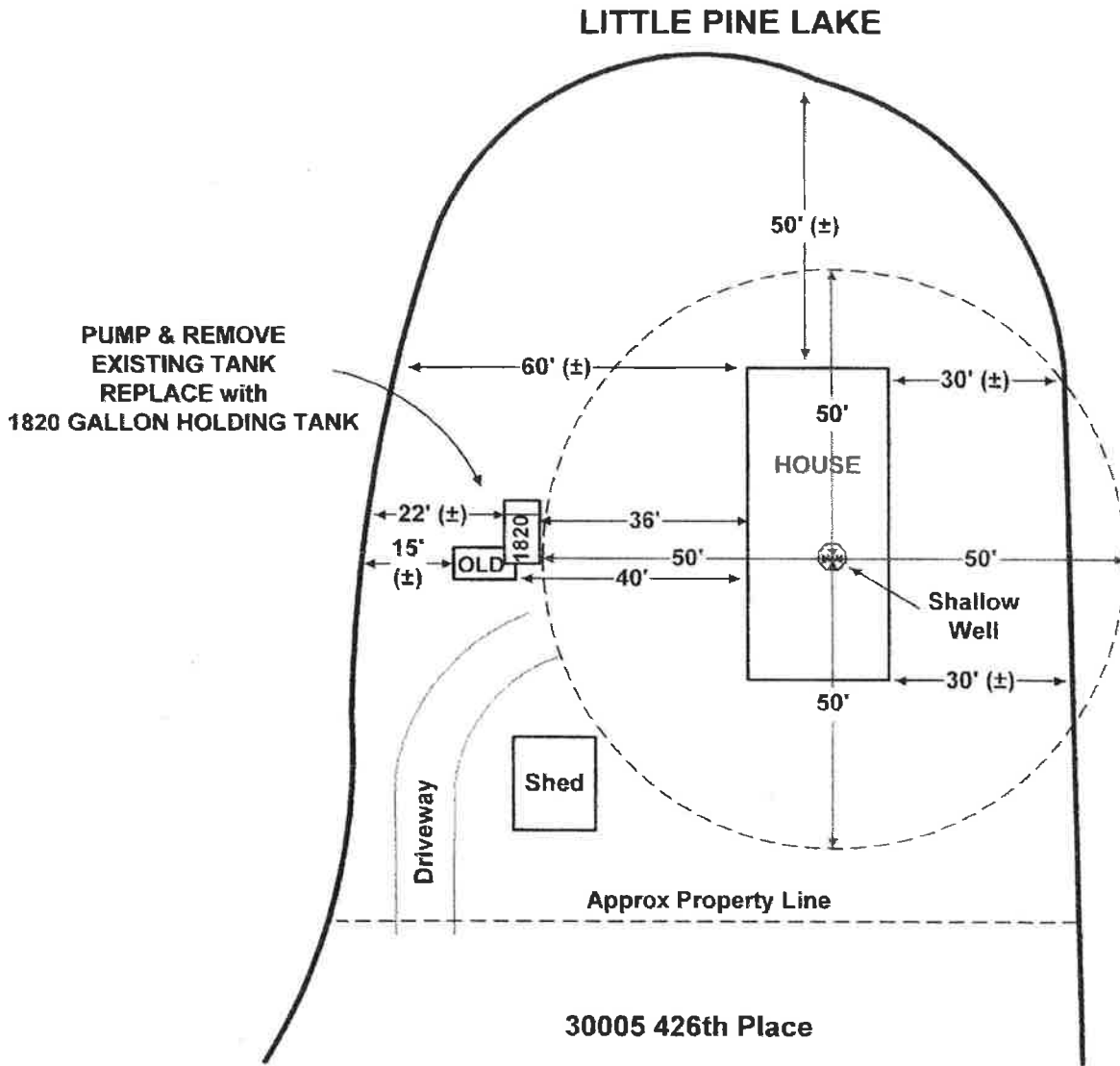

Scale: 1" = 30'

HOLDING TANK PUMPING SERVICE AGREEMENT

Permit # _____ Address 30005 426TH PL

THIS AGREEMENT, entered into by and between Aitkin County Registered Septic Tank Pumper, Gobles Sewer Service hereinafter referred to as "Contractor", and JOSEPH J THEIS, hereinafter referred to as "Homeowner".

WHEREAS, Homeowner desires and is required to retain individual sewage treatment system holding tank services to protect the environment and to obtain a certificate of compliance from Aitkin County; and

WHEREAS, the Contractor desires to provide sewage treatment system pumping services to Homeowner as necessary and in accordance with the terms and conditions outlined herein.

NOW THEREFORE, in consideration of the mutual promises contained herein, Parties do hereby agree as follows:

1. **TERM.** The term of this Agreement shall be from 6/6/2016 to final installation of an Aitkin County approved sewage treatment system or connection to a Municipal Sewage Treatment System, unless earlier terminated as provided herein. The parties understand and agree that this Agreement is intended to arrange for the provision of pumping services so that Homeowner may occupy the home pursuant to a certificate of compliance to be issued by the Aitkin County Environmental Services Department upon execution of this Agreement. Homeowner further agrees that at the earliest possible date, Homeowner shall have a permanent sewage treatment system installed in accordance with the Aitkin County Individual Sewage Treatment System and Wastewater Ordinance No.1 and as approved by the Aitkin County Environmental Services Department or connect to a Municipal Sewage Treatment System. Upon approval by the County of Aitkin of the individual sewage treatment system or connection to a municipal sewer, or approval by Aitkin County Environmental Services of an amended or different contract, this Agreement shall terminate.

2. **FREQUENCY OF PUMPING.** Homeowner agrees that he/she shall not allow the holding tank to overflow or discharge in any manner. Contractor and Homeowner agree that the holding tank shall be pumped in accordance with the following:

- Tank size (gal.) _____ / (number of household occupants multiplied by 75 gallons per day) = frequency of pumping: or
- Within 24 hours of indication by tank alarm of lack of capacity (applicable only if system has a functional alarm):
- Whichever is greater

Contractor agrees to provide pumping services according to the regular pumping schedule or as needed to prevent discharge. Homeowner shall compensate Contractor as agreed by the parties for pumping services rendered.

3. **INSPECTION.** Holding tanks will be inspected by a licensed pumper at the time of servicing for leaks below the operating depth and whether tank tops, riser joints, and connections leak through visual evidence of major defects.

4. **REPORTING.** Grievances of Homeowner or Contractor shall be reported to the Aitkin County Environmental Services Department by Homeowner or Contractor. Homeowner and Contractor understand that failure to have holding tank pumped as herein specified or the discharge of any contents from the holding tank, regardless of fault, may result in the suspension, cancellation or revocation of the certificate of compliance, and the homeowner may be required to vacate the premises.

Gobles Sewer - Tim Woodrow
Contractor Ti Woodrow

Joseph J Theis
Homeowner

Date 6/6/16

Date 6-6-2016

PLEASE DO NOT DETACH THESE SHEETS ALL MUST BE RETURNED

APPLICATION FOR VARIANCE FROM REQUIREMENTS OF AITKIN COUNTY ZONING ORDINANCE

APPLICATION NUMBER: 10755V DATE: Aug 8, 83

JOE THEIS 10211 CEDAR LK Rd
NAME OF APPLICANT ADDRESS

MINNE TONKA MINN 55343
CITY, STATE & ZIP

LEGAL DESCRIPTION OF PROPERTY: LOT 3 SEC 27 RANGE 27
LOT 1 SEC 22 TOWNSHIP 46

REQUEST FOR DEVIATION FROM WHAT SECTION OF ORDINANCE: Setback

REASON FOR REQUESTING VARIANCE: Addition + SEWER

Residential Addition will be no
close than existing residence 35' variance

WHAT IS YOUR HARDSHIP SITUATION WHICH DOES NOT ALLOW YOU TO BUILD AT PROPER SETBACK? TOPOGRAPHY

PLEASE NOTE: THIS APPLICATION MUST BE ACCOMPANIED BY A DETAILED SKETCH, THE PERMIT APPLICATION (BOTH THE WHITE AND YELLOW). So that the situation may be evaluated properly, please provide as much supplementary information as is possible. Include maps, information about topography of lot, structures on adjacent lots, and pictures, etc.

Joseph Theis FEE OF \$ 50.00 PD.
SIGNATURE OF APPLICANT

RECEIVED BY: Charlene B...

DO NOT USE SPACE BELOW

DATE, TIME AND PLACE OF HEARING: SEPTEMBER, 7, 1983 at 7:30 P.M. in the
Aitkin County Courthouse, Aitkin, Mn. 55431

VARIANCE (APPROVED) (DENIED) THIS 7th DAY OF September 19 83, WITH THE FOLLOWING REQUIREMENTS: